



REJUVENATING ROSEBURN

Delivering the Roseburn Action Plan

Public Consultation Summary Report
June 2019

Introduction

In 2014, Murrayfield Community Council (MCC) generated the Roseburn Action Plan, calling for various improvements in the Roseburn Area. In 2015, the Council produced plans for the City Centre West to East Cycle Link (CCWEL) project, a cycle route from Roseburn to Leith Walk through the City Centre. 'Rejuvenating Roseburn' has been established to deliver on the principles of both of these plans alongside further community participation to deliver transformational improvements to the Roseburn area.

The City of Edinburgh Council is delivering this project in partnership with Sustrans Scotland and design consultants AECOM.

The objective for this series of consultation events was to gather the local's thoughts on the draft proposal (as shown in Figure 3) and identify any improvements or changes which should be made.

"Effective engagement with the public can lead to better plans, better decisions and more satisfactory outcomes and can help to avoid delays in the planning process"

– Scottish Government (Scottish Planning Policy)

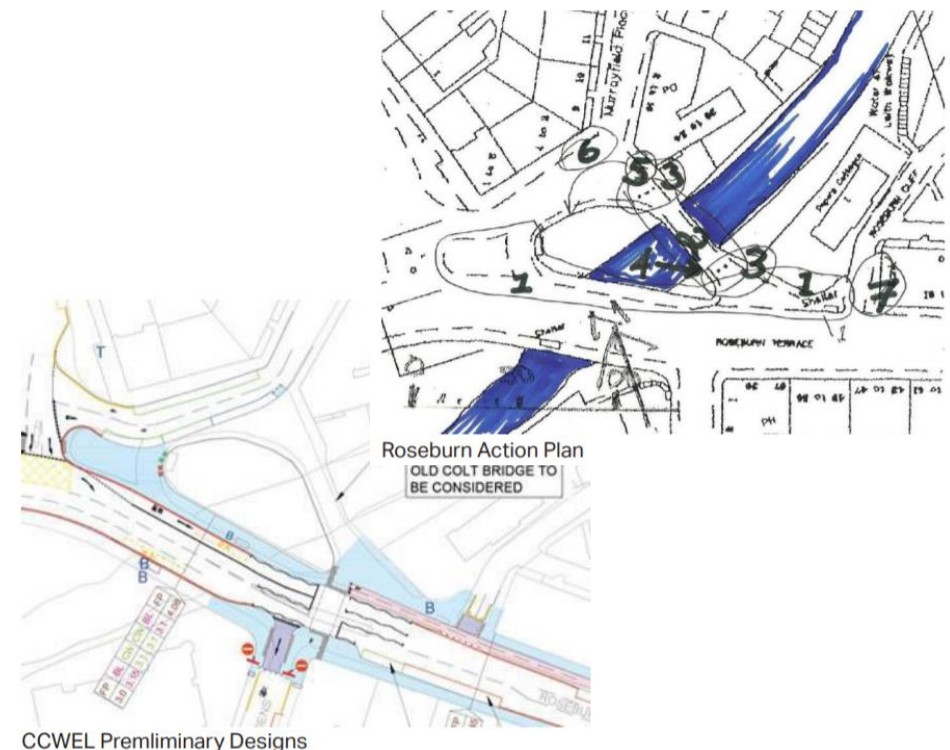

The Proposals

Community Engagement and Design Development

A series of community engagement events were held in 2017 and 2018 to gather ideas to be included in the proposals for Rejuvenating Roseburn:

- 10th October 2017 - At the Murrayfield Community Council, we asked people what they liked and disliked about the space, as well as their ideas for improvement. The feedback was used to create design ideas to improve Roseburn.
- 24th October 2017 – We engaged with young people from Roseburn Primary School, to learn about the common issues they experienced in the space, and to gather their ideas for improvement too.
- 7th November 2017 – We carried out on-site engagement with local people and continued to collect likes/ dislikes and ideas, before putting pen to paper.
- 5th December 2017 – We developed three initial sketch options and asked people which option they preferred.
- 27th February 2018 – Presentation of the draft design to Murrayfield Community Council.

Detailed Design Proposals

The design proposals have been developed around four main themes: Heritage, Nature, Community and Recreation. Each of these contributes to the potential use and enjoyment of the space, to create a better place for people.

- **Heritage** underpins the design, responding to, and enhancing, the local context of the Conservation Area and wider context of Edinburgh.
- **Nature** considers the Water of Leith and its ecology, enhancing the existing greenery to soften the space and screen the road. Design proposals include planters, sensory flowerbeds and tree canopies.



- **Community** awareness encourages the provision of community amenities, such as the new community notice board, cycle parking, and seating to encourage local use.
- **Recreation** incorporates suggestions for flexible space that caters for events throughout the year, such as a farmers market, play interaction with hopscotch insets and the viewing platform

The proposals that went to public consultation are shown in Figures 1, 2 and 3 below.

Figure 1 – Visualisation looking north from Roseburn Terrace



Figure 2 – Visualisation looking east from Murrayfield Avenue



Figure 3 – Design Proposal

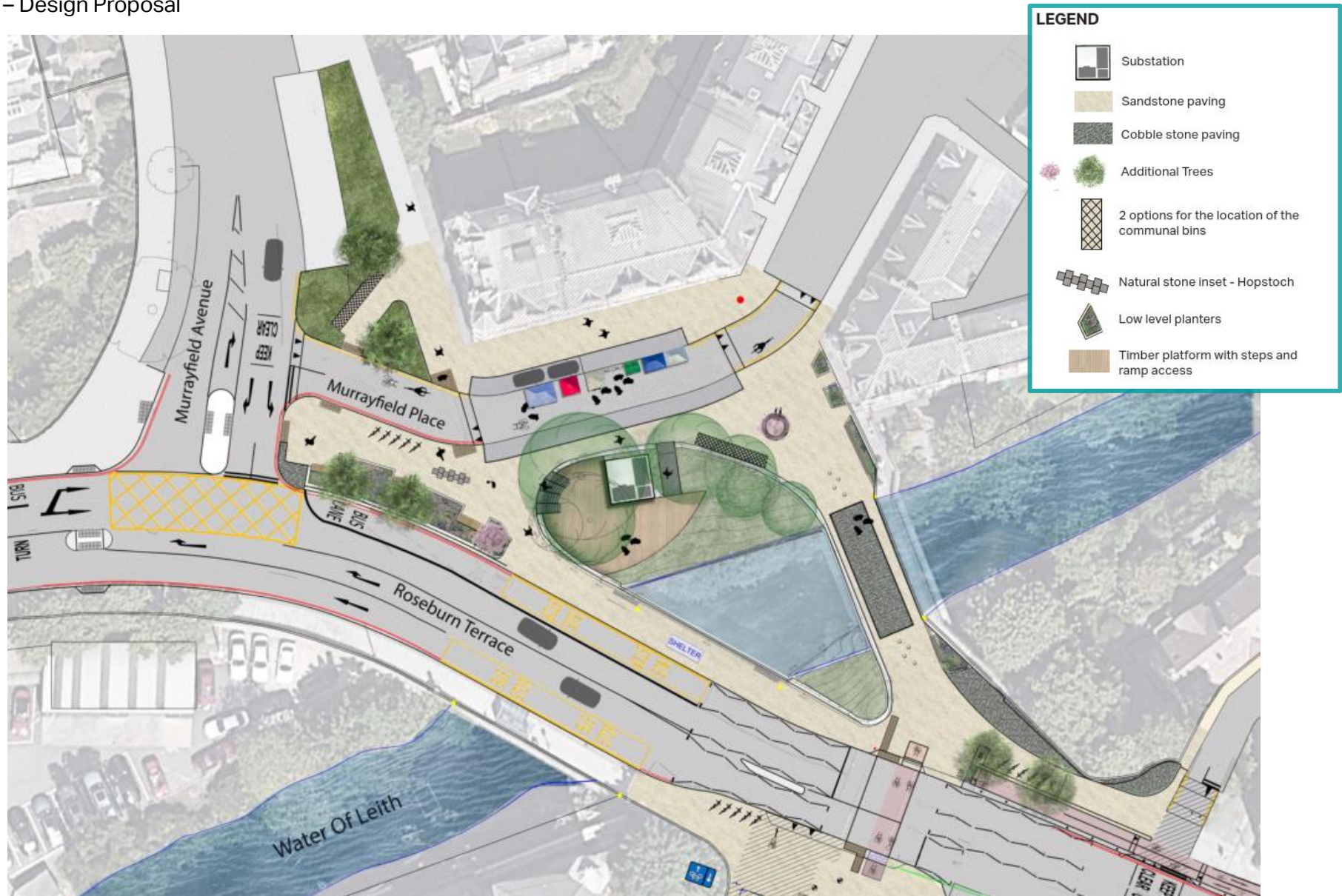

Public Consultation

In order to allow the public to respond to the proposals, as shown above, a questionnaire was developed, reviewed and produced. Over 2000 questionnaires were printed and dropped into homes and businesses in the MCC area. The questionnaire was also available online on City of Edinburgh Council's Community Engagement Hub as the 'Rejuvenating Roseburn Public Consultation'.

A series of consultation events were also held to increase the awareness of the proposals, engage with the community and gather information:

- 2nd April 2019 – Presented Detailed Designs and Launched the Public Consultation at a MCC meeting.
- 2nd and 30th April 2019 – Public Consultation Events were held at the Old Coltbridge, Roseburn.
- 14th May 2019 – The Results of the Consultation were presented to Murrayfield Community Council.

This public consultation ran from the 2nd April until the 7th May; a total of five weeks.

A total 295 responses received of which 219 respondents were residents of the MCC area (74.24%).

For the purpose of this consultation report we have focussed on the responses from within the MCC area and where results are referred to they relate to responses from MCC area residents unless otherwise stated.



Results

Question 1 - In general, to what extent do you support or oppose the proposals shown in the Roseburn Questionnaire document?

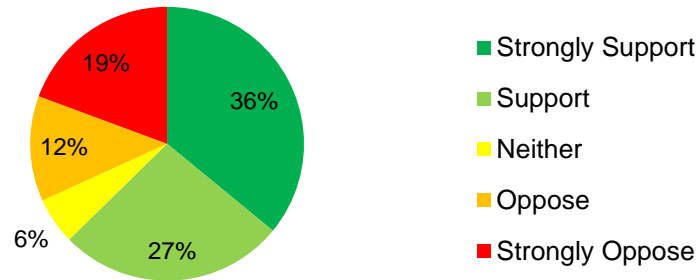

Question 3 - To what extent do you think these proposals enhance the amenity value of the Water of Leith in Roseburn?

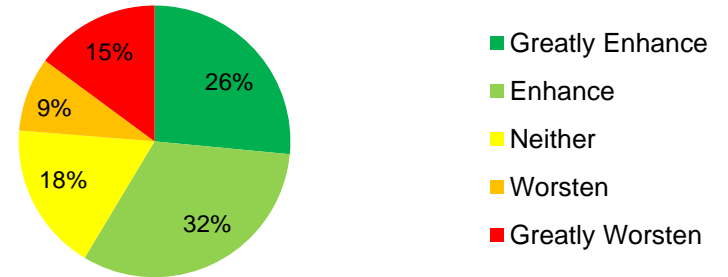

Question 2 - To what extent do you think these proposals will enhance the amenity of the Roseburn area?

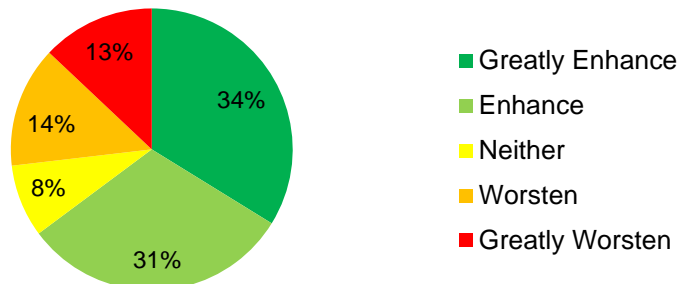

Question 4 - To what extent do you support or oppose the introduction of a Viewing Platform over the Water of Leith as shown in the designs?

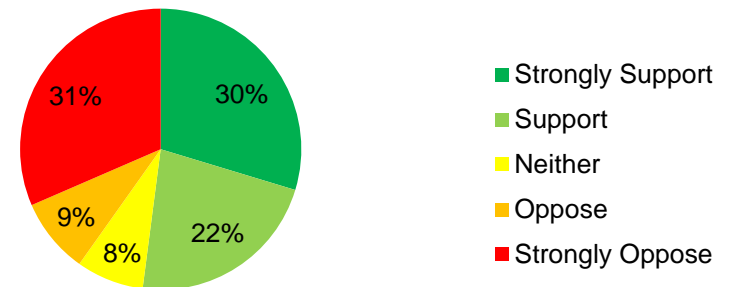

Question 5 - What (if any) is your **favourite** part of these proposals? *(For the full list of comments see Appendix 2)*

We have included the top 10 responses and the frequency with which they have been mentioned.

<i>Top Responses</i>	<i>Number of Mentions</i>
1. New Planting and Landscaping	38
2. New Viewing Platform	27
3. Upgraded Pedestrian and Cycling Provision	21
4. Repaving	20
5. Multi-Use space/ Market Space	17
6. Improvements to the Old Coltbridge	16
7. Moving the Bins	11
8. New Street Furniture	5
9. Removing the Slip Road	5
10. Moving the Bus Stop	5

Question 6 - What (if any) is your **least favourite** part of these proposals? *(For the full list of comments see Appendix 2)*

We have included the top 10 responses and the frequency with which they have been mentioned.

<i>Top Responses</i>	<i>Number of Mentions</i>
1. New Viewing Platform	41
2. Removing the Slip Road	13
3. Loss of Parking	13
4. Too Much Cycling Provision	6
5. No inclusion of a Pedestrian Crossing at Murrayfield Avenue	5
6. The inclusion of Hopscotch Paving	5
7. Moving Bus Stop	4
8. The Cost of the Proposals	4
9. A Possible New Market	4
10. New Cobbles on the Old Coltbridge	3

Question 7 - The preferred location for the communal bins is Option A, on Murrayfield Avenue. However, there is an alternative location, Option B, at the North side of the Bridge. Which of these options do you prefer?

Option A - Communal Bins Location

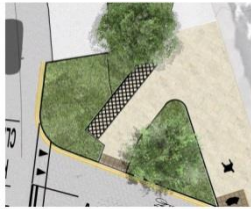

OR

Option B - Communal Bins Location

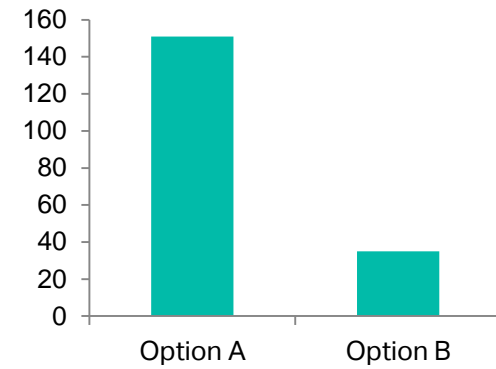
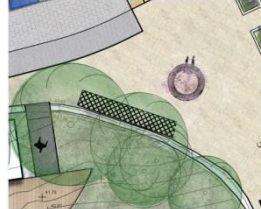

Question 8 - To the north of the Old Coltbridge, we could either plant a tree with public seating, or install an artistic signpost. Which of these options would you prefer?

Option A - Tree with public seating



OR

Option B - Artistic Signpost

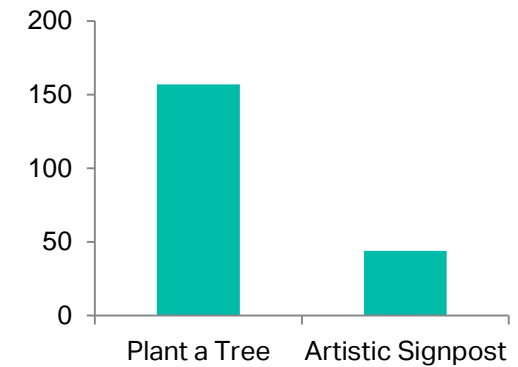

Question 9 - We will be installing a large planter, with seating at the junction of Murrayfield Avenue and Roseburn Terrace. We have two options for this planter, it could have curved, or straight walls. Which do you prefer?

Option A - Rectangular Planter



OR

Option B - Curved Planter

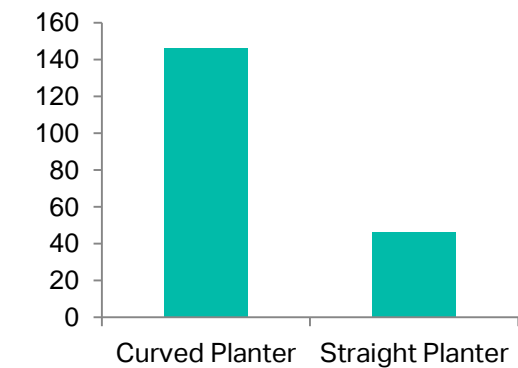

Recurring Comments and Concerns (based on Q.5, Q.6 and Q.11)

(For the full list of comments see Appendix 2)



- The platform should not be the main focus of the proposals; it is important to get the basics right.
- Support the provision of multi-use/ market space.
- The proposals should allow for additional outside coffee shop/ café seating in the area.
- Concern about the future maintenance of the planters and platform.
- Moving the bus stop may cause additional issues for traffic on Murrayfield Avenue and Corstorphine Road.
- The closure of the slip road may cause additional issues for traffic on Murrayfield Avenue and Murrayfield Place.
- People may not use the new seating provided due to the pollution levels on Roseburn Avenue.
- Anti-social behaviour in the area may be amplified by providing an area for people to congregate (at the viewing platform) on match days and during the evenings.
- Litter bins should be provided along with new seating.
- The funds for the proposals could be better used elsewhere.
- No pedestrian crossing at Murrayfield Avenue.



Assessing the Results

Wider Results

We also compared the results from the MCC area with the wider area results in order to understand both the thoughts and opinions of the locals and also those from the wider area who may also use the space.

From the results (based on Q1 and Q2), there is a clear majority support for the overall proposals from all the responses and also those within the MCC area.

Support for the Viewing Platform

The support for the viewing platform (based on Q4) is however more polarising. While there is still an overall majority of support for the viewing platform from both the MCC area and all of the responses, respondents from within the MCC area are more likely to 'Strongly Oppose' the viewing platform proposal.

This finding is reaffirmed in Question 5 and 6, where the viewing platform is most frequently both the favourite and least favourite aspect of the proposals. There is clear polarisation of strong views on the matter.

The results of the consultation were presented to the MCC at a meeting on the 14th of May 2019 where a vote was taken by the community council members on the inclusion of the viewing platform moving forward. The MCC voted nine to four against the inclusion of the viewing platform.

Following the vote, City of Edinburgh Council made the decision to remove the viewing platform from the current proposals.

Q1. Support for Overall Proposals

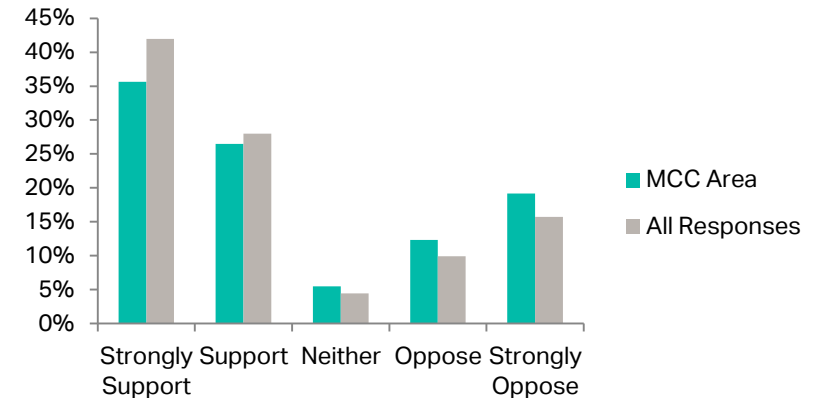

Q4. Support for the Viewing Platform

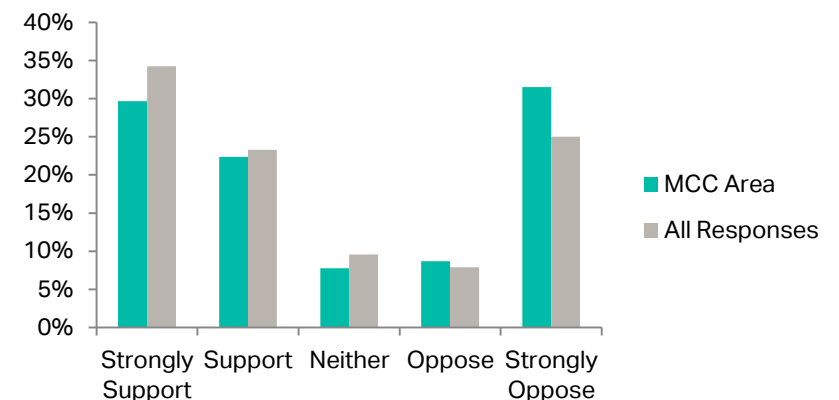

Preferred Proposals

The chosen preferred proposals for Questions 7, 8 and 9 have been selected to be included as part of the proposals moving forward.

Additional Recurring Comments and Concerns

Multi-Use/ Market Space

Upgrades to the pavements and reduction of road space will better allow for various different uses of the space including outdoor seating for a coffee shop/ café or an outdoor market. However, these uses will require an application for a permit/ licence from City of Edinburgh Council (e.g. Market Operator Licence, Tables and Chairs Permit, etc.).

Maintenance of Planters

While the proposed planting and landscaping are a frequent favourite part of the proposals, there are also concerns regarding their maintenance. The planters will be looked after by members of the local community who have volunteered to take part, with support from City of Edinburgh Council's Parks and Greenspaces Services where required."

Moving the Bus Stop

The bus stop is being moved as part of the City Centre West to East Link (CCWEL) cycling and walking project not the Rejuvenating Roseburn proposals.

Closing the Slip Road

The slip road between Murrayfield Place and Roseburn Terrace is being closed as part of the City Centre West to East Link (CCWEL) cycling and walking project not the Rejuvenating Roseburn proposals.

Pollution

At present on Roseburn Terrace pollution levels are within legal limits and due to changes to the signals at either end of the street it is anticipated that the CCWEL project will not have a negative effect on local air quality, and may indeed improve it

No Pedestrian Crossing at Murrayfield Avenue

Due to the removal of the slip road and the inclusion of a larger central island as part of the proposals Murrayfield Avenue will be safer and easier for pedestrians to cross.

Summary of Outcomes

The outcomes of this consultation summary are the result of extensive community engagement and will be used to guide future improvements and works in the Roseburn area. As a result of these consultations the following changes have been made to the Rejuvenating Roseburn proposals:

- The communal bins will be located, at Option A, at the junction of Murrayfield Place and Murrayfield Avenue;
- A bin store will be provided for the communal bins in order to provide additional screening;
- A tree with additional public seating will be provided to the north of the Old Coltbridge;
- A curved planter will be provided at the junction of Murrayfield avenue and Roseburn Terrace;
- The viewing platform has been removed from the design; and,
- The Prunus Laurocerasus (Cherry Laurel) will be removed, to allow greater visibility and accessibility, and native species will be replanted.

Figure 4 – Updated visualisation looking east from Murrayfield Avenue



Figure 5 – Updated visualisation looking south from Murrayfield Place



Figure 6 – Updated visualisation looking north from Roseburn Terrace



For more information or if you have any questions about the proposals, please contact Rurighd McMeddes at rurighd.mcmeddes@edinburgh.gov.uk.

Appendix 1 – Questionnaire

REJUVENATING ROSEBURN

DELIVERING THE ROSEBURN ACTION PLAN



We have been working in partnership with Murrayfield Community Council since 2017 to deliver the aspirations of the Roseburn Action Plan, alongside further community engagement to develop transformational designs for Roseburn. We'd love to hear what you think.

Tell us your thoughts...

1. In general, to what extent do you support or oppose these proposals?

Strongly support Support Neither support nor oppose Oppose Strongly oppose

2. To what extent do you think these proposals will enhance the amenity of the Roseburn area?

Greatly enhance Enhance Neither enhance nor worsen Worsen Greatly worsen

3. To what extent do you think these proposals enhance the amenity value of the Water of Leith in Roseburn?

Greatly enhance Enhance Neither enhance nor worsen Worsen Greatly worsen

4. To what extent do you support or oppose the introduction of a Viewing Platform over the Water of Leith as shown in the designs? Please provide comments below.

Strongly support Support Neither support nor oppose Oppose Strongly oppose

5. What (if any) is your favourite part of these proposals?

6. What (if any) is your least favourite part of these proposals?

7. The preferred location for the Communal bins is Option A, on Murrayfield Place. However there is an alternative location, Option B, at the north side of the Bridge. Which of these options do you prefer?

Option A Option B

8. To the north of the Old Coltbridge, we could either plant a tree with public seating, or install an artistic signpost. Which of these options would you prefer?

Plant a tree Artistic signpost

9. We will be installing a large planter, with seating at the junction of Murrayfield Avenue and Roseburn Terrace. We have two options for this planter, it could have curved, or rectangular walls. Which do you prefer?

Straight walls Curved walls

10. Several local people have already volunteered to be involved in looking after the new planters. Would you be interested in helping to look after these planters, and if so, are you happy for us to pass on your contact details for this purpose?

Yes No

11. Do you have any other comments, or is there anything else that you would like to see in this place?

Please provide your post code:

Business name or

organisation if applicable:

Please provide your email address if you would like to receive results of this consultation:

Please tick here if you would like to be added to our Mailing List to be kept up to date with the CCWEL project.

We are delivering this project in partnership with Sustrans Scotland and design consultants AECOM and any information shared with us will be used to inform the development of this project and may be shared with them. We are relying on the condition of processing in Article 6(1)(e) of GDPR "public task" for collecting and processing this data. At the end of the project all records will be permanently removed, this will take place before the end of 2022. If you wish to be removed from the subscription list or have any of your details removed or amended, then please contact the project Stakeholder Liaison Officer – Rurigh.McMeddes@edinburgh.gov.uk. You can view the Council's General Privacy Policy on our website. You can also contact the Council's Data Protection Officer Kevin Wilbraham – Kevin.Wilbraham@edinburgh.gov.uk or the UK Information Commissioner.

Appendix 2 – Full List of Consultation Comments

Question 4	To what extent do you support or oppose the introduction of a Viewing Platform over the Water of Leith as shown in the designs? - Comments	Page 13
Question 5	What (if any) is your favourite part of these proposals?	Page 21
Question 6	What (if any) is your least favourite part of these proposals?	Page 29
Question 11	Do you have any comments, or is there anything else that you would like to see in this place?	Page 36

Q4.	To what extent do you support or oppose the introduction of a Viewing Platform over the Water of Leith as shown in the designs? - Comments
1	Needs maintaining - council record not good on this e.g.: Drumbrae/ Rose Street/ Playhouse etc. - vandalism - loss of trees.
2	Is good to have outdoor spaces for people to meet and chat. It gives a start point/end point for walking along the Water of Leith down to the Dean Village.
3	This is a pretty triangle adding to the "village green" aspect of Roseburn. It would be great to have somewhere to sit and enjoy it. I understand that no trees will be removed and that wildlife will be minimally disturbed.
4	I am concerned that a platform could attract antisocial behaviour as well as breaching the privacy of wildlife, and suggest that in this 80th anniversary year of the outbreak of the Second World War there might instead be merit in conserving the old gun emplacement that would otherwise have to be demolished so as to make way for the platform.
5	I feel that the money for such a Platform could be utilised better. If you want to view the Water of Leith, just look over the bridge!
6	It will be one of the most polluted "viewing platforms" next to two bus stops and queuing cars due to narrowing of main Road West.
7	<p>Those who have designed the platform appeared to have wished to improve the appearance of the area overhanging the river, however in reality this area will be abused on match and concert days by 'fans' and 'casuals' using this area pre and post events as an outdoor drinking and possibly toileting venue, as the bridge is where people congregate at present and then use side streets as toilets and litter/bottles/cans/ will spread into the river.</p> <p>There is a wonderful park over the road which is open and less hidden so authorities are better able to manage visitors to the area and ensure the area is safe and appreciated by visitors and residents at all times.</p> <p>I also feel the platform area would make the area feel less safe as it is a hidden area which you walk past day and night.</p> <p>The money for the platform could be spent on other amenities in the park, gym equipment.</p>
8	<ol style="list-style-type: none"> 1. Better views of water of Leith from the Bridges or paths alongside river. 2. Platform accessible 24/7 will act as a magnet for antisocial activities, e.g. drug-dealing 3. Tree canopies do not provide shelter in Autumn / Winter
9	I fail to see the need for such a platform, given that there is the path next to Roseburn Terrace which closely follows the river. The platform could potentially be a congregation point for troublemakers.
10	Cost of installation, cost of upkeep, possibility of vandalism, sheltered area for people of "dubious intent" away from initial viewing of public.
11	Good idea and there should be provision for a small pop up coffee bar with seating but priority of use should be for the existing cafes in Roseburn and NO Costa or Starbucks type outlets.
12	My slight concern would be the ongoing maintenance of the new landscaping and the fact that there is a history of unsightly graffiti in the area which is never cleaned up or stopped.
13	It wouldn't be at the top of my list for resource allocation. I am not sure that viewing will be enough of a draw. If there was also a rope swing or rope bridge that could be a big hit with kids.
14	It will require the provision of significant litter bins as it will become a busy gathering spot ahead of football and rugby matches and all that entails
15	Concerns about misuse, especially later in the evening. Is there an ability to lock this overnight? Can this area be used for other event space?
16	The viewing platform at first seems a good addition but what are you viewing?? What should have been included within this project is an extension to the Water of Leith Walkway from Roseburn Park under both bridges to join up at the back of Papes Cottages. Imagine how much safer this would make a stroll along the entire Walkway.
17	This viewing platform will attract unwanted attention and unruly behaviour particularly in the evening and weekends. The residents including myself who live straight across from this area will be negatively impacted.
18	This viewing platform will almost certainly attract unruly behaviour and unwanted attention during summer evenings and weekends. The residents living directly opposite the platform will be negatively impacted.
19	I have lived in Roseburn all my life and whenever I cross the bridge I look over to see what is happening in the river. I do not require a platform for this.
20	The platform will be used by undesirables as a hang out.

Q4.	To what extent do you support or oppose the introduction of a Viewing Platform over the Water of Leith as shown in the designs? - Comments
	Being wooden it will look shoddy within a few years.
21	Good to walk; attract tourists as well.
22	I do support this idea, but feel it is not the most important part of the design.
23	This will disturb the bats in the area and probably turn into a pub overflow area on match days, whilst taming a wild area. There may be an ecological argument against the cherry laurel and other species currently growing there, but replacing it with a grass monoculture as shown would be worse. Moving the bus shelter to the new bridge is also a bad idea, as it will block the pavement. Blocking the existing junction between Murrayfield Place and Roseburn Terrace makes sense, though. Unclear whether the intention is that Murrayfield Place will still be generally open to cars: there are loading bays and parking spaces, but the road is shown with cycle path markings. Needs to be open to cars. I don't understand the patch of "cobble stone paving" shown on the old bridge. I presume you mean setts rather than cobbles, but either way it would be better to have it as smooth paving - better for wheelchairs and the infirm. Also concerned that the physical barriers to stop vehicles using the old bridge are being removed. I think it would be better to retain some of the parking area at the north end of the old bridge, rather than paving it all and adding either a tree or a sign post. Putting a hopscotch area in the middle of a pavement just seems daft, and designed to create conflict between pedestrians and "hopscotchers".
24	I'm not sure about the viewing platform without seeing more detail. That area is fairly dark and bosky under the trees and I think there's a danger that it could just become a damp, dirty area covered with bird droppings and litter. It's also a bit close to the main road to be a nice area to sit out (are there any seats?) and have a coffee or sandwich. On the other hand if it was done well it could be worthwhile.
25	I think it is about those who will be most impacted i.e. living close who may have increased noise etc. It seems quite an expensive solution but I appreciate it could be quite attractive if maintained and not disfigured
26	Worried about pollution I like the hop scotch idea, however, there is a minority of cyclists who treat the old bridge as a racetrack-pedal heads down.
27	Not clear how the location of the electricity substation is being incorporated into the design. A sub-station should not be built on a wooden platform as this would be a fire risk. I assume the old WW2 gun emplacement would be demolished? Viewing Platform could be an area for party goers to congregate before going to a party. This area could be used for underground waste disposal rather than Option A or B.
28	I can't understand how it could benefit existing trees growing through. What about the dark area under the platform. I can't see any great added value. It would not help wildlife, if anything likely to have negative impacts.
29	Don't support in general, but rather than putting a lawn next to river (lawn also non-native) it would be nice to have something more natural. We'd be happy for the cherry laurel to remain, or something more natural than a lawn.
30	Leave it for wildlife. There's a park to sit in. Does not need a place full of petrol fumes.
31	Support in general, but rather than putting a lawn next to river (lawn also isn't native) it would be nice to have something more natural. We'd be happy for the cherry laurel to remain, or something more natural than a lawn.
32	Concern about how it is used and how it will work
33	There are obvious significant issues with respect to wildlife space and wildlife corridor. Timber construction is too short lifespan, and vandals/fire issues.
34	It's a nice idea but the concept of a timber platform under trees is less so because of the maintenance required. I understand 1 year of maintenance would be included but it is not clear who would be responsible thereafter. Similar timber structures under trees at the Botanics are covered in chicken wire to stop them from being a hazard and any non-slip treatment would require regular maintenance. I don't think the view of a bridge wall is worth the expense.
35	The viewing platform is an 'nice to have' but I feel it is more important to get the basics right i.e. pavements that allow all pedestrians to walk without fear of tripping and that have enough space for people to pass and have space for prams and buggies therefore the substance of the proposals is much more important and valid and essential to get right than the 'gloss' of a viewing platform - this has divided the community in a way that is not desirable

Q4.	To what extent do you support or oppose the introduction of a Viewing Platform over the Water of Leith as shown in the designs? - Comments
36	Nice idea, but I think it will just become a graffiti covered eyesore & will not enhance the area at all.
37	Like the idea but think in practice will be dark with shadowing from trees. Could also attract groups 'hanging out' becoming a nuisance. Also expensive.
38	<p>While the platform looks attractive in the design, it would require regular maintenance to keep it clean and free of litter. Overhanging trees would cause the timber to become wet, slippery and potentially dangerous to walk on, especially during leaf fall. Youths would congregate on it and leave cans and other litter, particularly after matches at Murrayfield and Tynecastle. I don't think the expense of a platform could be justified.</p> <p>We already have enough litter and weeds in the Roseburn area which the City Council do not clear on a regular basis.</p>
39	You can already view the Water of Leith from the bridge. The platform is a nice idea but in the wrong place. I don't think people will want to spend time on the platform next to such a busy road with high levels of pollution. I think it may get used as a urinal and by criminals at night.
40	Waste of money in this location. Extremely busy and noisy bottle neck junction which is to be made worse if the road is narrowed as per your proposal.
41	Waste of money from an apparently broke council. It appears that Murrayfield Place is to become cycle only - this will have a massively detrimental impact on local resident access and make the streets more dangerous
42	<p>This viewing platform will, sadly, be a magnet for teenage drinkers and smokers and is highly likely to be yet another source of litter which will end up in the river. It is also unnecessary as there are lovely views of the river from the old Coltbridge. The budget for this complex structure, which will also need ongoing maintenance, would be far better spent on planting high quality street trees and caring for them properly, on installing smart litter bins and emptying them frequently, and on funding regular clean-ups of the river and its banks.</p> <p>Thank you for asking!</p>
43	ST John's Road – Roseburn Terrace 2nd most polluted street in Scotland we are told. No one in their senses would sit on a viewing platform exposing themselves to chemicals.
44	The construction of the decking would inevitably destroy the existing pleasant trees and greenery, and take decades to reach the visual graphic displayed. The lower level deck would sadly be a target for graffiti and rugby boozers.
45	This will make drastic traffic congestion at the Roseburn junction due to the loss of the slip road. Traffic lights would be essential. It is also a waste of money, this is not a tourist destination, it is a working junction and traffic flow is more important than cosmetic appearance.
46	Could go either way. If abused, litter in the area is already a big eyesore/ problem.
47	All it will attract and the usual teens; alcoholics or drug users at night. Don't know what people will see that can't be seen already.
48	<p>1) It will be a magnet for anti-social behaviour. Go down the Water of Leith to the weir just at the bridge that goes up to the art gallery on a weekend. Lots of kids shouting, swearing and drinking. This will bring it nearer.</p> <p>2) I live next to the Water of Leith and have a small patio. Icy and very slippery in winter and when it rains it is also very slippery. Good luck in trying to make it slip proof - nothing I have tried works. That's fine for me as I am used to it - but others won't be.</p>
49	For some time now the Water of Leith walkway has been inaccessible between Sunbury Bridge and Dean Path as well as other points. This does not suggest the council treats this amenity as a priority. The walkway allows us to quickly access a peaceful, green space. Adding a viewing platform at Roseburn would cause considerable disruption to existing flora and fauna for the purpose of allowing people the dubious pleasure of watching the wildlife while the traffic on the main Glasgow road thunders by. Whether or not one agrees with the proposed new cycle route I don't think the viewing platform is the best way of upgrading our neighbourhood.
50	Generally not a good place for people to gather. Right beside a busy main road, bus stop, electricity sub-station. Totally unsuitable with large football crowds. We do not support the removal of the shrub growth and other greenery.
51	The viewing platform is totally unnecessary and will only provide a hangout for youths at night.
52	I don't think the viewing gallery next to the river adds to the amenities. It will be built over a pocket of green vegetation - which adds to the feeling of green oasis - why take it away? the position of the substation makes the decking area unattractive, plus added concern that youths vandalising it - risking injury + causing power cut. Ongoing maintenance would be an issue. Air quality already an issue. Will be worse when the cycle path takes away a lane adding to traffic congestion - why would you want to sit next to the heavy traffic fumes? J

Q4.	To what extent do you support or oppose the introduction of a Viewing Platform over the Water of Leith as shown in the designs? - Comments
53	I am not sure what would be viewed. The Water of Leith can be viewed by walking a short distance in either direction. Is an area next to a substation attractive anyway?
54	<p>Clearing valuable wildlife habitat (birds don't only nest in trees - the undergrowth is equally important for many birds and animals) threatens the integrity of the wildlife corridor along the Water of Leith. This green corridor must be maintained as wild and natural as possible, not tidied and sanitised. Dipper, Otter, Kingfisher, Heron and Goosander are all regular users under both Old and A8 Bridges and their use of the area will be jeopardised by closer proximity to people and the removal of natural cover, which the Viewing Platform will create.</p> <p>The Viewing Platform is highly likely to become an area for anti-social behaviour as already happens on the old bridge and under the old rail bridge just a bit downstream - particularly on Football and Rugby days.</p> <p>The potential for increased litter going into the river is also greatly increased by improving access to the river and encouraging people to sit for lunch etc.</p> <p>Areas from which to view the river are already available in Roseburn Park, less than 200 meters away. Creating seats and a viewing area there would help Friends of Roseburn Park create their vision for the Park and increase footfall and use of that area. Investment for Viewing Areas to the Water of Leith will be more easily and cheaply realised in the Park and will not threaten any existing use by wildlife.</p> <p>We require as much carbon take up as necessary due to the high levels of pollution along the A8 through Roseburn; reducing the undergrowth and creating managed lawn or wood/astroturf will reduce the absorption of harmful particulates from the atmosphere around the area.</p>
55	Only concern is the maintenance of the decking/ platform area. It can get pretty tatty quite quickly so rigorous care and maintenance will be needed.
56	I would prefer the platform to be wider - extending further eastwards.
57	It will be a lovely new public place for people in the community to gather and chat.
58	The Water of Leith is an oasis of nature that runs through our busy city and every opportunity to see and interact with it whilst preserving it should be captured.
59	It looks an excellent feature which will be a real focal point to the area.
60	Fantastic idea will look stunning.
61	This idea looks really exciting and would really benefit the area.
62	Where possible, it will be great to keep the older trees in that section.
63	Brings you closer to nature - and it makes a feature of the river which is really hidden away right now.
64	It would be best if the substation could be directly incorporated into the design, rather than with a fence around which will collect litter and dirt. Perhaps the walls could be used for things like artwork? (Subject to the owner's permission). It would be preferable to extend the arc of the platform to maximise the area and create the maximum amount of usable space, rather than the comparatively narrow secondary (ramp) access currently shown.
65	<p>As a nature lover, the Water of Leith is one of the main reasons I chose to live in Roseburn, and in fact Edinburgh overall.</p> <p>My primary interest in the Rejuvenating Roseburn project was mostly related to the CCWEL (as I'm a cyclist too) until I saw these plans - now I'm just as excited by this viewing platform and surrounding pedestrian-friendly improvements!</p>
66	Great use of space for what is a largely overlooked feature at Roseburn.
67	An ideal addition to the landscape!
68	Small coffee shop would be welcomed.
69	I think the proposals look really good. They will transform an area that offers little in the way of attraction into something that allows people to enjoy the views down the river and the bridges. Fully support it.
70	It will improve the area specially the sandstone paving.

Q4.	To what extent do you support or oppose the introduction of a Viewing Platform over the Water of Leith as shown in the designs? - Comments
71	Great to see farmers market there.
72	It's a good idea if it's kept clean in good repair, and does not become a gathering point for yobboes.
73	I feel it is important to encourage people to engage with the river and this is an important asset to the area. I am concerned about the amount of vegetation which is planned to be cleared and the wildlife habitats which will be lost. This may be low value but with the lack of quality habitats all are crucial. The pictures show a manicured area with no habitat potential. I would prefer a more diverse space which will support more wildlife for people to view
74	What is the cost of this project? When is the proposed implementation and how long will it take to complete?
75	My concern is that this is not the most interesting part of the river so what will the viewing public actually see? I suppose ducks will come if fed by members of the public. The viewing platform will possibly be noisy, right beside the main road and diesel fumes from the buses.
76	Like it - hopefully there will be benches to sit and dustbins for rubbish
77	Support for 2 reasons 1) somewhere for people to sit, 2) somewhere for children to be able to see the river. It seems an expensive way to achieve this & I would be equally happy to see more seating on the old bridge and a way for children to be able to see over the wall to the river.
78	Can't guess whether this will be well-used or not, but it might be fun to try it.
79	I like this idea in general and am very pleased to see that the plans would not require any felling of the trees. I think it'd be great to be able to engage with the water of leith from within Roseburn which we currently cannot really do at all, except peering over the high bridges.
80	A Pleasant addition overlooking the Water of Leith. Wet leaves, etc... to be controlled?
81	The traffic plans for the road will mean that there is permanent queuing traffic so however nice you make the area it will be a pollution trap and not a nice area to be in
82	Pollution at Roseburn is bad enough always queues of cars idling who would choose to sit there, just something for vandals to do
83	The project doesn't bring any obvious benefits to the area. There will be significant disruption while it is under construction, it will result in a loss of greenery in the area posing a threat to local wildlife and ultimately bring little to the area. I do not see the proposal of farmers markets taking off like it is suggested they will - there will be minimal space for stalls so will not draw in custom from other larger, established markets. As a resident of Roseburn Terrace, I see there being significant disruption and inconvenience to my day to day life for a long period while it is under construction. There will be lots of added noise and pollution. The theory that the platform will attract groups of youths seems plausible and that it providing convenience for burglars who supposedly already use the Water of Leith as a getaway is really off-putting. Losing valuable parking spaces in an already competitive area is yet another negative of the project. It ultimately seems like a vanity project for members of the community and committee with the guise that they care about improving the community but have not thought through the implications both short and long term.
84	It will be a hangout for drunks and yobs, be a magnet for youths wanting to spray graffiti on the bridges, and disrupt the local wildlife, especially the bats
85	Great place for drunks to gather on match days, or for youths to congregate at nights. will disturb the bats and makes it too "manicured"
86	The community council are often anti-development under any circumstances and are lead too often by individuals with single agendas. This option is by far the best proposal to date. The cycle route and narrowing of Roseburn at the main retail parade is more contentious as to is the location of where the bus lane starts and finishes which currently is the main issue for congestion and delays. Removing the bus lane from the bus stop heading into the city would simply remove queuing in the current form which are forced to sit behind the right filter lane to Murrayfield stadium.
87	Will there be information boards, e.g. History of Coltbridge, Wildlife etc.?
88	Why destroy a little piece of suburban wilderness to create a focus for anti-social behaviour, disturbance and mess, while at the same time ruining the popular view of the river from the two bridges
89	Although I have been a "senior citizen" for many years, I walk daily along the Water of Leith, the "old Railway"/ Cycle track and Roseburn Park - The plans Enhance this area beautifully.

Q4.	To what extent do you support or oppose the introduction of a Viewing Platform over the Water of Leith as shown in the designs? - Comments
90	<p>I contact you to express my strong disagreement at The City of Edinburgh Council proposal to construct a – ‘viewing platform’ – as part of the ‘Action Plan’.</p> <p>1) Wildlife - the site will have to be cleared which will disturb any existing wildlife in this quiet, secluded, corner of Roseburn.</p> <p>2) Who would benefit?</p> <p>(i) If persons wish to observe the Water of Leith, then, it is but a short walk to Roseburn Park, which affords plenty of areas for viewing.</p> <p>(ii) If I was the owner of a nearby, café or restaurant, I would probably apply for a ‘Table & Chairs’ permit. What a boon, this -‘viewing platform’ - is being built at Council taxpayers’ expense!</p> <p>(iii) Delinquents – this secluded, place would provide a place for youths to ‘hang-out’, with associated anti-social behaviour.</p> <p>3) Vermin, i.e. rats – there are multiple outlets for fast food in the vicinity of the – ‘viewing platform’. If persons take their food to the – ‘viewing platform’ – to eat, then, it is likely that their discarded containers, etc., will attract rats.</p> <p>FYI - rats are already a problem in Roseburn, in fact, my own development made the front page of the ‘Evening News’, last summer. Residents don’t need anything that will increase their numbers.</p>
91	<p>Complete waste of money, creates an area for litter, waste and vandalism to occur, adds an additional area requiring ongoing maintenance (wood will become discoloured and will rot as mainly in the shade of the trees). Pollution levels will be so high, with traffic jams and buses stacked up waiting for a space at the bus stop, (as nothing can move due to the ridiculous cycle route chosen) that no one will want to remain there for long to enjoy any of the added benefits it might bring.</p> <p>Electromagnetic radiation and a constant hum from the HV transformers will put people off using this area.</p>
92	<p>This proposal is an expensive white elephant, costing up to one hundred thousand pounds - a total waste of funds.</p>
93	<p>Unnecessary waste of cash. Who wants to sit next to the A8? The pollution drops down; it will be unpleasant and grimy in no time. It will be an escape route for thieves (when we were burgled, it was how they made their escape). It will ruin a wilderness habitat. It will reduce parking. There are other far better things to spend the £ on, like underground waste storage (as per Grassmarket)</p>
94	<p>I have lived in Roseburn for over 15 years and love this area. This is slowly killing this area; the pollution levels are already high and are going to get worse due to cars idling in the already long tail backs on this road. There are already enough cycle lanes off the main roads around Roseburn making this much safer for people to cycle and keeps the traffic flowing. We do not need a hopscotch and viewing area WE NEED LESS POLLUTION AND YOU MUST SEE WHAT YOUR DOING IS CAUSING MORE POLLUTION.</p>
95	<p>A magnet for antisocial and criminal behaviour. Vandalism, graffiti, littering, drunken behaviour, area used as public toilet. all of this already occurs along river path nearby, this will be no different. who will pay to rectify damage? Damage to old bridge from graffiti will be permanent - cannot clean off due to ecological impact.</p>
96	<p>In addition to being a rugby venue, Murrayfield Stadium plays host to a range of other sporting events and has not yet been finally ruled out as an alternative to Hampden Park. Additionally, the SRU has expanded its use in recent years to hosting concerts, such as that given by the Rolling Stones last year. Tynecastle too attracts large numbers throughout the year. The proposed platform would appear to be a place for people to congregate before and after such events. It is not clear how this would be advantageous to residents, or provide us with the ‘sense of place’ the project suggests we currently lack.</p> <p>You may also wish to consider the issues of maintenance and potential vandalism. It is also the least attractive visual aspect of the proposal and detracts from the charming natural look of the area.</p>
97	<p>Viewing platform will almost certainly attract anti-social behaviour which the local residents will have to deal with.</p>
98	<p>Sorry don't really think there is real demand for this and when the council is so strapped for cash this is definitely not required</p>
99	<p>Adds nothing to the pedestrian environment. Could be a bad place not overlooked or supervised by public.</p>
100	<p>Why have steps to viewing platform when you can have a ramp at both ends</p>
101	<p>The reason I have ticked "neither..." box is not because I am against these ideas. In fact, they look great BUT - you have not allowed for parking. Your design features 3 cars in four of the shops in Murrayfield Place. Have you seen how many are there normally?</p>
102	<p>I wonder about the long term durability of a timber platform especially in a damp and wooded environment. Will require maintenance.</p>
103	<p>Is this scheme a priority for Council spending? How much will it cost and how will it be funded? This is an affluent area. Surely there are more needy areas in the city.</p>
104	<p>Material choice will be important for long term cost. Example not good.</p>

Q4.	To what extent do you support or oppose the introduction of a Viewing Platform over the Water of Leith as shown in the designs? - Comments
105	<p>There will be adequate publicly-accessible new seating and associated car-free paving in the main part of the scheme, so more on the viewing platform would be superfluous from a functional point of view. I don't think it would provide further enhancement to the area as currently proposed. That's not to say that it should not be improved, however.</p> <p>A peripheral seating area, with well-meant but potentially problematic timber decking, is not worthwhile. Going to the expense of building it would also block what I suggest would be the much better option of enhancing this walled-off little area as the setting for a piece of high quality public art. The special qualities of both would add to the character of this more or less natural riverbank, creating another local focal point. Conserving and selectively replanting it would add to the river's wildlife value. It still retains the mature treed character of Syme's 1830's drawing of Coltbridge in the City Collection. Neither the awkwardly placed substation nor the neglected WW2 bomb shelter, which is a rare survivor of its type, work with the deck concept. The bomb shelter should be repaired and not demolished, especially as 2019 marks WW2's 70th anniversary. The deck idea's 'cul-de-sac' layout can't be linked to any feasible Water of Leith walkway extension, and so will also give headaches to whoever has to maintain it: it's not hard to foresee chronic practical and misuse problems, from slippery autumn leaves and accumulating rubbish to vandalism and ad hoc toilet use.</p> <p>So I vote for extending (resurrecting) the Scottish National Galleries' Water of Leith art initiative, but not with another Anthony Gormley in the river please! Many examples everywhere of course, from most prestigious Eleanor Roosevelt Monument in the trees of New York's Riversdale Park and Tinguely's sculpture in Zurich's Tiefenbrunnen Park, to just about anything. Good lighting essential.</p>
106	<p>I feel it is not in the correct place as there is not too much wildlife there. It will get covered in bird poo and graffiti. There is already an issue at the entrance to the water of Leith with drinking at weekends and football matches and I feel this will increase unless it is closed off in the evening.</p>
107	<p>A case of having to be careful what to wish for. Use and benefit relative to high maintenance necessity and impracticality of site below trees in our climate makes this a non-starter.</p>
108	<p>I don't get why you would wish a viewing platform beside such a busy main road.</p>
109	<p>Proposed viewing platform will be a gathering place for noisy groups and litter - really bad idea! Also too shady, no sun.</p>
110	<p>Needs a few benches too!</p>
111	<ol style="list-style-type: none"> 1. Concern over the impact that the change of bus stop location will have on the junction for Murrayfield Ave onto Corstorphine Road. That junction is already congested in mornings, particularly for turning left onto Corstorphine Road. 2. Could a smart traffic light be utilised here? 3. There still needs to be parking on Murrayfield Place. It's important to have short-term parking here for access to shops. 4. Unclear whether Murrayfield Place will still be open for through traffic to Coltbridge Ave. I think it is important that traffic can still access these streets. 5. Reduction of short-term parking here would have a negative impact on local businesses. These plans only work if they enable local businesses to gain more customers and thrive. 6. Increased traffic congestion on W. Coates in front of shops would also have a negative impact on local businesses. Again, these plans need to enhance the prospects of local businesses. 7. My answer to Question 12 Below would be to just Plant a Tree and not have the public seating. There is enough seating on the viewing deck.
112	<p>My concern is the maintenance of a wooden structure under trees- it might become very slippery / dangerous- who is going to maintain it / pay for its safe upkeep?</p>
113	<p>I am concerned it will become a gathering point for disaffected youths and vandalism</p>
114	<p>Concern regarding future maintenance as well as the health and safety aspect of making access to the water easier, plus potential threats to nature and wildlife as a result. It's actually quite a small space and this will clutter the landscape.</p>
115	<p>Having lived in the area for over 28 years I sadly must say that not only do I oppose the track going through Roseburn Terrace and the effect it will have on both pollution caused by tunnelled and slower traffic but I feel that the amenity "improvements" are temporary window dressing to make it look as though there are advantages to us residents of not complaining about the cycle lanes at that point. History of this area has proven that the temporary improved amenity will very quickly become something else to vandalise, be used by those we don't want to use it and more importantly not be maintained by Edinburgh Council once things start to become abused. A walk along the Roseburn corridor will show you what I mean - even the new benches have been spray painted and even the sign about this new platform has been vandalised.</p> <p>This means the "improvement" will soon become unused by residents and an eyesore to locals - but at least you will have a cycle lane!!</p>
116	<p>I can only assume that this is designed to help kill off the elderly population of the area by encouraging them to sit in the traffic fumes of one of Edinburgh's busiest roads. Has thought been given to the activities likely to be taking place beneath the platform? (At the very least, the lack of light will turn it into a dank, unsavoury place.) The platform is unlikely to be much used, and is a utter waste of money, some of which could be spent on, for example, improving the highly dangerous 'steps' leading to the Water off Leith from Roseburn Cliff. Neither steps nor ramp, they are</p>

Q4.	To what extent do you support or oppose the introduction of a Viewing Platform over the Water of Leith as shown in the designs? - Comments
	difficult in summer and extremely hazardous in winter. Can I ask whether the proposal for the platform came from anyone familiar with the area?
117	The viewing platform will be used as a drinking platform by youths and football fans and cause more disruption and vandalism to what was a beautiful quiet residential area. It may also be seen from my garden and spoil my view of the river.
118	<p>the new bridge link will be dominated by cyclists as it will link closely to the 2 way cycle path,</p> <p>A viewing gallery is a space for people to sit late into the evening drinking, drug taking and loitering, and for pre match dumping of rubbish, it is not a nice view or a good space and trying to put an expensive viewing area doesn't transform it to make it a better space.</p> <p>As a woman I wouldn't feel safe there.</p> <p>As a nearby resident we have enough issues with burglaries from access points on the Water of Leith without offering a resting space.</p> <p>I use this area daily by foot.</p>
119	The proposed viewing area will, in my opinion, be the focus for anti-social behaviour throughout the year and I oppose this in the strongest possible manner. There is absolutely no advantage to this for any local resident.
120	No need for a "viewing platform" as folk can "view" the Water of Leith from the bridge and over the wall. As it is, the "view" is usually sullied by rubbish and litter. I am not sure this plan is really "A Transformational Improvements" to Roseburn.
121	I think this would be a wonderful space to meet up and take in the sights. This is a beautiful area that needs a little attention, and I think the proposals would make this a special area.
122	Will draw more attention to the Water of Leith + encourage people to be outside exploring + appreciating it. Will also make the current stretch pavement /road more scenic.
123	We would hope that there would be put in place a maintenance person. Whereby if anything requires future maintenance this would be done automatically and no left to deteriorate further.
124	Need to have litter bins in a prominent place to reduce the threat of rubbish being thrown into the river
125	Careful consideration of materials used for the platform i.e. able to withstand the vagaries of Scottish weather; able to repel paint/graffiti/vandalism. A programme of regular maintenance to be in place to preserve appearance/safety, prevent deterioration, etc...
126	Improve the mess
127	I support the viewing platform but have some concerns about the maintenance and possible misuse of it
128	Roseburn suffers from a lack of a central heart. Football and Rugby crowds come and go whilst the stream of traffic is an anti-social barrier. A viewing platform will not resolve these issues on its own but if delivered as a wider masterplan to create a larger communal space it could be transformatory.
129	It may be a hot-spot for crime as it will be a hidden area form the main road. There are also other improvements that would benefit the local residents more.
130	<p>This survey indicates that I, as a local business owner, should have received a paper copy of the consultation document. This I am still patiently awaiting. It is only through careful monitoring of the development website, the excellent community council and our diligent business owner representative, along with the rather belated email from the Council regarding this consultation, that I have been able to respond as follows:</p> <p>The design of the viewing platform will encourage it to be a haven for antisocial behaviour (e.g. as happens with certain football matches), graffiti etc.</p> <p>The wooden design will be subject to on-going maintenance, causing yet more expense. Algal growth causes a slippery surface which is extremely dangerous.</p>
131	Viewing platform constructed of wood will require maintenance, particularly under trees which distribute sap. Algae growth will make the platform slippery ad dangerous. Its construction enables access to under the platform; an easy hiding place.
132	<p>The proposals are a waste of money. The viewing platform is likely to attract people who may misuse the area e.g. drinking alcohol and possibly use other substances particularly in the evening. It is a dark gloomy hidden area</p> <p>Proposal to use the small corner area as a farmers market or craft stall is ludicrous. This is a main arterial route into the city. The potential for congestion + air pollution, litter and disruption to local traffic is alarming. There is a large Roseburn park nearby which would be appropriate for this type of activity but there has been no demand for this type of use.</p>
133	As the area is not going to be supervised highly likely to be used for graffiti, drinking and possibly worse.

Q4.	To what extent do you support or oppose the introduction of a Viewing Platform over the Water of Leith as shown in the designs? - Comments
	Nb. Recent assaults on nearby cycle track. Increased criminal behaviour.
134	Apart from the unnecessary cost I think the viewing platform will not be as pleasant as the document portrays. Situated under the existing trees it will be quite shaded and gloomy. It will become slippery and marked with the residue from the trees, especially if there is a lime, which is one of the stickier trees. There are many wood pigeons in the area and, from experience one street away, anything under trees is thoroughly bombed with droppings. For such a small stretch of river to view it is a waste of time and money. You can see more of the river from the bridge.
135	I believe that the drawings are misleading and cannot be built as shown; the artist impression shows a number of mature trees which hide the electricity sub-station. If the floodworks in Roseburn Park are anything to go by, I can only assume that the cost of a semi mature tree is prohibitive and I will be long dead before the trees grow to the size indicated. I am also somewhat disturbed at the notion of placing a highly flammable substation on a timber platform within a timber enclosure in close proximity to both mature trees, the Water of Leith and a block of flats. Generally substation enclosures are located away from trees and are in GRP, I believe timber is not permitted. I am not convinced that SEPA will permit a substation in this location due to its close proximity to water way and potential for contamination. Apart from that what a waste of money, really a cash strapped council who keeps putting up our rates to only to spend our money on this nonsense.

Q5.	What (if any) is your favourite part of these proposals?
1	The viewing platform.
2	Cycle route
3	A cycle route which will in time make a more rational access to the City Centre from the West, which at present is piecemeal and convoluted. It should also cut down on car traffic which is the chief detriment to Roseburn Village.
4	Repaving and new street furniture, including heritage lighting
5	Rejuvenation of the bridge. Some of the planting.
6	The improvements in this 'rejuvenating-roseburn' are: the new paving on the bridge extended to the road and in front of Coltbridge Avenue, moving the recycle and waste bins (presently an eye sore and odour for residents) to one location at the end of Murrayfield Avenue, if this includes the two bins on Murrayfield Place this would return 2 parking spaces. The planters and general landscaping of the area are positive to the area
7	Artistic Signpost
8	I am in favour of the policy of improving conditions for cyclists.
9	Use of quality stone
10	Viewing platform, opening up of the area- should also consider tree removal where appropriate and the connection to the bridges heritage.
11	The greening of a terraced area.
12	The viewing platform + possibility of a market/event.
13	Space for events - craft/farmer's market.
14	More functional use of space and improved accessibility.
15	All would enhance the area.

Q5.	What (if any) is your favourite part of these proposals?
16	Potential for market, green area, secluded bin space
17	The viewing platform is a brilliant idea - IF it is not abused!
18	Redevelopment of junction off Murrayfield avenue.
19	New paving.
20	Move to a less car dominated environment
21	The idea of a farmers' market and space for this.
22	closing off one of the exits to the main road and creating space for the community
23	The huge improvement to areas of hard standing and potential multi use space.
24	There is so much wrong I can't think of any part that is good, sure the whole area will look all new and nice but it will restrict the movements of more people than it will enhance
25	Improved payments.
26	Improved pavements
27	Nothing
28	Market Idea and Viewing Platform
29	Connection with nature, water of Leith, more friendly to walk and to cycle.
30	The improvements to the road junction.
31	The planter at the closed junction.
32	Adding vegetation
33	Pedestrianisation possibilities.
34	Segregated cycle lanes
35	Better use of tarmac areas and adding visual and bio diversity
36	Reinvigorating of the Old Coltbridge. Reuse of cobbled setts on the bridge. Additional planters New paving
37	The planters and planting a cherry tree. The space for outdoor market.
38	Relocation of bus stop and removal of former car access from Murrayfield Place to Roseburn Terrace.
39	None or maybe moving the bus stop?

Q5.	What (if any) is your favourite part of these proposals?
40	Better cycling provision
41	Relocation of bus stop and removal of former car access from Murrayfield Place to Roseburn Terrace
42	Enhancement of the environment
43	Renovating the Old Colt Bridge, which is where this project started. I like the horseshoes theme to recognise turnpike road history - this theme could be extended along Murrayfield Place paving.
44	The planting, cobbles and paving.
45	More planters and trees to absorb CO2 in very polluted main road.
46	new pavements
47	New planters, trees, relocation of communal bins
48	Moving bus stop from main Roseburn area
49	Raised beds and planters. But shrubs which can tolerate fumes from the A8.
50	None - why develop on of the most polluted streets in Edinburgh
51	More trees, planters, public seating, bike stands and moving the bins to a more discrete location.
52	None
53	The cycle lane and the replacement of the existing shabby pavement surfaces.
54	The relocation of the eastbound bus stop to the other part of the road.
55	Extra pavement
56	Nothing. The question below about trees and signposting is such nonsense. I am forced to accept one but this is meaningless. You should ignore all of my answers below about trees , bins, planters etc.
57	More seating facing the sun on North Side of Roseburn Bridge
58	none
59	Moving of the bins as long as they are shielded from residents on Murrayfield Avenue
60	Moving of the bins as long as they are shielded from residents on Murrayfield Ave
61	Sandstone paving & additional shrubs and trees
62	Raised planters, improved sandstone paving, tree with public seating, bins moved to corner of Murrayfield Avenue. (A)
63	Making area more friendly for pedestrians.
64	Restoring the cobbles on the old bridge.

Q5.	What (if any) is your favourite part of these proposals?
65	Platform and More Trees
66	There is currently a lot of wasted space around this road junction and the proposals seek to use this in an attractive and worthwhile way. I like the increased greenery and the viewing platform to make the most of having the beautiful river right in the middle of the community.
67	The viewing platform
68	Viewing area and space for farmers market etc.
69	The platform.
70	The overall aesthetic appearance
71	That walking and cycling are being made easier, more pleasant and safe in the currently extremely polluted and car congested local area
72	The increased cycle routes.
73	The focus on pedestrians and cyclists.
74	The decking/platform and green area.
75	The decking will look fantastic.
76	Proper segregated CYCLE provision and the change of street usage particularly on Roseburn Place/Gardens. The Nitrogen Dioxide levels are stupendously bad.
77	The viewing platform
78	Viewing platform.
79	Possibility of Sunday market
80	It's the overall enhancement of the area - making a feature of the river and making Murrayfield Place somewhere special that Roseburn can be proud of. It is fundamentally bursting with charm, yet at the moment it feels like a car park and bin loading bay. Thank you for helping make this an even better place to live.
81	Everything! A great initiative with lots of good ideas - don't listen to the haters!
82	The viewing platform and improvements to communal recycling bins.
83	The bike route! I commute to George Street from Roseburn and the most terrifying part of the route is the one along Roseburn Crescent and Wester Coates (A8). I'm also very excited for the viewing platform, as we use our balcony onto the Water of Leith to birdspot and would love to see more people able to do it :)
84	These are very well thought out proposals which will greatly enhance visual impact of the area.
85	Generally more attractive spaces
86	Viewing platform/Farmers Market
87	The platform is a great idea and the way it will be built around the existing trees is very good.
88	Viewing platform on water of Leith
89	The sandstone paving

Q5.	What (if any) is your favourite part of these proposals?
90	Investment in the community for all.
91	Viewing Platform
92	New trees and plants.
93	Increase in amount of greenery and trees
94	Simplification of junction between Murrayfield Avenue and Roseburn Terrace
95	The planters beside the main road and the suggestion that there is space for a market / stalls occasionally.
96	Planters and trees
97	Safer cycle routes
98	More greenery than at present. The space is less car dominated.
99	Improved communal spaces. Easier routes for pedestrians.
100	I like the idea for space for a street market that could bring a really friendly and much-needed community vibe to the area. It could also hopefully be used for community events from time to time. I also really like the additional planters that are being proposed, particularly the large one next to the main road. I have actually suggested we try to get raised beds in Roseburn park to replace the old park but haven't had time to progress that idea with friends of Roseburn park, anyway, that's an aside but I'm in support of more growing spaces across the city.
101	Features like hopscotch, horseshoes, etc...
102	Potential Street Market in Future
103	I like the idea of viewing platform + seating and paved area with features for e.g. market.
104	Making more of the old bridge
105	Nothing, spend money sorting the potholes in roads not a place to watch traffic go by
106	none
107	None
108	None
109	Location of decking at pavement seating on kerb side would be pointless.
110	Viewing Platform
111	Viewing platform
112	The green space.
113	Opening up disused space for public use.
114	Moving the bins

Q5.	What (if any) is your favourite part of these proposals?
115	The area immediately at food of Murrayfield Avenue.
116	Absolutely None. The whole scheme centred around a poorly chosen cycle route, is a complete waste public of money. Like the metal benches along the cycle path (Roseburn to crew toll) than no one ever used and are already being vandalised. Spend the money on repairing the roads and removing the ongoing current daily danger to cyclists who are put at risk by huge pot holes. All surveys to date and consultation process have been rigged by getting votes and approval from people who are not locals within EH12 5** postcode who will be most negatively affected by these proposals.
117	none
118	none
119	None whatsoever
120	None
121	Cobbling the road + adding a planter + old-fashioned lighting
122	NONE OFF IT.
123	None
124	Cobbling the bridge.
125	Improved pavements
126	Sorry don't think any of it is a good use of money
127	A cycle for old bridge.
128	Will not improve a lovely peaceful corner of Roseburn
129	The increase in trees.
130	The viewing platform
131	More trees.
132	none
133	I think it looks really nice and creates a community hub
134	Pedestrian area on Old Coltbridge.
135	Streetscape
136	The fact that it makes the area cohesive
137	None as it is not a true representation of the current road
138	None

Q5.	What (if any) is your favourite part of these proposals?
139	Repaving old bridge, but the detailed treatment needs to be reconsidered - it's an important historic structure and more sympathetic layout & materials, including lighting are required.
140	Moving the bus stop closer to the junction of Murrayfield ave from Roseburn cliff. I live on Roseburn cliff and currently we cannot see past the bus stop to see oncoming traffic. Replacing it with 2 trees will not make that any easier though! People also stand in our road while waiting for the bus. Moving the bus stop will also make flow of traffic better as cars are often queued past the buses, if turning right at the lights so prevents traffic going straight on moving freely.
141	Proposals at under used space at Murrayfield Avenue/ Murrayfield Place/ Roseburn Terrace
142	The bins potentially being moved to the corner of Murrayfield Place & Murrayfield Avenue. Cobble stones featuring on the old bridge and I think it would be lovely to have all of the old bridge in cobble stones. Having a planter on what is currently the blob of tarmac at the Murrayfield Avenue - Murrayfield Place junction.
143	Treatment of the Old Bridge
144	The trees instead of a bus stop at the crossing
145	I really like the little details like the hopscotch paving and the horseshoes. I also think the viewing platform will be a great asset.
146	Abundance of greenery and use of natural materials in keeping with the area e.g. cobble stone and sandstone.
147	The viewing deck onto the Water of Leith is a nice idea, particularly for elderly residents as it would allow them a place to stop and enjoy the water. Would it have an access ramp included?
148	The upgrade of Old Coltbridge
149	planters at corner of Murrayfield Avenue & Murrayfield Place
150	It isn't the actual proposals but that fact that they are wide open to be quickly abused and not maintained so becoming a further eyesore. With the projected poorer air quality, I am not sure I would want to hang about in that area anyway!
151	Cobble Stone Paving
152	Planters are good. Hardly a major infrastructure project, though. I like the cobblestones, but would like to see them extended, as a genuine attempt to reflect heritage, rather than 'framed' as a kind of absurd novelty.
153	None
154	The resetting of the cobbles on the bridge.
155	Really I think the whole scheme is flawed. The space is perfectly good as it is apart from rubbish and poorly cleaned buildings. I see any grass areas quickly turning to mud with usual footfall of people. Some nice Tubs would be sufficient, This is not going to become a destination for weekend markets, it's not a destination area and with relentless buses going through it no one would choose to sit there. What is needed is underground bins here and across the city
156	Very little - possibly the enhancement to the old bridge.
157	Cleaning (pressure washing) the pavement. Maybe flower planters. Perhaps a tree or two. Seating. (But no mention of waste bins/cigarette butt disposal)
158	Provision for local market
159	More greenery and more pedestrianised space.

Q5.	What (if any) is your favourite part of these proposals?
160	The viewing platform.
161	Newly paved areas and planters
162	Potential use of the space for farmer's market/other gatherings/sense of space.
163	New greenery, viewing platform and the use of mixed stone paving
164	The road will be safer for pedestrians to cross
165	New road layout with potential for temporary events e.g. farmers market
166	Approve if everything - excellent design.
167	My favorite part of the proposals is the improvement of the street surfacing and the introduction of more planters.
	This is a busy pedestrian area and improving the street surfacing is a great thing. Encouraging access and promoting use of the Water of Leith Path (which some people can find confusing to join in Roseburn) is also a very welcome.
168	The new public area on Murrayfield Place
169	Enhancing the old Colt Bridge as a potential public space
170	Relocation of the bins
171	The trees and green space and the possibility of a farmers market.
172	Creating a large, traffic free, communal space in Roseburn.
173	None.
174	Plants and greenery - which may help aesthetically, only if consistently maintained.
	I would much rather that funds were spent keeping the area well-presented than on viewing platforms, fixing broken paving slabs (trip hazards) along Roseburn Terrace and clearing the awful graffiti at the end of the tenement block on the side of the building above Vigo café - What an eyesore and degradation of this conservation area!
175	Introduction of planters and greenery - but ONLY if this is maintained by Council as part of wider improvements to the area. Planters are great but only if they are maintained - the existing planters on Old Coltbridge are a case in point - great idea but suffer through lack of maintenance. Having volunteers may work initially but this is not a long-term solution. These should be part of the wider council maintenance programme - using money released from scrapping ill-thought out schemes such as the platform. I fear that, as is the case near the Chinese Embassy/Roseburn Park entrance, that new trees planted were removed for flood works and never replaced, those that remained were not maintained and thus have suffered. Maintenance is essential.
176	Closing of small junction traffic lane from Murrayfield Place into Roseburn Terrace at bridge.
	Planters
177	Tree
178	I am not in agreement with any of it.
179	The large planter on the area which is currently a large pavement area

Q6.	What (if any) is your least favourite part of these proposals?
1	Platform
2	The ignorant and hostile reaction to them from some of the locals.
3	the viewing platform
4	<p>The Viewing platform is not necessary. By cutting off the slip road from Roseburn on to the main road going into town you will create even further traffic build up on Murrayfield Avenue as the traffic from Murrayfield Place cannot filter around but will have to join Murrayfield Avenue</p> <p>The is little parking available as it is in Murrayfield Place for the local shops and the residents. This plan shows parking but is it the same amount as it should not be reduced and in fact you should be looking to find ways to increase a space or two from the plans instead.</p>
5	The amenity of Roseburn "village" will be wrecked - cyclists taking over park.
6	<p>Platform most negative aspect No requirement for a seating area at the bridge (same reason for no platform) A sign post if essential</p>
7	Viewing Platform
8	The lack of acknowledgement of the impact of these proposals to the residents and businesses of Roseburn Terrace.
9	Reduction of traffic lanes. I am not a car driver but flow of traffic will be a problem at busy times. Introduction of cycle path.
10	The substation.
11	None
12	Roseburn Park walkways are dreadful for old people and wheelchairs along with the Roseburn Terrace cycle ways proposals and shops access should be considered ALONG WITH this Roseburn renovation not as three separate schemes.
13	Loss of car parking spaces.
14	None
15	Will the parking be taken away?
16	<p>The total misunderstanding of how present traffic flow in and around these streets. It is not clear from any of the images or corresponding paragraphs whether cars will still be able to use Murrayfield Place, I am assuming they will, so with the loss of the left turn slip road out to Roseburn Terrace this will create a huge problem, most especially when St Georges School pupils are arriving and departing for the day.</p> <p>Along with these proposals should have been one for Coltbridge Terrace to be ONE WAY, going UP ONLY. Another addition should be an additional yellow box junction on the westbound carriageway as this is an absolute nightmare to get out from at rush hours, with the present setup, never mind the new one.</p> <p>I have no problem in a council trying to find safer routes for pedestrians and cyclists but right now and for a very long time into the future, people DO and WILL continue to drive cars, whether they be old school fossil fuelled or electric and it is high time that all stakeholders in this endeavour take this into consideration</p> <p>The designers of this project must think that you can just block off a road here and there with no knock on effect on some other part of the area and it's inhabitants.</p>
17	Viewing platform
18	Viewing platform

Q6.	What (if any) is your least favourite part of these proposals?
19	The viewing platform
20	Reduced parking available (this is a big issue within the area due to 'park and ride' into the city. Closed slip roads Viewing platform
21	It doesn't seem to do anything to reduce traffic / pollution
22	Strong opposition of aggressive people with cars
23	The viewing platform and associated "tidy up" of the vegetation in the area, and the new position of the bus stop.
24	The need for a viewing platform
25	Decking.
26	Cobbles on old Colt Bridge
27	Urbanisation of the Water of Leith banks- we enjoy the more natural space - but it could enhance Roseburn if well done with good materials
28	Closing of Murrayfield Place SNR Road.
29	Loss of parking in Murrayfield Place Not convinced that the viewing platform is a satisfactory solution
30	The platform & celebrating a Jacobite win.
31	I worry about implementation stage, installation of poor soil and grass and trees in Roseburn Park flood works is a shambles.
32	Most and no mention of bin problem
33	I worry about implementation stage, installation of poor soil & grass & trees in Roseburn Park flood works is a shambles.
34	The cycle path on Roseburn Terrace
35	The artistic signpost to North of Old Colt Bridge - this is not required, and such design out of keeping with the classic bridge. (Sustrans signpost designs on cycle-tracks do not succeed in being legible or meaningful information).
36	The loss a parking/turning space.
37	They will not reduce the high volume of traffic on Roseburn Terrace.
38	cyclists on the Old Coltbridge
39	The removal of the slip road between Murrayfield Place & Roseburn Terrace - The 'back-up' of traffic onto Murrayfield Place will be significant, and the removal of parking. The local businesses in Roseburn need as much opportunity for people to visit their shops as possible. And as parking comes further out of the city, the harder it is for local residents & my clients to find available parking.
40	Timber platform. I like the look of it, but it's not practical.
41	None - why not develop the lovely area around the new playground in Murrayfield Park

Q6.	What (if any) is your least favourite part of these proposals?
42	Loss of parking spaces which I think will be detrimental to the shops at Roseburn.
43	Road narrowing. Yet more money spent on cycle paths to the detriment of public transport users. Most Edinburgh cyclists don't use the existing cycle paths. This project should not be a priority for public spending
44	All
45	The "viewing platform".
46	The viewing platform – youth and drinkers will gather and then throw rubbish into the Water of Leith.
47	Platform
48	the closure of the slip road
49	The Platform: Leave the wildlife in peace!
50	The loss of decent access for those in Bollbridge and loss of slip road from there.
51	<p>Closing the small slip road that allows you to drive from Murrayfield Place onto Roseburn Terrace. This is vital. It allows traffic to move more freely at what is a very congested junction - especially at peak hours.</p> <p>If you were to go ahead with closing the road - why not install automatic bollards. At peak hours the bollards are down allowing traffic to use this slip road. At weekends the bollards are up thus allowing it to be fully utilised by pedestrians.</p>
52	The viewing platform & lack of parking for residents & local shops.
53	The viewing platform over the Water of Leith
54	Covering over river bank with viewing platform. Option for outdoor market (added noise + litter for residents).
55	Bus stops being opposite each other.
56	Viewing platform and sanitisation of the area by the Water of Leith.
57	Any shared space with cyclists and pedestrians- as a pedestrian I am regularly left feeling vulnerable and anxious by cyclists who speed and cycle in a way not appropriate for shared space. And please take cyclists off the footpaths (for example on Russell Road).
58	Am concerned about the lack of a keep clear junction at Murrayfield avenue - which may effectively block the only vehicular exit from Coltbridge Avenue. Lack of a zebra crossing on Murrayfield Avenue.
59	Not convinced by cycle lane/ road arrangement on Roseburn Terrace. Predict worse queues and pollution.
60	The time it will take from inception to delivery
61	None
62	The changes for cyclists, I hope they do not ruin Roseburn Terrace.
63	The insular and disagreeable stance of the Murrayfield Community (AYE RIGHT THEN) Council, who prefer fear and lies over balanced facts, scaremongering over inclusivity, and most of those old farts will be dead by the time any benefits are realised, Their disgusting self-righteous attitude to illegal parking in Roseburn Terrace for example, told me everything I need to know about this group of chumps.

Q6.	What (if any) is your least favourite part of these proposals?
64	N/A
65	<p>My least favourite part is a lack of a safe pedestrian crossing at the Murrayfield Avenue junction. This is a great opportunity to put in something that is sorely lacking. A lack of signalisation of the Murrayfield Avenue junction as right hand exits is exceptionally difficult.</p> <p>A) In terms of the pedestrian aspect, I really have my heart in my mouth as I cross the Murrayfield Junction at rush hour on a Wednesday with my daughter to Rainbows. I am genuinely shocked a junction of this scale has no safety in place for pedestrians and I strongly recommend you put a safe crossing point in place. It would be a sorely missed opportunity otherwise.</p> <p>B) Unfortunately traffic exiting Roseburn Gardens and turning left onto Corstorphine Road makes a right hand turn exit from Murrayfield Avenue onto Corstorphine Road really hard - please try to observe this at rush hour. You might think that when the pedestrian crossing lights are at red going westwards, and with the benefit of the yellow boxes you would be able to exit from Murrayfield Avenue and make a right turn, but the steady stream of traffic from Roseburn Gardens means you never get a break to get out. Please can I recommend that the Murrayfield Avenue junction be signalised, especially as there will be the additional burden of cars turning left which would previously have used the slip road which will be closed.</p>
66	<p>It could go further in minimising the effects of traffic; close the Murrayfield Avenue/Murrayfield Place junction, or make it one way (probably more realistic!); there NEEDS to be a safe road crossing point at the junction of Murrayfield Ave and Roseburn Tce; close the junction between Roseburn Gardens and Roseburn Tce (or at least install a traffic control as traffic turning left from there stops traffic getting out right from Murrayfield Avenue onto Roseburn Tce when there would otherwise be a break in the westbound traffic due to pedestrian crossing). I am a driver myself, but also a parent and the safety of pedestrians needs to be prioritised.</p>
67	<p>Confusion around exactly what the cycle route will be - this latest Roseburn Questionnaire is stunning and seems really attractive to pedestrians but doesn't seem to mention the cycle path at all?</p> <p>I'd originally thought (from earlier plans?) there was going to be a proper cycle route all the way along the main road from Roseburn into the city center, which I was very excited about as currently commuting in is pretty scary along the main road.</p> <p>Apologies if I've missed something obvious here and this document is supposed to have a different focus. Just wanted to flag in case it's now become a lesser focus!</p>
68	Beudr location (on Maria Rd not pedestrian bridge)
69	It would be good if the walk way over the river would also include markings for the cycle path.
70	Ground lights - not very pedestrian / cycle friendly & we should minimize light pollution (lights facing upwards).
71	I like the idea's bains proposal.
72	Need to ensure platform does stay as a safe area
73	Not keen on cobbled areas on the old bridge. As smooth surfaces are more comfortable to both walk and cycle on, the cobbles will lead these two groups to compete for the smoother areas. Better to have it all smooth and with a marked route for bikes leading from CCWEL over the bridge.
74	<p>I am concerned about traffic congestion leading to increased pollution</p> <p>I fully support better cycle links however I feel it would be best to improve links to the existing cycle track to Haymarket and the Granton path</p>
75	Sharing space with cyclists going too quickly. Please could there be signs to make sure cyclists slow down.
76	No pedestrian crossing at bottom of Murrayfield Avenue
77	<p>I am very concerned about the lack of car parking spaces. The changes to create the cycle lane already mean that there will be a withdrawal of space when a car is required, eg an emergency visit to the chemist, picking up pictures from art framers, picking up cakes from the 3D shop, taking our aged mother in law to the hairdressers, let alone shopping at one of the mini supermarkets.. The short term parking beside the bridge is therefore even more useful. Where can any cars park in the vicinity to allow a quick visit to the shops?</p> <p>PS why can't we have a tree and an artistic sign post? The more trees the better (climate change, blossom). The signs on the Water of Leith are fun,</p>
78	The hopscotch

Q6.	What (if any) is your least favourite part of these proposals?
79	The space does not incorporate many of the ideas from Roseburn Primary - having consulted the children; it would have been nice to see a few more 'fun' things incorporated.
80	Cycle routes not as clearly marked as they could be. Murray field Avenue will still be intimidating for pedestrians to cross - can't we have lights here?
81	No particular concerns, I think it's been well thought out and will be a vast improvement on what's here at present. The only thing I dislike from the process is the dreadful opposition leaflet we received through the door from the usual scare-mongering losers. Thankfully their negativity reminded me that I should respond to show my support for these improvements!
82	Communal bins.
83	Farmer's Market + Cyclists coming through this area.
84	Blocking off the little side road onto the main road
85	Total unnecessary proposal do something about pollution
86	Waste of council money on an unnecessary project that will bring little benefit to the community while there are so many other valuable causes. Also, the disruption to day to day life while under construction for no long term gain
87	The platform
88	The viewing platform, and the cobbled patch on the bridge
89	Seating on kerb side.
90	Bins on Murrayfield Avenue
91	none
92	The location of Option A for the communal bins. The bins are to serve Murrayfield Place so locating them on Murrayfield Avenue makes no sense.
93	Viewing platform; street market
94	Having the two Bus stops directly opposite each other.
95	The road going to one lane in each direction.
96	Increased Pollution Traffic jams Increased vandalism and littering Bringing the west end of Edinburgh to a standstill The proposed poorly chosen new route for NCR1 cycle way.
97	The removal of the slipway at Murrayfield Place
98	none
99	The whole scheme is a total waste of financial & other resources
100	Everything
101	All the rest

Q6.	What (if any) is your least favourite part of these proposals?
102	Viewing Platform
103	The wooden viewing platform.
104	The viewing platform
105	Making changes
106	Sticking a tree in a space that is part of the Old Bridge.
107	It will attract vandals and spoil the Riverside
108	The hopscotch
109	The lack of attention/belief in the traffic levels on Murrayfield avenue and the parking in Murrayfield Place.
110	Too higher priority to bicycles and riders.
111	Viewing Platform
112	I have serious concerns about the further restriction on parking. As a business it is really hard to park and the loss of more spaces is a real concern.
113	Risk of collateral increase traffic surrounding.
114	Platform
115	Timber for platform is not a good idea
116	All, why spend tax payers money on something that is not essential
117	All of it
118	Deck.
119	Removing parking from Coltbridge Ave and closing the road at Roseburn gardens.
120	Viewing Platform
121	The viewing platform, as I don't get why you would wish a viewing platform beside such a busy main road. Am concerned about the loss of the two slip roads that we currently have either side of the Murrayfield Avenue - Roseburn Terrace T-junction, as they currently help with congestion. Very worried about the loss of parking as Roseburn businesses thrive on people "just stopping by". The parking at the bridge is very handy and a reduction in it would impact businesses.
122	Viewing Platform
123	The viewing platform and street market
124	Clearer signs for shared use and a clue how the Roseburn cycle project will integrate. I want to be able to cycle into town with my young son in a few years without having to first deal with a scary bus lane (can you also reassure us that the planters just before the bridge won't be a hazard to cyclists, either by overhanging vegetation or by being a hard boundary right beside the gutter?)
125	None

Q6.	What (if any) is your least favourite part of these proposals?
126	<p>I like the current Colt Bridge. I don't care for the proposed new sandstone.</p> <p>I like the idea of paying homage to the old Coltbridge with the horseshoes, but don't care for the proposed execution. I think better, more unique concepts could be developed to make the bridge more of a local landmark.</p> <p>I personally would prefer the current bridge is restored.</p>
127	<p>Big concern re position / size of bus shelter.</p> <p>The current one is inadequate - collects pools of water/ does not protect people in poor weather.</p> <p>Re new location- will it obstruct pedestrians??</p> <p>Will it be large enough to give adequate shelter?</p>
128	The Viewing Platform
129	<p>Although not transparently and explicitly noted or explained in the document delivered to households, it appears that access from Roseburn Gardens onto Roseburn Terrace is being closed. This should not be allowed to happen until the junction of Roseburn Street (with Russell Road) onto Roseburn Terrace is sorted out. It is a badly designed, dangerous and congested junction with numerous drivers jumping red lights from the right hand filter at Roseburn Terrace (Tesco) onto Roseburn Street. By closing Roseburn Gardens you will worsen queues at this junction, increasing wait time and congestion (and no doubt pollution levels as cars wait longer to get through), and obviously driver frustration.</p>
130	As above. I believe they are a sop to complaints about the cycle track to prove there is a "positive" within all the unhappiness about the track.
131	Wooden Viewing Platform
132	<p>Briefly, the 'viewing' platform, with its great views of the traffic. My longer answer, though, has to be the sheer absence of mature thought that underpins the project. Ideas like the 'hopscotch' pattern (again, let's play beside the traffic, kids, when there's a park round the corner) and the horseshoes set in the sandstone (!) pavement. These are frankly juvenile suggestions, which I assume came from the primary school part of the consultation, but it is the duty of the responsible adult to monitor these things rather than indiscriminately fund them.</p>
133	Platform
134	The viewing platform
135	Horseshoes from an old battle... Time Edinburgh looked forward not backwards and stopped celebrating conflict and rehashing old conflict with English Neighbours
136	"Viewing platform", parking, refuse and traffic management.
137	<p>The waste of money.</p> <p>Building a "viewing platform" seems unnecessary as the water can be clearly seen from the bridges.</p> <p>The removal of essential parking places.</p> <p>The use of natural sandstone....why not use recycled natural stone pavement slabs. (there must be stacks of it in some council depot).</p>
138	No new traffic lights at Murrayfield Avenue junction
139	No timeframe/measure of local disruption in order to carry out the work.
140	Platform railing needs to be more decorative - make glass
141	It's still not safe enough for children to cross Murrayfield Avenue
142	<p>The reduction in parking spaces for residents of Murrayfield Place.</p> <p>I also oppose the idea of the insertion of hopscotch or other games into the pavement for the following reasons:</p> <p>1. It's not the safest area to encourage children to play in. I live on Murrayfield Place and cross this area every day back and forth from the bus stop. Even with the reduction in some car traffic and parking this remains a busy area for cars with a tight corner. Bikes are also a road hazard for pedestrians and children playing. Other aspects of the scheme provide interest for children such as the plants, views, nature interest etc. For this busy area I think it would be safer to stick to features of interest for children rather than features for play such as hopscotch.</p>

Q6.	What (if any) is your least favourite part of these proposals?
	2. It is one feature too many. While I believe the proposals to resurface the street and introduce more parking and planters will enhance the area, insertions like this into the pavement could make the area look cluttered.
143	N/A
144	Traffic congestion in Murrayfield Place is already a problem, especially when the school day ends at St George's. This will get worse with the removal of the access to the main road for traffic heading into the centre of town. Coltbridge Terrace should be made into a one-way road, with the direction of traffic towards St George's (and Ravelston) to reduce the problem in Murrayfield Place.
145	Narrowing of Roseburn Terrace due to cycle lanes
146	Concern about idling traffic on Murrayfield place
147	The removal of very limited parking for visitors and residents.
148	PARKING REDUCTION - yet again. My business requires patients and deliveries to have adequate access to the premises. It is another removal of access for the elderly and disabled members of our community whom I serve and care for amongst others. Wooden platform - impractical material for maintenance and dangerous when not properly looked after. Loss of established trees to make way for the viewing platform. Paving is required and not cobbles - slippery and impractical for those members of the community who have mobility issues (walking aids, wheelchairs and pushchairs to name but a few).
149	* reduction in parking - especially with the wider massive dis-improvements to parking in Roseburn area *wooden viewing platform that will quickly require maintenance and become dangerous *lack of replacement paving in the wider Roseburn area *lack of plan for clear waste disposal areas that are out of site but still accessible * restoration of antique lighting / addition of further antique lighting in the Coltbridge environ *loss of existing trees within the 'viewing platform' area * lack of any clear plan for on-going maintenance of any greenery installed *cobbles are very challenging for people in wheelchairs or with mobility difficulties to negotiate. Replace this cobbled area with proper paving as with the rest of the area - preferable
150	Viewing Platform. Hopscotch area
151	Viewing platform.
152	The closing of the slip road will add to congestion. At busy times it eases the flow of traffic from Murrayfield Avenue and Coltbridge onto Roseburn Terrace.
153	The timber platform, as there is basically no logical reason to have one especially as there is little to see and it will not look as per the artist impression due to the lack of mature trees. I would also add that the vandalism seen only last week to the CCWEL notice boards on the footbridge and the awful vandalism at saughton park which saw an area set on fire, strongly suggests that a timber viewing platform with be covered in spray paint and likely set alight! This is worrying considering the proposed location of the substation.

Q11.	Do you have any comments, or is there anything else that you would like to see in this place?
1	More emptying of communal bins, general tidying up & cleaning.
2	Provision for the cycle route to continue along the A8 to Corstorphine

Q11.	Do you have any comments, or is there anything else that you would like to see in this place?
3	Some forward planning so that this will ultimately join up to a segregated route along the A8. Great respect to the council officers who have maintained courtesy and professionalism in the face of misinformed and hysterical campaigning, and rudeness and hostility from some of the locals, including having their information boards vandalised.
4	Planting should not trap litter. I should like to see more plaques alongside the Coltbridge Canter one that would tell the history of our area.
5	Planting the signpost is better than the tree as the tree's roots will eventually interfere with the paving slabs. However, finding a way to put some perhaps disabled parking spaces here would be of better use to the local community. I'm sure there is still space for the signpost.
6	There is an above average number of elderly people in this area, who appreciate the local shops and beautiful park. Much of what we appreciate and enjoy - and the reason we chose here to live - will be spoilt by your plans. CYCLISTS and pedestrians in the park do not mix - that has to be addressed. WATER of Leith can be viewed by looking over Coltbridge!
7	The plans and discussions with council representatives on the bridge have left me puzzled as to the traffic flow at the end of Murrayfield Place and Murrayfield Avenue; however I was reassured this access to 2-way traffic was remaining in place. Is the slip road from Murrayfield Place to Roseburn Terrace is removed careful consideration would need to be given to how you exist from Murrayfield Place to Murrayfield Avenue. Moving all the bins to the end of Murrayfield Avenue very positive, as previously mentioned this would ease parking on Murrayfield Place and improve the area greatly. Also worthwhile for the council see who uses these bins as often over flowing with works material and seen to be filled by non-residents.
8	Little thought has been given to the impact of these proposals, especially the viewing platform, on the surrounding residential property
9	This seems like little more than a CV-boosting vanity project for members of the Community Council. The purported benefits do not justify the disruption in the area during construction/refurbishment. Staging a market is not viable since there is not enough ground space for it and parking is quite limited as it is (the stall operators will all likely have vans). The area is certainly not in desperate need of attention, unlike many other neighbourhoods in the city. While I appreciate the work of people tending to the plants, I think that says a lot about the socio-economic status of the area. There are citizens who would benefit much more from publicly-funded projects in their area. While the CCWEL is well-intentioned, is it likely to actually reduce traffic in the area? I note the concerns of Mr Lamb about the potential breach of the Air Quality Standards (Scotland) Regulations 2010.
10	It is , in total, an expensive plan and when council finances are tight I am against it. The intro of cycle paths was not welcomed by residents and I am suspicious that the "rejuvenating plan" has been expanded to alleviate the adverse comments (or attempt to). Interestingly, you have volunteers to look after planters but will these people live forever!?? (More work for council and concentrate more complaints)
11	Great idea and should help rejuvenate the area and also assist the local business with more footfall, tourists. However this area should NEVER be used for a pop up Bar selling Alcohol! And should be zoned and protected accordingly from the licensing board.
12	Could the communal bins be similar to those in Florence? Mostly underground with smaller access bins on top. They work well in that heritage city.
13	I am a bit concerned that the underside of the viewing platform will be used by people sleeping rough.
14	As much plating and greening as possible!
15	Well done for the proposal
16	Bigger focus of pedestrianised area to increase ability to host markets, local events.
17	I quite like the idea of the viewing platform. Perhaps there could be a wildlife information board.
18	History of the place written up on display boards.
19	Seats in sunny spots so you can rest for a bit and listen to the water trickling while sitting in the sun.
20	Please go ahead as soon as possible, Roseburn needs a lift.

Q11.	Do you have any comments, or is there anything else that you would like to see in this place?
21	I am fully supportive of these proposals and believe they will greatly improve this area which has been neglected for the 20 years+ I have lived in the area and urgently needs to be gentrified for the community.
22	It has probably been said a thousand time during this consultation but it is a fact that drivers are the ones paying large amounts of tax to apparently use the roads that they have contributed to, this is not the case for a large proportion of cyclists and pedestrians and as such, much more careful consideration should be given to the driver. The loss of short term parking for drivers to use the shops and facilities on Roseburn Terrace and Murrayfield Place will have a disastrous effect on the businesses involved. The addition of part-time traffic lights, during rush hours, at the Murrayfield Avenue/Roseburn Terrace junction, with ALL traffic and pedestrian lights working in unison with Roseburn Terrace/ Russel Road, to aid a free flow of traffic.
23	Local residents concerns and objections regarding these proposed changes have to be taken into consideration. The so called improvements seem to be aimed at people passing through as opposed to the residents of this area. I am sure council funds could be used more effectively in other deprived areas.
24	Local residents concerns about these proposed changes to Roseburn area have to be taken into consideration. The so called improvements appear to be aimed at the people passing through and not the local residents who live in Murrayfield and Roseburn. I am sure council funds could be used more efficiently in other deprived areas.
25	I think it is a total waste of public money and the focus should be on improving traffic flow, not reducing it (by the closure of the slip roads.)
26	As per comment above any improvements which reduce overall volume of traffic & noise pollution are most welcome
27	The place will be much safer, friendly, better for health, safety, including children and old people; and tourists as well.
28	I feel that these proposals would make a huge and very positive difference to Roseburn. The Murrayfield Avenue/Place junction makes no sense as it currently stands and is dangerous for pedestrians. Implementing a mid-cross island and right turn lane would make this area much safer! The design looks excellent to me and I fully support it.
29	As well as the bats that regularly hunt around the bridges, and the otters, a heron is a regular visitor (it was under the new bridge a couple of days ago). There is no sign of any public waste bins other than the communal bins for residents.
30	I'm not sure about the horseshoes. At least if you're going to have them then they should be arranged as if they were from a canter or gallop rather than a walk.
31	Wooden decking is liable to slippiness. Use stone tile. This is also more durable. Traffic needs to be reduced, there is little pleasure sitting in the decking area a facing a noisy traffic jam. So – stop right turns to and from Murrayfield Avenue (it is a run rat at present). Introduce resident policy throughout the day in Murrayfield Avenue. Is the electric substation being removed? If not, the project won't work.
32	Please go ahead with this awesome scheme
33	Ensure as many native species as possible are used and those which are good for birds and bees and other wildlife Use high quality materials Ensure sufficient budget for maintenance - there are many occurrences of graffiti now along the Water of Leith
34	The proposed Bus stop will have less shelter for peak time queues which are currently afforded some protection from the wind by papes cottage.
35	I like the idea of creating a focal point for Roseburn as it doesn't currently have an identity. I am disappointed that there is no mention of encouraging wildlife in or around the river. You say it won't be damaged but bearing in mind that the world is environmentally in crisis, this attitude is out of date and irresponsible. It seemed a missed opportunity.
36	We are fortunate to have a beautiful, wild corridor running across our neighbourhood. The water of Leith eco-system has taken a hit locally from the extremely poorly executed flood works. What you are proposing here will do further damage when the trend is towards making and supporting wildlife corridors.
37	Yes. Like to see comments and stats from people living only in area. Because CEC has not listened to wishes of residents and businesses on the cycle track. Why it can't go round the back is beyond me. CEC has refused to consider underground bins and the bins area a shocker. I agree with the counter-proposals. Beautify, Cobble, Slab, Lights.
38	Whilst I am in favour of all the proposals suggested here, there are other issues in Roseburn which the Council have been reluctant to address: 1/ Parking - the area is used as a park and ride car park by non-residents. 2/ Pollution levels are far too high on Roseburn Terrace which will be exacerbated by reducing the road by half - getting rid of the bus lane and building a cycle path which may benefit a handful of people to the detriment of the 10000 people who travel by bus every day.

Q11.	Do you have any comments, or is there anything else that you would like to see in this place?
39	We are fortunate to have a beautiful, wild corridor running across our neighbourhood. The Water of Leith eco system has taken a hit locally from the extremely poorly executed flood works. What you are proposing here will do further damage when the trend is towards making and supporting wildlife corridors.
40	Main concern is the cycle path and the loss of parking and the negative impact on the businesses and it is a horrible environment for cyclists. Pollution is a problem. I will continue to cycle through the park Junction at Murrayfield Avenue and Roseburn Terrace will be difficult when driving and this proposal will worsen this. Don't like the artistic signpost and I want the bins to move. Mark the entrance with pillars similar to M'Field at the entrance to the Gardens.
41	Streetlights on Old Colt Bridge should be replica period 'gas-light' style, with 'white-light' LED fittings. It is taking much too long to deliver this project - immediate works should include remove all ivy from both bridges, paint the light pylons on the new road bridge, slightly move the litterbin which is obscuring the plaque on new road bridge South parapet. The small 'wild' space on the South bank between the bridges (with oak sapling) should not be touched - this space is required for wildlife.
42	Foul smelling drains at south side of traffic light crossing require permanent eradication.
43	I would like the bins to be hidden from general view therefore some sort of housing for the bins would in my mind enhance the area I also feel its worthwhile stating that the majority of the residents are against the CCWEL going ahead as are MCC - however in the spirit of partnership working and making the best of a bad decision I trust that the Roseburn area will be improved with the proposal in general however I cannot state strongly enough that the cycle track should not have been given the go ahead on Roseburn Terrace and would have been better served for all concerned and in the purpose of encouraging cyclists had it been installed in Roseburn Place
44	I would prefer to have cobbled setts on the bridge, to be in keeping with the historic value of the bridge. the horse shoes are a nice touch. I find it hard to believe that Farmer's Markets would set up on the Bridge, but would be very pleased if they did. A suggestion that I think would be excellent would be council maintained hanging baskets throughout Roseburn. Would support the provision of underground waste disposal, like in the Grassmarket.
45	This needs the cycle lane to be completed in order to work properly.
46	Great proposal. Very pleasing to see investment in improving an under-used area. Wonder if viewing platform could be off the 'new' bridge so not over-shadowed by trees (which I think will cause significant safety & practical problems) (e.g.: more rubbish in river)
47	No hopscotch - too near busy main road for children to be playing there. Litter bins near bus stop and on old bridge. A lot of people would not be bothered to walk to the communal bins.
48	Why develop an area in the middle of a busy traffic when you have built a lovely playground across the road away from dangerous traffic and fumes. Farmer's Market could not be sustained due to location and other markets. Why you extended the pedestrian the whole length of the road making a much longer step for young and old as well as holding up traffic for twice as long either way.
49	If the proposals could lessen the impact of the road and pollution to pedestrians then this would be preferable.
50	Lovely to see some positive environmental proposals. Too many new street trees die very quickly as large saplings shorn of most of their root-ball are used, dropped into inadequate planting holes (plenty of recent examples at Western Corner, St John's Rd, Saughtonhall Drive etc.) so please choose your arboriculture contractor carefully! Make them monitor the trees for at least 5 years and replace any dead ones at their own expense!
51	Please don't waste £ in this way. Spend it in areas of Edinburgh where there is poverty, making life better for the needy.
52	What is the cost of this project? I fear that the platform will invite people to throw more litter and junk into the Water of Leith. I thought that there were to be cycle lanes incorporated in the plan?
53	I don't see how things like the viewing area would do anything to improve the daily life of the residents.
54	I would hope that local residents are given a larger voice on these proposals. My main concern is the closure of the slip road. I live in Coltbridge Gardens and getting out onto the main road is at times very challenging.

Q11.	Do you have any comments, or is there anything else that you would like to see in this place?
55	Unnecessary use of public money. Huge quantity of unnecessary disruption for local residents. The plans are suitable for new developments and outside offices, not outside an old area. The only things that need to happen - removal and relocation of bins & looking after what is there.
56	Unnecessary use of public money. Huge quantity of unnecessary disruption for local residents. The plans are suitable for new developments and outside offices not outside an old area. The only things that need to happen - removal and relocation of bins & looking after what's there.
57	In general, I support the plans, but I am very much against the installation of a viewing platform over the Water of Leith. I support the introduction of new plants or trees to the area I am keen to retain existing recycling facilities, introduction of bottle bin would be good.
58	Concern that the removal of short stay parking on north of bridge will impact on local businesses.
59	I would like to see the use of the Old Coltbridge restricted to pedestrians. It is used regularly by older people. I understand that joint use by cyclists and pedestrians has caused problems in Roseburn path. The introduction of a cycle path gives enough priority to cyclists.
60	There must be regular, frequent street cleaning, bin emptying and area maintenance. An absence of litter would, by itself, have a huge positive amenity impact on Roseburn in general and this particular area no less. Without regular litter (and leaf in Autumn) clearing and good maintenance and bin emptying (also to ensure there are enough bins - they are nearly always overflowing) no Scheme can or will work. Litter and Graffiti, once they become an established sight, bring an area down and attract more of the same and also anti-social behaviour, turning into a vicious circle. If the Viewing Platform area is not well and continuously maintained it will soon become an eye sore and dumping ground for litter. Present litter collecting and maintenance regimes are barely short of disgraceful and there is always litter and dirt on the old bridge and the area surrounding it.
61	It is very welcome to see action being taken to improve the amenity of this area, as currently there is huge amount of potential and it could be very attractive if the plans are progressed.
62	I have noticed an increase in graffiti in Roseburn and Murrayfield area. It would be a shame if this upgrade was not respected.
63	I would like to have seen included in the plan a continuation of the path along the southern back of the Water of Leith from Stockbridge being continued under the bridges. That would be an enhancement and bring the river more into Roseburn especially if there was a new access point to the path at a suitable point in the scheme.
64	My only concern is the management of traffic at peak school drop off and pick up times - there is a strong likelihood that Murrayfield Place running up to Coltbridge Terrace will back up horribly with St. Georges parents - have the school been included in this consultation? Other than that I think the proposed new area will be a huge bonus and greatly add to the area.
65	The area is currently so unsafe and polluted for pedestrians. Particularly dangerous for the many children going to and from school. Roseburn terrace is blighted by constant illegal parking in the loading bays. As a car driver, I embrace all attempts to curb the hegemony of the private vehicle. Time is up on cars having such priority and so much room in our public spaces. We have barely made the slightest attempt to limit car use in our city. It is badly needed. In terms of local amenity, the high street in Roseburn is depressed and forlorn and not a place I would currently want to go to unless forced. It will be greatly improved by this work and it cannot come soon enough. Well done to everyone involved for such great ideas and hard work.
66	A link to the Water of Leith walkway without needing to go up Roseburn Cliff and down the steps
67	I think the proposed development is fantastic. My only worry is the cyclist priority measures. I hope they do not cause chaos.
68	We so need this upgrade in this area.
69	This area really needs this.
70	Segregated cycle infrastructure, and the disregarding of anything the Murrayfield Community Council want to object to, because it will not be balanced and fair, just like them.
71	Great job
72	All exciting.
73	I realise this may be out of the remit of this project but I hope the plans for a pedestrian crossing at the Tesco end of Roseburn are still in place. It would join up the two ends and connect the

Q11.	Do you have any comments, or is there anything else that you would like to see in this place?
	traders at both end and stop Roseburn 'fizzling out' at the Tesco end. There is something else. I was really in favour of closing off Murrayfield Place which was in one of your earlier plans. I think there is still too much traffic swinging round that way and up narrow Coltbridge Terrace. The whole area suffers from being used as a general car park and (dump and catch the bus), and I'm not sure that this will really remove that issue. However please may I recommend there is a 2 hour maximum stay or equivalent for the 9 parking bays. This would help to stop the area being clogged up with commuters and help the local traders get customers that come by car in through their doors.
74	One suggestion which may be obvious / already considered but wasn't clear from the diagrams: There are some lovely, spacious new pedestrianised areas here, but these can be ruined very quickly by parked cars if there's nothing to stop cars. Perhaps some bollards should be considered to stop cars parking on / using the old colt bridge and surrounding areas? Overall I'm very happy with these plans; the attention to detail, effective communication with the public and management of the project overall has made me very proud to live here (in Roseburn, and in Edinburgh as a whole). Thank you!
75	So excited to see such great ideas going ahead in Roseburn. It's definitely my favourite area of Edinburgh I've lived in after 15 years in this city.
76	My only comment would be with regards to the bin store location. Whilst I very much agree this is the best location for the bins I wonder if it would be worthwhile designing/ creating some form of disguise, perhaps through the landscaping of the grassy area immediately behind the proposed location, in order to reduce the visual impact of what could be a rather ugly collection of bins especially given the efforts that have gone into the designs for the rest of the area.
77	Congratulations for making an imaginative layout to enhance the "2-bridges" area
78	Hopefully this will develop local shops, amenities to the area, which it is looking. In particular coffee shop/kiosk, restaurants. Would like to know timescales for commencing and completing project.
79	I hope we actually get street market here - they're popular in Stockbridge!
80	I would like to see Murrayfield Place closed to traffic during the weekend so Saturday and Sunday markets could be sat up.
81	We need a safer way to cross Murrayfield Avenue where it meets the A8. There is little point in improving the general amenity if it is still problematic for people to get there. This is a very very busy and dangerous junction at peak times and either a zebra crossing or pelican crossing would make a big difference particularly to schoolchildren and people with mobility issues. If these types of crossings are not feasible for this junction then perhaps the whole junction should be reconfigured using traffic lights.
82	I would prefer seating which serves more than one purpose e.g. the seating at the community garden along the river at Balgreen is drystone type which provides insect homes. For the planters I would like to see edible plants and herbs as a community resource and a fruiting tree
83	Thanks for all the hard work that's gone into this plan. It looks really good. As noted above, please could it be made clear to cyclists that this is a shared space with pedestrians, children, dogs etc., and have a maximum speed limit for cyclists please can the fish van that visits Roseburn every Tuesday continue to have access & a Parking Space.
84	Similar to Q4; I struggled to find any info on costs or proposed implementation timelines. Who ultimately decides what, if anything is done? I'm broadly supportive of the idea, but only to the extent that budget is available and is not delivered from other important services - roads are in very bad shape (pot holes), schools need more funding, etc...
85	Please consider reducing the speed limit on Roseburn Terrace (specified on map) to 20mph
86	It would be good to be able to connect the viewing platform through a walkway to the Water of Leith pathway.
87	Are there enough public benches around the new site? Who will manage any market / stalls on the site? Is there a danger of traffic backing up from the T junction beside Tesco's? If my understanding is correct that the 4 lanes for cars in Roseburn come down to 2, due to bus and cycle lanes, then won't there be a large tail back of traffic trying to turn right at the junction beside Tesco's to get into Russell Road? That will make the viewing platform rather noisy and dirty.
88	I am very pleased to see that these changes as they will make Roseburn feel a little less car dominated and provide a space where people can stop and rest or chat.
89	Wider pavements, a crossing for the A8 at Roseburn Street.

Q11.	Do you have any comments, or is there anything else that you would like to see in this place?
90	Is it possible to also have a simple bench on old coltbridge if people opt for the signpost rather than the cherry tree and bench. Some seating around that area would be good. These plans are a positive, forward-looking vision for our local area and we must not be held back by the small group of bullies who are desperately opposing change and trying to force their views to prevent what they personally don't like. Well done to the team involved in this exciting project!
91	No communal bins please!
92	Plant a tree with seating. Add the signpost with historic information with another signpost somewhere else. I like the plan a lot. Well done!
93	Community planting and gardening group is a good idea. Would there really be space for farmer's market with everything else? If this area is to enhance the amenity value of the Water of Leith at Roseburn, Cyclists should NOT be encouraged or allowed to cycle through it. And too many signs will spoil the whole concept.
94	Lots of seating
95	I think this will make Roseburn even more of a desirable place to live.
96	No
97	Terrible Idea
98	Get rid of the cobbled section. This will be slippy and avoided by cyclists, the infirm, and pedestrians alike, making it unnecessarily crowded at the sides of the bridge. Why is the bus shelter being moved? Putting it there will just block the pavement, the way the one on the other side of the bridge does. Better where it is.
99	Don't move the bus stop - better where it is
100	Options for bine placement not clear on this form. Option A is on Murrayfield Avenue not Murrayfield Place (address of old phone box). Not happy with bins on Murrayfield Ave given street is listed.
101	There is no mention of the proposed cycle-way in these plans, are you trying to implement this through the back door?
102	Shortening of the bus lane travelling east into the city centre by 100 yards or so, in order to be able to turn left into Murrayfield Avenue legally without waiting 20/25 minutes to do so!
103	The changes proposed by this scheme make the original Roseburn Action Plan seem very modest by comparison. The present residential and local character of Murrayfield Place and the Old Bridge will be lost and replaced by smething like a plaza in a commercial district - wuite out of character, and probably against conservation guidelines.
104	Why can't a signpost be integrated with a tree? I like the proposals as a whole but I am concerned that locating the bus stops directly opposite to each other will cause congesting on the bridge.
105	The main difficulty will be the constant build-up of traffic. This will led to increased levels of pollution in the area. I have asthma which will be affected badly. I won't be able to sit on your platform. London and Birmingham are trying to reduce pollution from cars etc... Edinburgh Council are moving in the opposite direction.
106	I have chosen to ignore questions 11-14, as I dislike all of your proposals.
107	At first I thought this was an April's fool. Only Imbeciles and idiots would think of this rubbish. Local residents don't want this cycle track. Total waste of money.
108	<ol style="list-style-type: none"> 1. This whole scheme is a total waste of precious resources & financially & ethically unjustifiable in any economic climate, far less at the present time. 2. This is the principal route between Scotland's capital & its largest city, Glasgow. To restrict further communication is nothing short of a criminal proposal. 3. If monies are available for such "schemes" they could be better used to repair roads & pavements, which are a national disgrace. 4. Plum jobs for the City architects et al - where are the costs?
109	Cycle lane will cause chaos. No thought given for local residents, elderly people or shopkeepers. Cyclists pay nothing towards upkeep of roads, no tax or insurance. Leave Roseburn as it is.
110	Underground waste storage, hanging baskets throughout Roseburn, pressure clean all stonework, new paving with Caithness slab

Q11.	Do you have any comments, or is there anything else that you would like to see in this place?
111	<p>1 - Cobbles on bridge - safety issue as ice/ rain make slip on bike/ by older pedestrians more likely 2 - Paving looks horrible - bland modern shopping precinct not historic area 3 - Hopscoth paving - children should not be encouraged to play along busiest road in Edinburgh. Wonderful park 3 minutes away! 4 - Roseburn is a fabulous place to live and does not need 'Rejuvenation' in this manner - spend money on pavement and do not destroy our community by building cycle track through it!</p>
112	<p>I have lived in Edinburgh for thirty years and am aware of many areas which would benefit from the expenditure of public funds. An attractive green corner of Murrayfield is not one and seems a bizarre priority. This is a solution in search of a problem. The proposed farmers market presents a clear obstruction to emergency vehicles which would have to make a detour along Murrayfield Avenue, Henderland Road and Coltbridge Terrace. You may wish to assess the suitability of this alternative, particularly the width of the latter with parked vehicles and speed bumps. My answer to questions 12 and 13 is 'neither'. It would appear that plans are already advanced and your brochures make clear that much expenditure has already taken place. I am grateful for the opportunity to take part in the consultation, but fear this is tokenistic.</p>
113	<p>This project is completely unnecessary and council funds would be better spent in more deprived areas of Edinburgh</p>
114	<p>Sorry confused you state you are introducing the planter , I don't care if it is straight orbit I don't want it</p>
115	<p>Bringing all cyclists through the shops during rush hours is putting their health risks as though placing a GAS CHAMBER during those times. Stupid! Both the tree and the artistic signpost are bad ideas. Seats facing north are for seeing the jams.</p>
116	<p>Can't see how anyone would want to sit at the most windy corner with traffic pollution from cars and buses</p>
117	<p>Please make tactile paving bright colours instead of grey so that its function for the visually impaired is served.</p>
118	<p>As I have said, these idealistic views look lovely - like a ladybird back design from the 60s when there were fewer people and fewer cars. Ok, I am very disabled and have to use my car all the time, but from doing this I have seen how the shops and cafes need this facility, and how many people stop off on their way to and from places. I lived in Melbourne for many years, a city with VIBRANT local communities. And one of the reasons? Masses of easy parking so that people could visit + use the shops, the cafes, etc... Lots of people walking around but they often had to get there by car; encourage bus use, encourage bikes but still include the cars. Position of bins: The one that is least intrusive. Planter walls' shapes are not of particular importance in the whole scale of things. PS: Sandstone ALL the pavements so everyone stops tripping over the cracks. This is more important than redoing a bridge that is already lovely.</p>
119	<p>Too higher priority is given to bicycles and the riders. Not enough care is given to the children or elderly. Cyclists do not stop or slow down for pedestrians either at Roseburn or the Water of Leith Walkway.</p>
120	<p>I would like it to remain as it is. This is a residential area and for those living close to this proposal would suffer terribly. The litter would be awful, it is bad enough as it is, but we all help to try and keep it litter free. Would be very bad and we are not????</p>
121	<p>I hope that the residential area surrounding Roseburn will not be compromised by congested traffic and parking. Already the adjacent streets to the North are increasingly busy especially during school times + holidays.</p>
122	<p>Is it wise to have a play area with perhaps hopscoth on a fairly small area with roads on three sides? I do see that the busy road is screened by trees.</p>
123	<p>Recent increase of graffiti in the area. Is there sufficient maintenance budget for these proposals. What is that budget?</p>
124	<p>1 - It would be good if local cafe had a satellite on the south side of the road to supply bridge area and platform 2 - Make as much of the platform solid paving and where suspended use recycled plastic type products. (wood look alike)</p>
125	<p>Why are we spending money the council doesn't have on changing the proposed area I would much rather you fixed the existing road & pavement I cannot understand how you have managed to extend the piece of road where the new bus stop is proposed as this is much shorter in reality than your proposal makes out.</p>
126	<p>The whole plan is a utterly and total waste of money just to put a cycle path in. The money would be much better spent repairing the roads, which as I am sure are aware are appalling. Local shops will suffer as a result of no parking.</p>

Q11.	Do you have any comments, or is there anything else that you would like to see in this place?
127	More historical investigation of the place and contemporary paving methods (e.g. horonizing) is needed to adequately inform the proposals.
128	I am concerned about the flow of traffic as I feel traffic will be sitting more throughout Roseburn especially if Roseburn gardens are closed. As we live in the area and my children walk to school I am worried about the increase in pollution and the effect on their health and mine as an asthma sufferer.
129	Would be nice to have some old-fashioned style lamp posts with brackets for hanging baskets. Having the whole of the old bridge in cobble stones would be lovely and perhaps some of the areas by it could also be in cobbles? (For example, the areas at either end of it?).
130	1. Put seats on the East Side of the Old Bridge (Facing West) away from the worst of the pollution and noise of the main road. 2. Big issue on the road plan is the turn to and from Roseburn Terrace to Murrayfield Avenue (and Murrayfield Place) this is really dangerous in all directions and has not been addressed at all - traffic lights? Roundabout?
131	Roseburn is a beautiful peaceful area to live in and the community would like it to stay that way. Introducing street markets and viewing platforms would be unnecessary and take away the tranquillity that drew us long standing residents to the area in the first place. Please respect the views and knowledge of the people who live in, and love their already beautiful surroundings.
132	Is the pavement beside the Murrayfield Place shops big enough for outside seating for the cafe?
133	I attended the DAAA AGM 2018 where it was made very clear to residents by R McMeddes that this proposal went hand in hand with the cycle path proposals and if residents did not accept the cycle path proposals, this amenity improvement plan would NOT happen. This document does not make this condition clear to residents i.e. that by approving this proposal they are inadvertently lending support to the cycle path, which many will have objected to. The cycle lanes are cunningly edited from pictures in the document, the only obvious hint being the moved bus stop. This is underhand and lacks transparency, and the council should make this clear to residents.
134	I would never wish to stand in the way of improvements to the community but my real concern is that once the local vandals get their hands on it, unless it is properly maintained, it will soon become an eyesore. Just look at the Roseburn Corridor and even Roseburn Park itself. The idyllic picture you paint would be wonderful but my view it that the fussier it is, the more chance of being a target. So simpler layout and less planters!
135	Wooden platform is bad idea. Leaves, bird droppings, rain will make it slippery. The pavements are not swept so not much chance for the platform. Will bins be emptied more regularly? will grass be mowed regularly? Who will stock planters?
136	Do you really think asking us whether we want straight or curved sides on a planter amounts to serious consultation? This is one of the very few decisions I'd be happy to leave to you. The bins around Roseburn, at Coltbridge as well as beside Tesco and at the junction of Roseburn Place and Roseburn Drive are unsightly and prone to moving around. Addressing this would be a great step forward. One of the longstanding amenity issues of the area, although not directly concerned with Coltbridge, is the closure of the Water of Leith Walkway west of Dean Village. Roseburn has some of the best walking and cycling routes in the city, being at the intersection of the Water of Leith walkways and the disused railway line extending the Leith. I'd like to see the apparent stalemate around reopening this stretch of walkway being urgently addressed.
137	The platform will require maintenance which costs along with the cost of construction - No Platform
138	I think asking the community to take a view on whether a planter is straight or curved is insulting as it is so irrelevant We want available parking for short visits and pickups, good bus services, a modern solution to garbage pickup, not this terrible outdated and inefficient wheelee bins. Lower business rates would allow local businesses to improve their offer. More upheaval in this area will I think just about kill local businesses. I would be interested to see the results of a survey from the local area residents, the EH12 5 postcodes. I have seen endless complaints about the planning of this from my neighbours to your department so the claim that this is supported by the community is hard to believe
139	Refuse should be underground, commuters should be restricted from parking and absolutely the "viewing area" should not be built.
140	I honestly would rather see the money spent on cleaning the streets and clearing up litter and rubbish which is everywhere in Edinburgh. It is such a beautiful city, spoilt by the degrading filth. Wastepaper baskets/cigarette butt disposal
141	I think this is a really wonderful idea and it's great that you are trying to make this a more community-friendly space.
142	Looks great and a brilliant start, it would be a shame to stop there however and I have more comments relevant to the surrounding area.

Q11.	Do you have any comments, or is there anything else that you would like to see in this place?
	<p>1. Right turn at Roseburn bar is a nightmare, not sure how it could be improved however</p> <p>2. People use Roseburn place as a shortcut to skip the traffic lights, this should be discouraged</p> <p>3. Shop fronts and pavements could be cleaned / tidied. Even a power wash would be good!</p> <p>4. Lots of hanging cables on building fronts, unsightly</p> <p>5. Encouragement for residents to improve the small front gardens (competition?)</p> <p>I like the sound of markets and events in the communal space however as a resident I am concerned about parking, which is already tricky at busy times. Could permit parking be considered for this area?</p>
143	<p>I think this will have a great effect on this area + local community as it will maximise Roseburn's potential. I would (and form many years have) liked to see one or two more cafe/coffee shops along the main road as I often feel like there would be sufficient local demand - hopefully these plans will draw people out and about in the area more + one daytime/night have some more local cafes as places to meet + chat with local friends.</p> <p>Some nice flowers and plants.</p>
144	<p>I'd like to see a safe crossing over Murrayfield Avenue. Zebra, pelican, or any other would do. On Roseburn Terrace cars regularly drive through red lights. A camera would be a welcome addition.</p>
145	<p>As a resident of Murrayfield Place, improvements to enhance the streetscape are welcome. It will also be great to improve the appearance of this area, which is an important route from the west into Edinburgh, for visitors and other user's not just residents.</p> <p>I do however question whether this area is the most deserving of rejuvenation. I used to commute to work by tram and wonder if the residential area of Roseburn itself to the south and the route along Roseburn Street, which passes Russell Road (where you can join the cycle network from), Roseburn Primary School and the Murrayfield Tram stop, would benefit more from improvement. This is an important route for those cycling to work or using public transport.</p> <p>There is quite a difference in property prices between the residential area of Murrayfield near the proposed scheme and the area of Roseburn to the south. The pedestrian area around Murrayfield Place and the bridge is most frequently used by Murrayfield residents and those attending George Heriots School (from my observations). It's a fairly privileged demographic and I question if the area should be the priority for a rejuvenating scheme.</p> <p>Murrayfield does seem to have a very active community council however so I'm sure whichever new scheme goes ahead will be well cared for!</p>
146	<p>If the bins are at Option A - is there scope for screening them somehow to reduce visual impact from Murrayfield Avenue?</p>
147	<p>Good plan, subject to my comments in question 10</p>
148	<p>Communal bins to be set in an "enclosed" store to ensure litter/rubbish is contained, also to prevent movement of bins across pavement, possibly on the roads - given the winds they will be subjected to. Bins to be emptied very regularly to ensure there is no eyesore/vermin hazard similar to that at the corner of Tesco/Russell Road which is a disgrace to the area!</p> <p>Additional uplifts/street cleaning on football/Rugby match days, concerts/gigs, other events as appropriate.</p>
149	<p>Ensure there are litter bins included in the design + ashtrays</p>
150	<p>I would like to see the space used for local events</p>
151	<p>In the paper version, at question 13 the order of responses is the other way round (straight v curved (online) or curved v straight (paper)).</p> <p>The change for traffic trying to go from Murrayfield Place to Roseburn place will be detrimental and lead to delays with the knock on idling queues and fumes. Consideration could be given to making this section of Murrayfield place traffic free.</p>
152	<p>I think, with the money being used to try and improve the area. More focus could be put on the traffic flow of the area and trying to improve the air quality of the street. Also, there are currently several variants of trees and bushes in the area of the platform. The plans look to remove these and reduce the amount greenery which will increase the pollution. The wooden platform also had a risk of severe deterioration if not maintained correctly and on a regular basis to prevent rot in the wood.</p>
153	<p>PARKING - these local small independent business should have council support for access to these premises and not continued obstruction to the survival of small local businesses. The further removal of parking facilities impedes the patronage of patients, their carers, those with children and delivery facilities. The grudging acceptance of the transport convenor's attitude towards in relation to a potential compensation scheme in a recent committee meeting provides clear demonstrative evidence of the attitude towards the council of supporting small business in this local community - a little sign saying 'business open as usual' is little more than an insult to those of us who are contributing to the economy of our city and provide essential public services to its residence. These are our livelihood. Tokenistic consultations where the views of the residents WITHIN the local community are dismissed out of hand without so much of a second glance while</p>

Q11.	Do you have any comments, or is there anything else that you would like to see in this place?
	<p>all the while steam-rolling the predetermined outcome from our council only serves to engender a sense of cynicism, and disillusionment in the democratic process within this city. The council should have responsibility in maintaining the planters. Option B for the bin location is much more respectful for those whose windows will be exposed to the stench of unclean, overflowing bins and filth underneath the bins especially in Summer months if option A is selected. A play area is complete folly - to encourage children to play next to a main arterial road is not only foolish for their safety, but also their well-being. The exposure to the noxious fumes to young children is a misguided option.</p>
154	<p>*improve the parking in the area - don't just keep on taking away spaces. You are killing the opportunities for local business to have easy free parking nearby - as is the case in the Blackhall Dip - same size road layout as Roseburn Terrace, next to this site, but with significantly fewer businesses and vastly more off-peak parking opportunities. Reducing the parking (on top of the existing plans to decimate the Roseburn Terrace parking opportunities) will only cause further misery to local businesses and damage to the local economy *spend money properly sorting out the recycling bin facilities * It is foolhardy to be trying to encourage children to play next to a very busy road, not only for safety, but also the high levels of noxious pollution from the road that they will be exposed to * Strongly against the concept of encouraging children to play in this area - planning hopscotch metres away from an extremely busy main arterial road in and out of Edinburgh compared to the nearby Roseburn Park. *why not introduce plants/greenery/hanging baskets in the Roseburn area, similar to Bruntsfield area, maintained by the Council using this money instead of wasting it on convoluted structures that bring no real benefit to the wider area and require significant maintenance</p>
155	<p>The scheme involves an excessive amount of public spending. The area could be enhanced with more limited spending.</p>
156	<p>Total waste of money. Please stop spending money on these ridiculous proposals</p>
157	<p>Option A is a sun trap on a hot day and not a good place to locate the bins It was requested that the bus shelter at the bottom of Roseburn Cliff be relocated or moved back a foot or so to its original location as it is impossible to see what is coming when trying to exit Roseburn Cliff onto Roseburn Terrace. If the two way cycle lane is in place a car would already be into the lane before it can see oncoming traffic. From the plans the bus shelter has been relocated but now there are two trees planned to block the view!! The plan doesn't show the two way cycle lane proposed for the main road</p>
158	<p>It would appear that our local council care little about the elderly and infirm in the Roseburn area. Once the cycle track goes ahead, which nobody in the area actually supports (over 5000 residents signed a petition) or wants. We are very likely going to have to live with long lines of static traffic. This area is a major artery carrying vehicles across town to all of the private schools. I can only assume with this proposal that the Council anticipate motorists using alternative routes to avoid the congestion, however it is likely that the status quo will remain as I do not believe that those parents shuttling their kids to and from the private school will change their routes. Their preferred route is evident by the substantial drop in traffic during the school holidays. Therefore to situate a large planter with seating between two roads, Corstorphine Road and Murrayfield Avenue seems absurd. It stands to reason that the area is very likely to have static traffic over prolonged periods throughout the day, thus producing copious amount of NO2 in area which has already been identified as being on or above acceptable pollution levels (over 40 ug/m3. Who would want to sit there and have their lungs destroyed. We often encounter a south westerly breeze on this particular corner therefore I strongly suspect that as the corner is so exposed it will be a very draughty place to sit, not ideal for the elderly or those with young children. Then there is the close proximity to the substation humming away, none of these circumstances is conducive to a comfortable seating area. The seating is also located next to the relocated bus stop. While it is acknowledged that the Council are replacing old style buses with those with low emissions, the bus time tables are not being altered. With the traffic being slowed down to a crawl by the cycle lanes those sitting on the planter will be constantly overshadowed by buses arriving as they tend to do in convoy. Who would want to sit there!! I would therefore suggest a lovely planter with greenery to help with the pollution but no seating. I would prefer to see more ideas for the bridged area especially where the bus stop is being removed as this small section is depressing and could do with some street art or something else to brighten up a dull space</p>