

IMPORTANT SWECO

HEALTH, SAFETY & ENVIRONMENTAL INFORMATION

IN ADDITION TO THE HAZARDS AND RISKS NORMALLY ASSOCIATED WITH THE TYPE OF WORK DETAILED ON THIS DRAWING, PLEASE NOTE THE FOLLOWING SIGNIFICANT RISKS TO HEALTH, SAFETY & ENVIRONMENT:-

THE SIGNIFICANT RISKS ASSOCIATED WITH THE PROJECT ARE NOTED BELOW

There are no Significant Residual Risks For This Element
IN ADDITION TO THE HAZARDS AND RISKS NORMALLY ASSOCIATED WITH THE TYPE OF WORK DETAILED ON THIS DRAWING, PLEASE NOTE THE FOLLOWING SIGNIFICANT RISKS TO HEALTH, SAFETY & ENVIRONMENT:-
CONTRACTOR SHOULD NOT BE AWARE OF ANY ANTICIPATED FOR THE WORKS DESCRIBED WITH THIS DRAWING. CONTRACTOR SHOULD BE AWARE OF ANY ANTICIPATED FOR THE WORKS DESCRIBED WITH THIS DRAWING. CONTRACTOR SHOULD BE AWARE OF ANY ANTICIPATED FOR THE WORKS DESCRIBED WITH THIS DRAWING.

IT IS ASSUMED THAT ALL WORKS SHALL BE UNDERTAKEN BY A COMPETENT CONTRACTOR WORKING WHERE APPROPRIATE TO A N/A APPROVED SAFE SYSTEM OF WORK.

REF: ORA/MILLAR/PAV/DESIGN/RSV/ASSESSMENT

- NOTES:**
1. ALL DIMENSIONS ARE IN METRES UNLESS OTHERWISE STATED.
 2. DETAILS OF FLOATING BUS STOPS AND ORCA WANDS.
 3. THIS DRAWING IS TO BE READ IN CONJUNCTION WITH ALL RELEVANT DOCUMENTS.
 4. TSRGD REFERS TO TRAFFIC SIGNS REGULATIONS AND GENERAL DIRECTIONS 2016.
 5. THESE DRAWINGS SHOW THE FINAL STREET LAYOUT WITH GREENWICH WAND ORCAS. IN THE FIRST PHASE HOWEVER, TEMPORARY CYLINDERS ARE USED TO SEGREGATE THE CYCLE LANES AND BUS BOARDERS WILL NOT YET BE INSTALLED (BUSES WILL CONTINUE TO STOP AT KERBSIDE)
 6. PLEASE USE THE FOLLOWING GUIDELINES WHEN APPLYING LINE MARKINGS AND INSTALLING TEMPORARY CYLINDERS IN THE FIRST PHASE:
 - 6.1. INSTALL CYLINDERS WITH A 4m PITCH BETWEEN THEM, MAKING SURE SIDE ROADS AND DRIVEWAYS ARE ACCESSIBLE
 - 6.2. BUS CAGES WILL REMAIN AS THEY ARE AND ADVISORY CYCLE LANES WILL STOP BEFORE AND CONTINUE BEYOND THE BUS CAGE.

- KEY - PROPOSED MARKINGS AND EQUIPMENT**
- STOP LINE - 200mm TO TSRGD DIA. 1001
 - BUS LANE ENTRANCE - 250mm WIDE TO TSRGD DIA. 1010
 - WARNING LINE - 4m LINE 2m GAP 100mm WIDE TO TSRGD DIA. 1004
 - MANDATORY CYCLE LANE - 100mm WIDE TSRGD DIA. 1049
 - ADVISORY CYCLE LANE - 100mm WIDE - 1m LINE 1m GAP - TSRGD DIA. 1010
 - BUS LANE - 250mm WIDE - TSRGD DIA. 1049
 - ZIG ZAG MARKINGS TO TSRGD DIA. 1001.3
 - CYCLE MARKING SIZE 2750mm TSRGD DIA. 1057
 - CYCLE MARKING SIZE 1215mm TSRGD DIA. 1057
 - HATCH TSRGD DIA. 1040
 - SPEED CAMERA MARKING. 150mm WIDE. TSRGD 1012.1
 - MERGE ARROW. TSRGD 1014 (4.5m LONG)
 - END OF BUS LANE ARROW. TSRGD 1050
 - ROSEHILL CYCLE LANE DEFENDERS - 2m LONG AT 5m SPACINGS - SEE DRAWING COM-12727-1100-01
 - APPROXIMATE DRIVEWAY LOCATIONS - SEGREGATORS NOT TO BE PLACED OVER DRIVEWAYS OR ACCESS POINTS
 - DOUBLE YELLOW LINE & DOUBLE BLIP
 - DOUBLE YELLOW LINE & SINGLE BLIP
 - SINGLE YELLOW LINE & SINGLE BLIP
 - DOUBLE YELLOW & ZERO BLIPS
 - EXISTING TRAFFIC SIGN POSTS/LIGHTING COLUMNS

VIEW 1

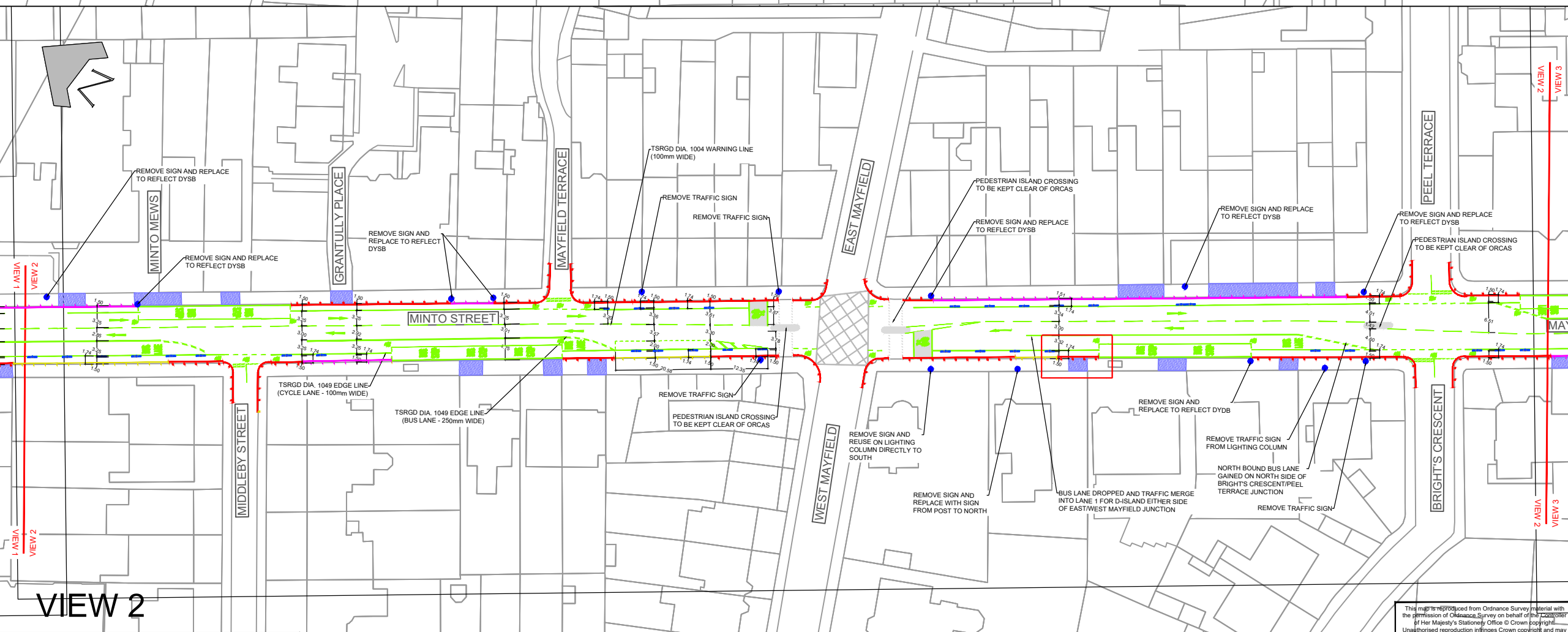
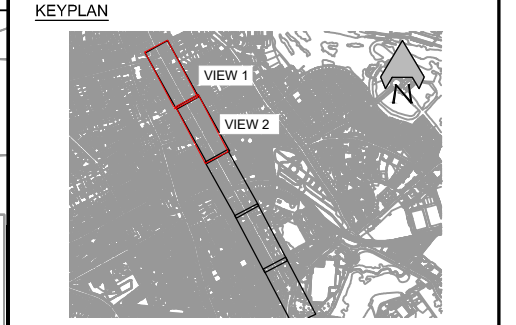

VIEW 2

sustrans JOIN THE MOVEMENT **SWECO**

10	SIGNAGE ANNOTATION ADDED	MH	14.01.2021	AM
09	CLIENT CHANGE REQUEST	MH	06.01.2021	AM
08	DESIGN ALTERATION	MH	11.12.2020	AM
07	SEGREGATORS RE-LOCATED	MH	07.12.2020	AM

REVISION: DETAILS BY DATE CHECKED

• EDINBURGH •
THE CITY OF EDINBURGH COUNCIL

The City of Edinburgh Council
Waverley Court
4 East Market Street
Edinburgh, EH8 8BG
Telephone: 0131 200 2000

PLACE MANAGEMENT
INFRASTRUCTURE
TRANSPORT DESIGN & DELIVERY

SPACES FOR PEOPLE
CRAIGMILLAR PARK
1200 ROAD MARKING LAYOUT
SHEET 1 OF 3

This map is reproduced from Ordnance Survey material with the permission of Ordnance Survey on behalf of the Controller of Her Majesty's Stationery Office © Crown copyright. Unauthorised reproduction infringes Crown copyright and may lead to prosecution or civil proceedings.

Date: 25/06/2020 Job No.: 12727 Drawn by: SWECO - PH Checked by: SWECO - AB Reviewed by: SWECO - CF Scale: 1:500

100023420 (2019)