

- NOTES:
- THIS DRAWING IS PRESENTED IN DRAFT FORM AND SHOULD NOT BE ACCEPTED AS FINAL.
 - DIMENSIONS ARE APPROXIMATE ONLY DUE TO NO TOPOGRAPHICAL SURVEY.
 - DRIVEWAYS, D-ISLANDS AND BUS STOPS NEED TO BE KEPT CLEAR OF SEGREGATION.
 - MINIMUM ROAD CARRIAGEWAY WIDTH OF 6.5m REQUIRED.
 - ALL EXISTING ROAD MARKINGS TO REMAIN IN PLACE UNLESS THEY ARE IDENTIFIED TO BE UPGRADED ON GENERAL ARRANGEMENT OR SITE CLEARANCE DRAWINGS.
 - EXISTING MARKINGS FOR ADVANCED STOP BOXES, GIVE-WAY & BUS CAGES TO BE REFRESHED.
 - ALL SEGREGATORS TO BE POSITIONED MINIMUM OF 2m FROM DRIVEWAYS, JUNCTIONS & SIDE ROADS.

- LEGEND
- EXISTING GUARDRAIL TO BE REMOVED.
 - PROPOSED CYCLE LANE DEFENDER (Fig 1.) WITH OFFSET MANDATORY LINING THROUGHOUT (LINING OFFSET BY 0.3M C/C UNLESS STATED).
 - PROPOSED ADVISORY CYCLE LANE LINING LANE & CENTRE LINES.
 - EXISTING ADVISORY CYCLE LANE LINING TO BE RETAINED (BUT NOT REMARKED)
 - EXISTING ADVISORY CYCLE LANE LINING (OR OTHER EXISTING MARKINGS AS SHOWN ON DRAWING) TO BE REMARKED AS PART OF NEW PROPOSALS
 - PROPOSED ROAD LANE MARKING TO TSRGD 1004.
 - MANDATORY CYCLE LANE ROAD MARKING
 - EXISTING PEDESTRIAN CROSSING POINT
 - INDICATIVE LOCATION OF BUS STOP MARKINGS TO BE REFRESHED.
 - CYCLE SYMBOL TO MARKING 1057
 - APPROXIMATE DRIVEWAY LOCATION - ORCAS NOT TO BE PLACED OVER DRIVEWAY OR ACCESS POINTS.
 - DOUBLE YELLOW LINE & DOUBLE BLIP
 - SINGLE YELLOW LINE & SINGLE BLIP
 - DOUBLE YELLOW LINE & SINGLE BLIP
 - EXISTING PARKING RESTRICTION SIGNS

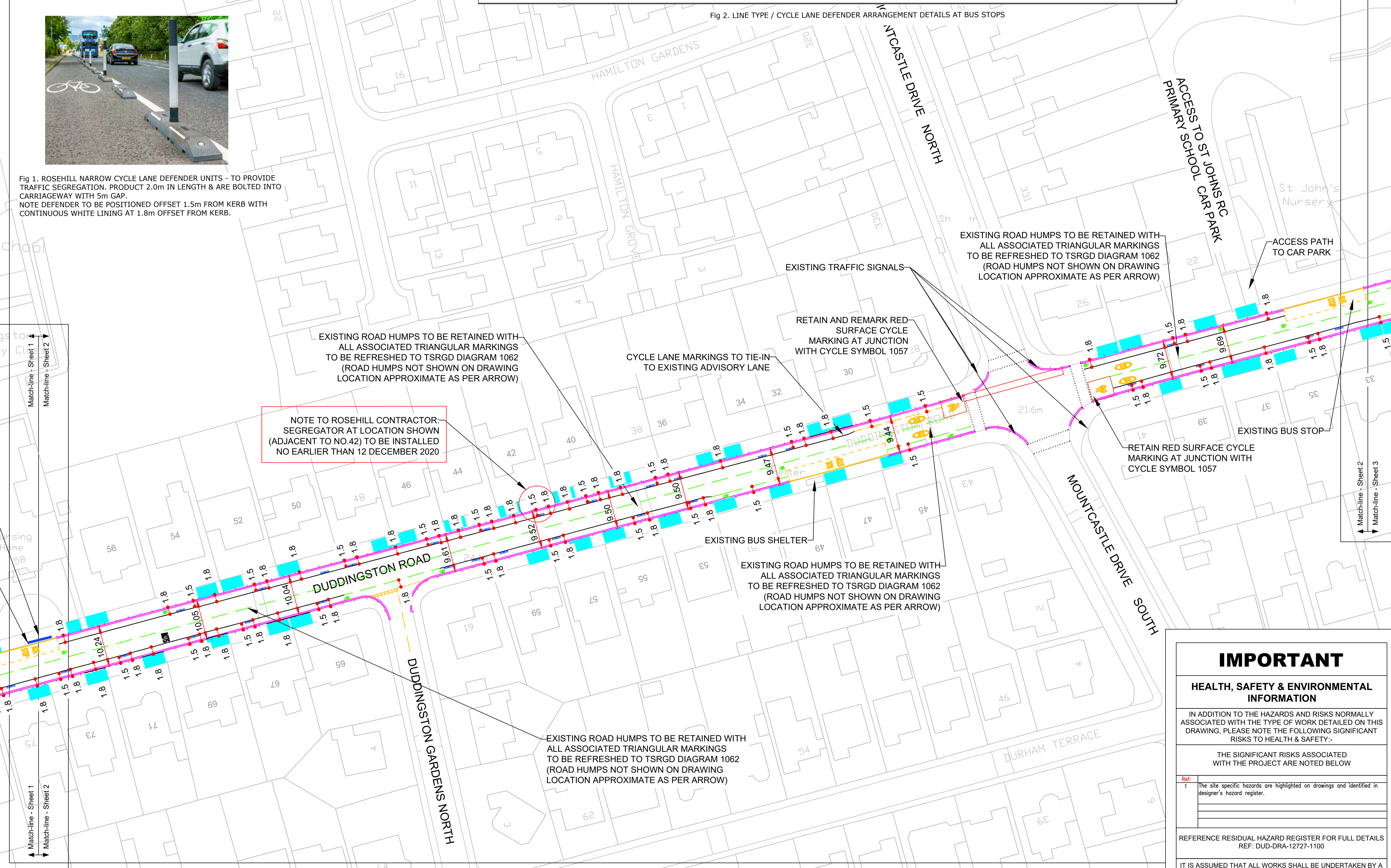

NOTE TO ROSEHILL CONTRACTOR: SEGREGATOR AT LOCATION SHOWN (ADJACENT TO NO.42) TO BE INSTALLED NO EARLIER THAN 12 DECEMBER 2020



This map is reproduced from Ordnance Survey material with the permission of Ordnance Survey on behalf of the Controller of Her Majesty's Stationery Office © Crown copyright. Unauthorised reproduction infringes Crown copyright and may lead to prosecution or civil proceedings.

100023420 (2019)

CONSTRUCTION DRAWINGS
REV B
18/11/20

IMPORTANT

HEALTH, SAFETY & ENVIRONMENTAL INFORMATION

IN ADDITION TO THE HAZARDS AND RISKS NORMALLY ASSOCIATED WITH THE TYPE OF WORK DETAILED ON THIS DRAWING, PLEASE NOTE THE FOLLOWING SIGNIFICANT RISKS TO HEALTH & SAFETY:-

THE SIGNIFICANT RISKS ASSOCIATED WITH THE PROJECT ARE NOTED BELOW

Ref.	Description
1	The site specific hazards are highlighted on drawings and identified in designer's hazard register.

REFERENCE RESIDUAL HAZARD REGISTER FOR FULL DETAILS REF: DUD-DRA-12727-1100

IT IS ASSUMED THAT ALL WORKS SHALL BE UNDERTAKEN BY A COMPETENT CONTRACTOR WORKING WHERE APPROPRIATE TO AN APPROVED SAFE SYSTEM OF WORK

REVISION	DETAILS	BY	DATE	CHECKED

EDINBURGH
THE CITY OF EDINBURGH COUNCIL

The City of Edinburgh Council
Waverley Court
4 East Market Street
Edinburgh, EH8 8BG
Telephone: 0131 200 2000

PLANNING MANAGEMENT
INFRASTRUCTURE
TRANSPORT, SIGNAGE & DELIVERY

SPACES FOR PEOPLE
DUDDINGSTON ROAD
SHEET 1 OF 3

Date: 17/06/2020
Scale: 1:500
Job No.: 636991
Drawn by: GAW
Checked by: