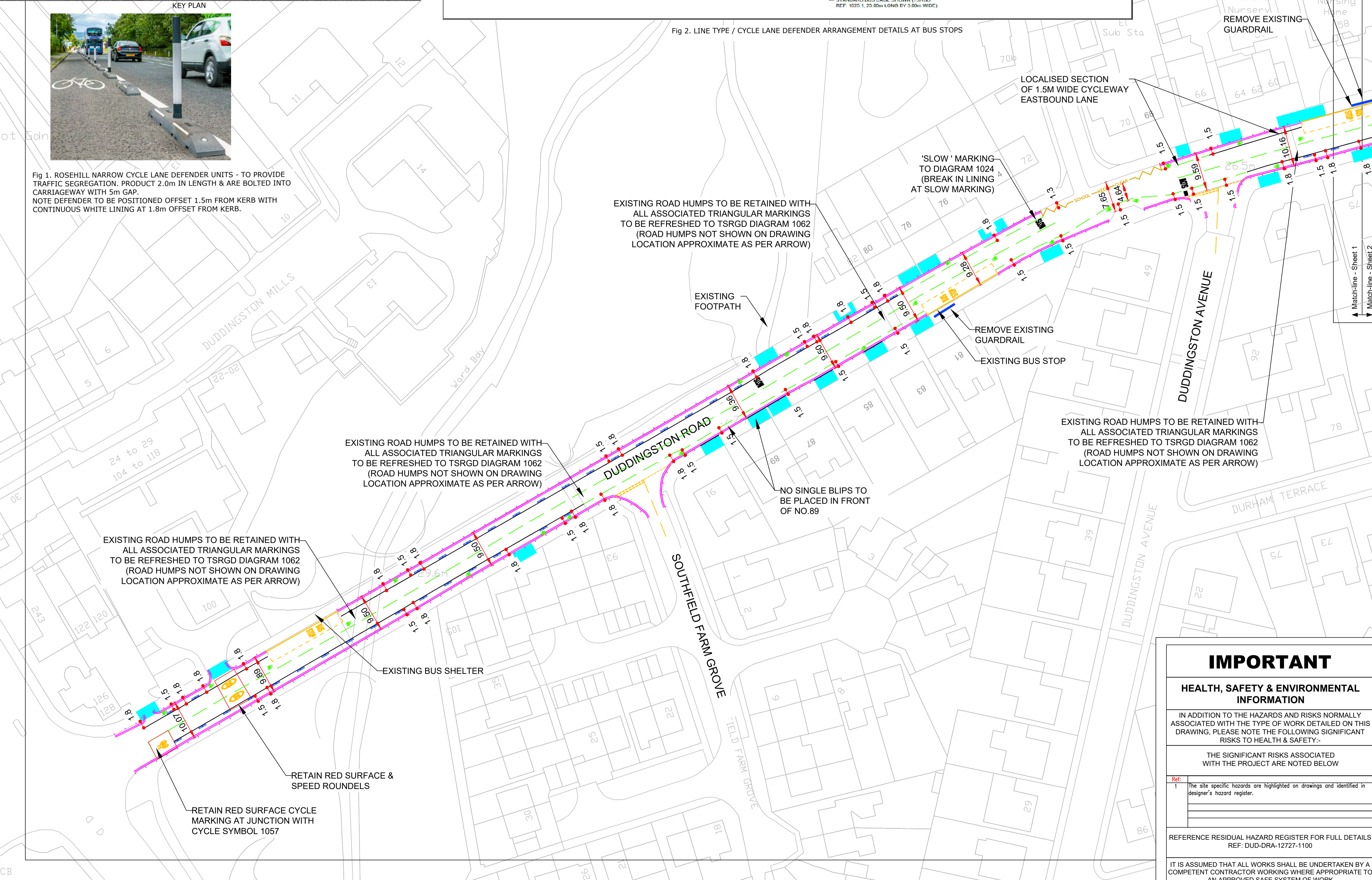

Fig 1. ROSEHILL NARROW CYCLE LANE DEFENDER UNITS - TO PROVIDE TRAFFIC SEGREGATION. PRODUCT 2.0m IN LENGTH & ARE BOLTED INTO CARRIAGEWAY WITH 5m GAP. NOTE DEFENDER TO BE POSITIONED OFFSET 1.5m FROM KERB WITH CONTINUOUS WHITE LINING AT 1.8m OFFSET FROM KERB.



- NOTES:**
- THIS DRAWING IS PRESENTED IN DRAFT FORM AND SHOULD NOT BE ACCEPTED AS FINAL.
 - DIMENSIONS ARE APPROXIMATE ONLY DUE TO NO TOPOGRAPHICAL SURVEY.
 - DRIVEWAYS, D-ISLANDS AND BUS STOPS NEED TO BE KEPT CLEAR OF SEGREGATION.
 - MINIMUM ROAD CARRIAGEWAY WIDTH OF 6.5m REQUIRED.
 - ALL EXISTING ROAD MARKINGS TO REMAIN IN PLACE UNLESS THEY ARE IDENTIFIED TO BE UPGRADED ON GENERAL ARRANGEMENT OR SITE CLEARANCE DRAWINGS.
 - EXISTING MARKINGS FOR ADVANCED STOP BOXES, GIVE-WAY & BUS CAGES TO BE REFRESHED.
 - ALL SEGREGATORS TO BE POSITIONED MINIMUM OF 2m FROM DRIVEWAYS, JUNCTIONS & SIDE ROADS.

- LEGEND**
- EXISTING GUARDRAIL TO BE REMOVED.
 - PROPOSED CYCLE LANE DEFENDER (Fig 1.) WITH OFFSET MANDATORY LINING THROUGHOUT (LINING OFFSET BY 0.3M C/C UNLESS STATED).
 - PROPOSED ADVISORY CYCLE LANE LINING LANE & CENTRE LINES.
 - EXISTING ADVISORY CYCLE LANE LINING TO BE RETAINED (BUT NOT REMARKED)
 - EXISTING ADVISORY CYCLE LANE LINING (OR OTHER EXISTING MARKINGS AS SHOWN ON DRAWING) TO BE REMARKED AS PART OF NEW PROPOSALS
 - PROPOSED ROAD LANE MARKING TO TSRGD 1004.
 - MANDATORY CYCLE LANE ROAD MARKING
 - EXISTING PEDESTRIAN CROSSING POINT
 - INDICATIVE LOCATION OF BUS STOP MARKINGS TO BE REFRESHED.
 - CYCLE SYMBOL TO MARKING 1057
 - APPROXIMATE DRIVEWAY LOCATION - ORCAS NOT TO BE PLACED OVER DRIVEWAY OR ACCESS POINTS.
 - DOUBLE YELLOW LINE & DOUBLE BLIP
 - SINGLE YELLOW LINE & SINGLE BLIP
 - DOUBLE YELLOW LINE & SINGLE BLIP
 - EXISTING PARKING RESTRICTION SIGNS

This map is reproduced from Ordnance Survey material with the permission of Ordnance Survey on behalf of the Controller of Her Majesty's Stationery Office © Crown copyright. Unauthorised reproduction infringes Crown copyright and may lead to prosecution or civil proceedings.
100023420 (2019)

CONSTRUCTION DRAWINGS
REV B
18/11/20

IMPORTANT

HEALTH, SAFETY & ENVIRONMENTAL INFORMATION

IN ADDITION TO THE HAZARDS AND RISKS NORMALLY ASSOCIATED WITH THE TYPE OF WORK DETAILED ON THIS DRAWING. PLEASE NOTE THE FOLLOWING SIGNIFICANT RISKS TO HEALTH & SAFETY:-

THE SIGNIFICANT RISKS ASSOCIATED WITH THE PROJECT ARE NOTED BELOW

Ref: 1 The site specific hazards are highlighted on drawings and identified in designer's hazard register.

REFERENCE RESIDUAL HAZARD REGISTER FOR FULL DETAILS REF: DUD-DRA-12727-1100

IT IS ASSUMED THAT ALL WORKS SHALL BE UNDERTAKEN BY A COMPETENT CONTRACTOR WORKING WHERE APPROPRIATE TO AN APPROVED SAFE SYSTEM OF WORK

REVISION DETAILS BY DATE CHECKED

EDINBURGH
THE CITY OF EDINBURGH COUNCIL

The City of Edinburgh Council
Waverley Court
4 East Market Street
Edinburgh, EH8 8BG
Telephone: 0131 200 2000

PLANNING MANAGEMENT
FRASUREMENT
TRANSPORTATION & DELIVERY

SPACES FOR PEOPLE
DUDDINGSTON ROAD
SHEET 1 OF 3

Date: 17/06/2020 Job No.: 636991 Drawn by: GAW
Scale: 1:500 Checked by: