

- ALL WORKS TO BE EXECUTED IN ACCORDANCE WITH THE SPECIFICATION FOR HIGHWAY WORKS - THE MANUAL OF CONTRACT DOCUMENTS FOR HIGHWAY WORKS, DESIGN MANUAL FOR ROADS AND BRIDGES, TRAFFIC SIGNS MANUAL AND LOCAL COUNCIL GUIDELINES.
- ALL DIMENSIONS ARE IN METRES UNLESS STATED OTHERWISE. ALL LEVELS ARE IN METRES AND RELATE TO ORDNANCE DATUM.
- DO NOT SCALE FROM ANY DRAWING. WORK TO FIGURED DIMENSIONS ONLY. ANY DISCREPANCIES IN DIMENSION ARE TO BE REFERRED TO THE DESIGNER BEFORE WORK IS PUT TO HAND.
- ALL DIMENSIONS AND LEVELS ARE TO BE CHECKED ON SITE BY THE CONTRACTOR PRIOR TO PREPARING ANY WORKING DRAWINGS OR COMMENCING ON SITE.
- ALL WORKS BY THE CONTRACTOR MUST BE CARRIED OUT IN SUCH A WAY THAT ALL REQUIREMENTS UNDER THE HEALTH AND SAFETY AT WORK ACT ARE SATISFIED.
- ALL WORK IS TO BE CARRIED OUT IN COMPLIANCE WITH THE REQUIREMENTS OF THE STATUTORY AUTHORITIES AND CONSTRUCTION DESIGN AND MANAGEMENT REGULATIONS.
- DRAWING BASE RECEIVED FROM OTHERS. SURVEY CARRIED OUT BY OTHERS. AECOM CANNOT GUARANTEE THEIR ACCURACY. CONTRACTOR TO SATISFY THEMSELVES AS TO THE ACCURACY OF SUCH INFORMATION.
- EXISTING DOUBLE YELLOW LINES TO BE REFRESHED AND ADD DOUBLE BLIPS (TABS). ALL ZIG-ZAGS, HATCHINGS AND OUTLINES OF ADVANCED STOP BOXES TO BE REFRESHED.

ISSUE/REVISION

I/R	DATE	DESCRIPTION
1.2	11/09/2020	REVISED - SITE WALKOVER
1.1	09/09/2020	REVISED ROAD MARKINGS
1.0	04/09/2020	ISSUED FOR TENDER

KEY PLAN

PROJECT NUMBER

60636731

SHEET TITLE

SPACES FOR PEOPLE
 PENNYWELL ROAD
 SHEET 1 OF 2

SHEET NUMBER

60636731-SHT-C-SP-PR-0701

KEY

- EXISTING ROAD MARKINGS
- PROPOSED WHITE ROAD MARKINGS
- PROPOSED YELLOW ROAD MARKINGS
- PROPOSED PLANTER
- PROPOSED CARRIAGEWAY SEGREGATION
- PROPOSED TEMPORARY KERB
- PROPOSED ORANGE CYLINDER POSTS
- RELOCATED CYCLE HIRE POINT
- EXISTING SPEED CUSHION TO BE REFRESHED

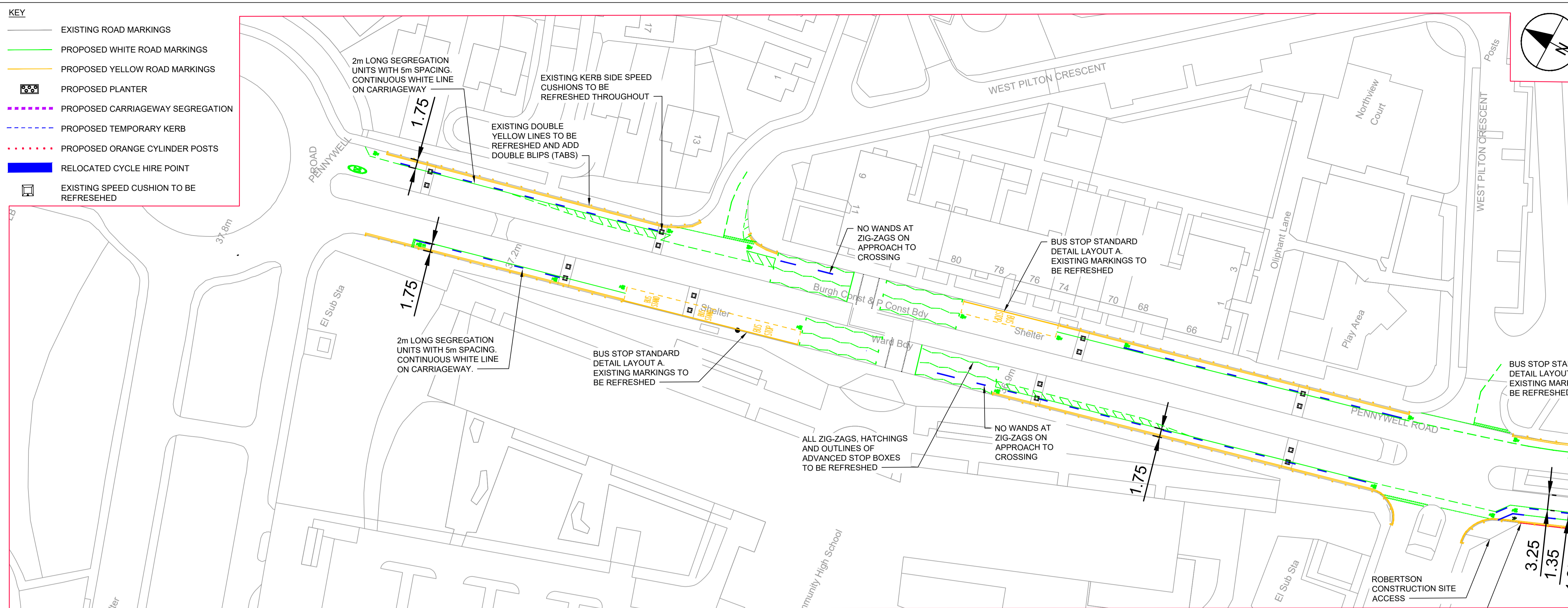

VIEWPORT 1

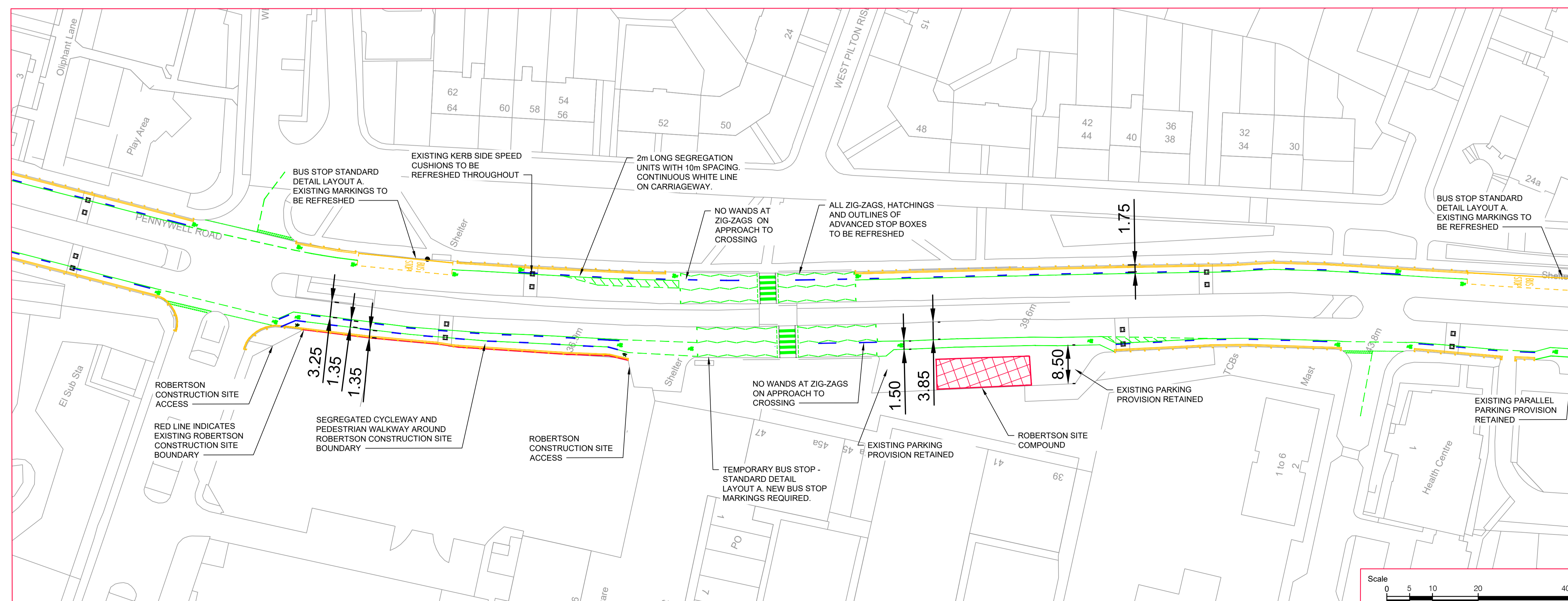

VIEWPORT 2

This drawing has been prepared for the use of AECOM's client. It may not be used, modified, reproduced or relied upon by third parties, except as agreed by AECOM or as required by law. AECOM accepts no responsibility, and denies any liability, whatsoever, to any party that uses or relies on this drawing without AECOM's express written consent. Do not scale this document. All measurements must be obtained from the stated dimensions.

File name: I:\EU\AECOM\NET\COM\EM\UK\EDINBURGH\PR-44\0653_CEC_PENNYWELL_RD\900_CAD_GIS\911_CAD25-SKETCHES\SPACES FOR PEOPLE\CURRENT MODELS\90636731-MOD-C-SP-PR-PENNYWELL ROAD LAYOUT.DWG
 Last saved by: GEORGE ANDERSON | Last Plotted: 2020-09-11

ISO A1 594mm x 841mm
 Approved: LT
 Checked: GA
 Designer: RM
 Project Management Initials:

KEY

- EXISTING ROAD MARKINGS
- PROPOSED WHITE ROAD MARKINGS
- PROPOSED YELLOW ROAD MARKINGS
- PROPOSED PLANTER
- PROPOSED CARRIAGEWAY SEGREGATION
- PROPOSED TEMPORARY KERB
- PROPOSED ORANGE CYLINDER POSTS
- RELOCATED CYCLE HIRE POINT
- EXISTING SPEED CUSHION TO BE REFRESHED

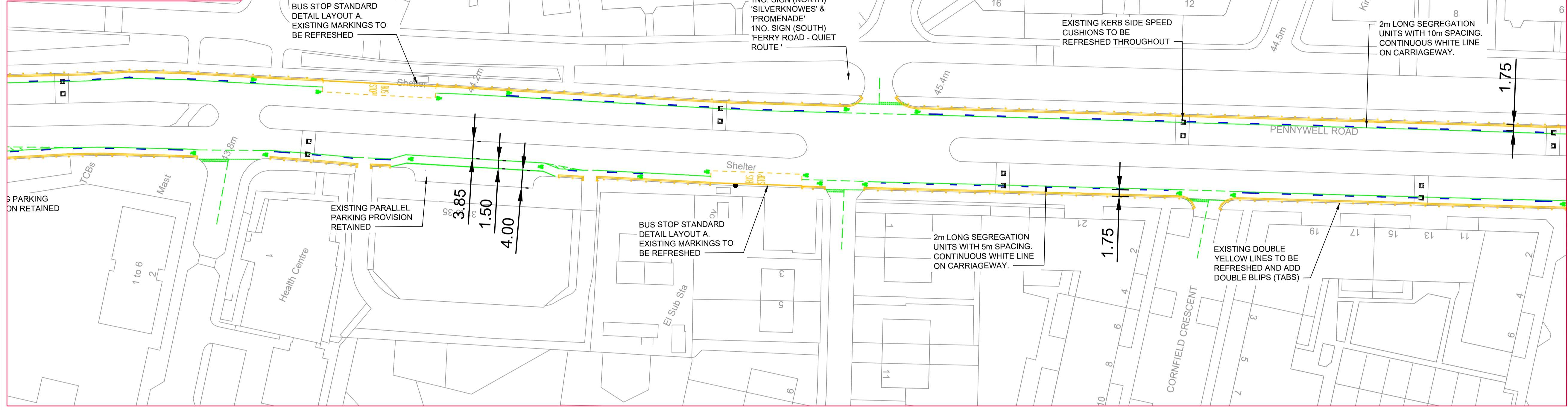

VIEWPORT 1

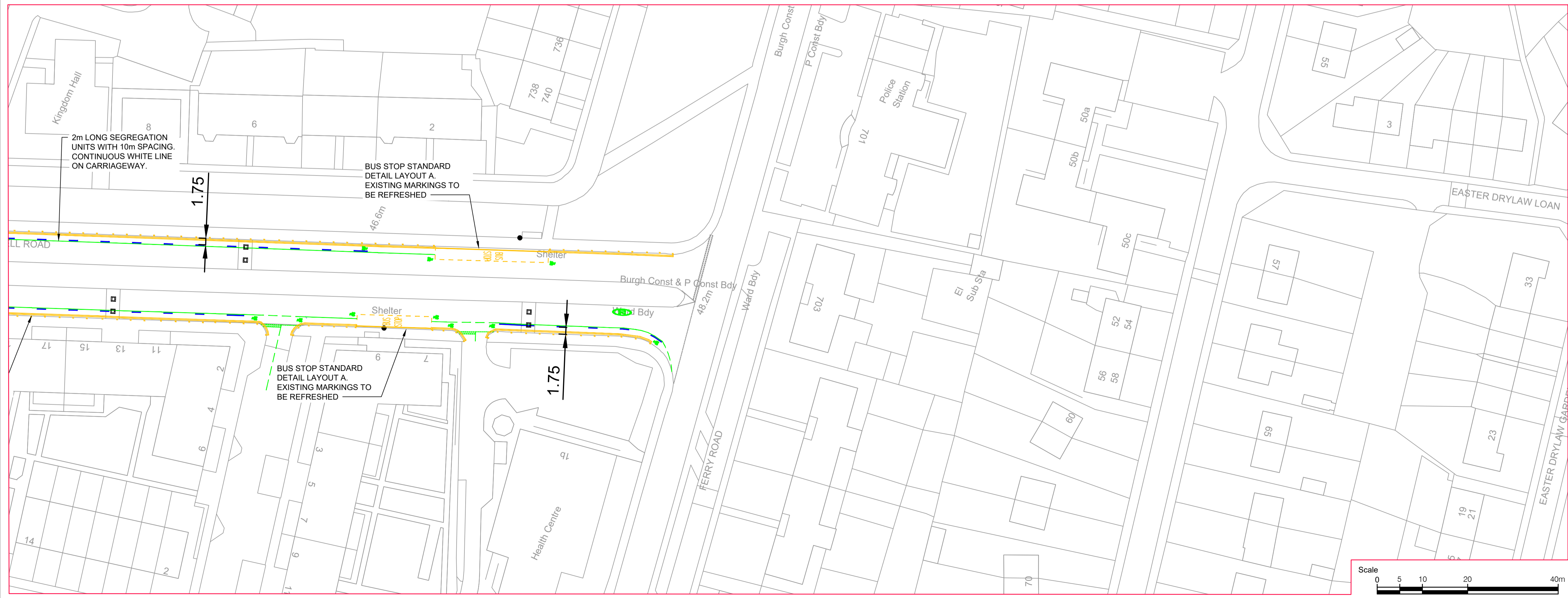

VIEWPORT 2

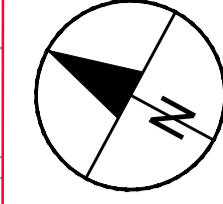

AECOM
 1 Tanfield
 EDINBURGH, EH3 5DA
 +44 (0) 131 301 8600 tel
 +44 (0) 131 301 8699 fax
 www.aecom.com

1. ALL WORKS TO BE EXECUTED IN ACCORDANCE WITH THE SPECIFICATION FOR HIGHWAY WORKS - THE MANUAL OF CONTRACT DOCUMENTS FOR HIGHWAY WORKS, DESIGN MANUAL FOR ROADS AND BRIDGES, TRAFFIC SIGNS MANUAL AND LOCAL COUNCIL GUIDELINES.
2. ALL DIMENSIONS ARE IN METRES UNLESS STATED OTHERWISE. ALL LEVELS ARE IN METRES AND RELATE TO ORDNANCE DATUM.
3. DO NOT SCALE FROM ANY DRAWING. WORK TO FIGURED DIMENSIONS ONLY. ANY DISCREPANCIES IN DIMENSION ARE TO BE REFERRED TO THE DESIGNER BEFORE WORK IS PUT TO HAND.
4. ALL DIMENSIONS AND LEVELS ARE TO BE CHECKED ON SITE BY THE CONTRACTOR PRIOR TO PREPARING ANY WORKING DRAWINGS OR COMMENCING ON SITE.
5. ALL WORKS BY THE CONTRACTOR MUST BE CARRIED OUT IN SUCH A WAY THAT ALL REQUIREMENTS UNDER THE HEALTH AND SAFETY AT WORK ACT ARE SATISFIED.
6. ALL WORK IS TO BE CARRIED OUT IN COMPLIANCE WITH THE REQUIREMENTS OF THE STATUTORY AUTHORITIES AND CONSTRUCTION DESIGN AND MANAGEMENT REGULATIONS.
7. DRAWING BASE RECEIVED FROM OTHERS. SURVEY CARRIED OUT BY OTHERS. AECOM CANNOT GUARANTEE THEIR ACCURACY. CONTRACTOR TO SATISFY THEMSELVES AS TO THE ACCURACY OF SUCH INFORMATION.
8. EXISTING DOUBLE YELLOW LINES TO BE REFRESHED AND ADD DOUBLE BLIPS (TABS). ALL ZIG-ZAGS, HATCHINGS AND OUTLINES OF ADVANCED STOP BOXES TO BE REFRESHED.

I/R	DATE	DESCRIPTION
1.2	11/09/2020	REVISED - SITE WALKOVER
1.1	09/09/2020	REVISED ROAD MARKINGS
1.0	04/09/2020	ISSUED FOR TENDER

60636731

SPACES FOR PEOPLE
 PENNYWELL ROAD
 SHEET 2 OF 2

60636731-SHT-C-SP-PR-0702

This drawing has been prepared for the use of AECOM's client. It may not be used, modified, reproduced or relied upon by third parties, except as agreed by AECOM or as required by law. AECOM accepts no responsibility, and denies any liability, whatsoever, to any party that uses or relies on this drawing without AECOM's express written consent. All measurements must be obtained from the stated dimensions.