

VIEW 7

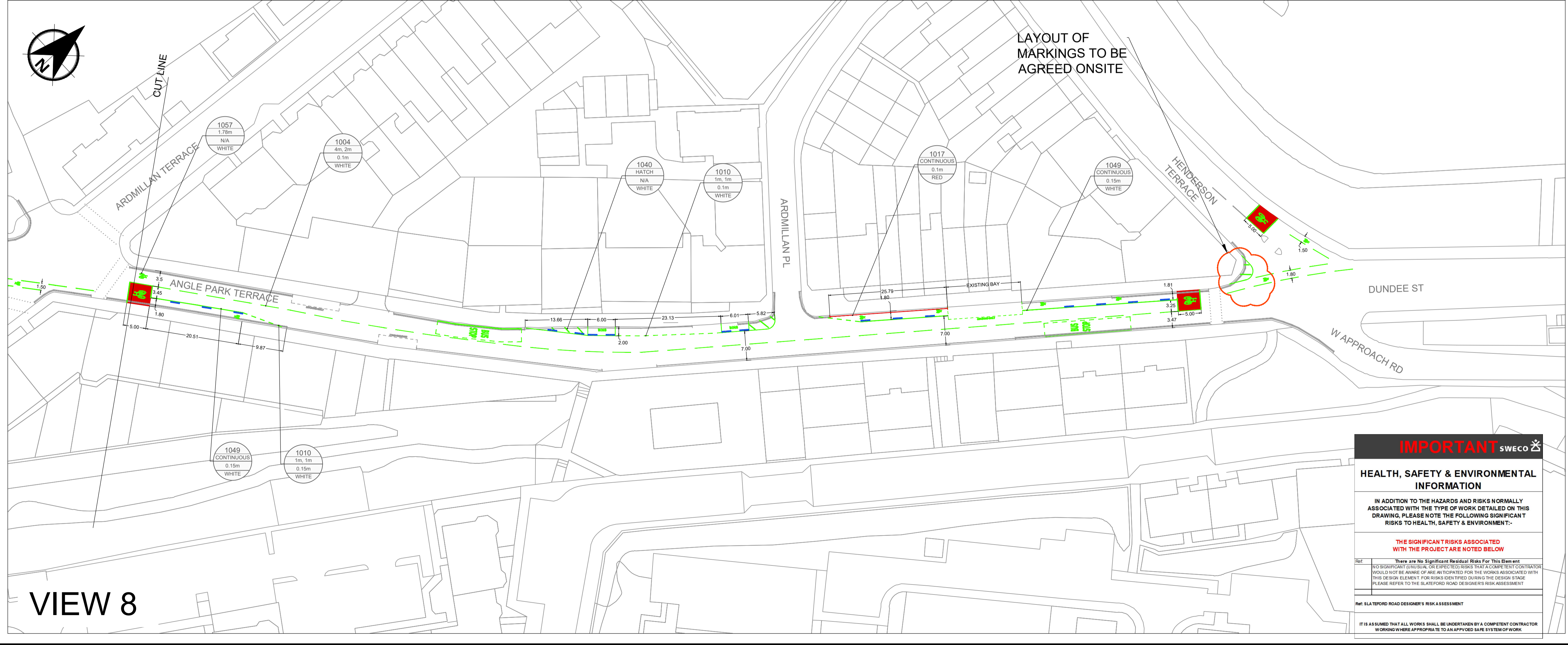

VIEW 8

NOTES

1. ALL DIMENSIONS ARE IN METRES UNLESS OTHERWISE STATED.
2. THIS DRAWING CONTAINS DATA BASED UPON ORDINANCE SURVEY MAPPING, REPRODUCED BY PERMISSION OF ORDINANCE SURVEY ON BEHALF OF HMSO. CROWN COPYRIGHT AND DATABASE RIGHT 2020. ALL RIGHTS RESERVED. 100023420 (2019)
3. THIS DRAWING IS TO BE READ IN CONJUNCTION WITH ALL RELEVANT DOCUMENTS.
4. TSRGD REFERS TO TRAFFIC SIGNS REGULATIONS AND GENERAL DIRECTIONS 2016.

KEY

- TSRGD DIA. NUMBER
- LINE AND GAP
- THICKNESS
- COLOUR
- PROPOSED TRAFFIC SIGN
- DL = DOUBLE SIGN (BACK TO BACK)
- MOUNTED ON EXISTING LIGHTING COLUMN
- SE = SINGLE SIGN MOUNTED ON EXISTING POLE
- SP = SINGLE SIGN MOUNTED ON NEW POLE
- ALL MARKINGS IN RED&GREEN ARE PROPOSED
- CYCLE LANE DEFENDER UNITS WITH W/MAIN

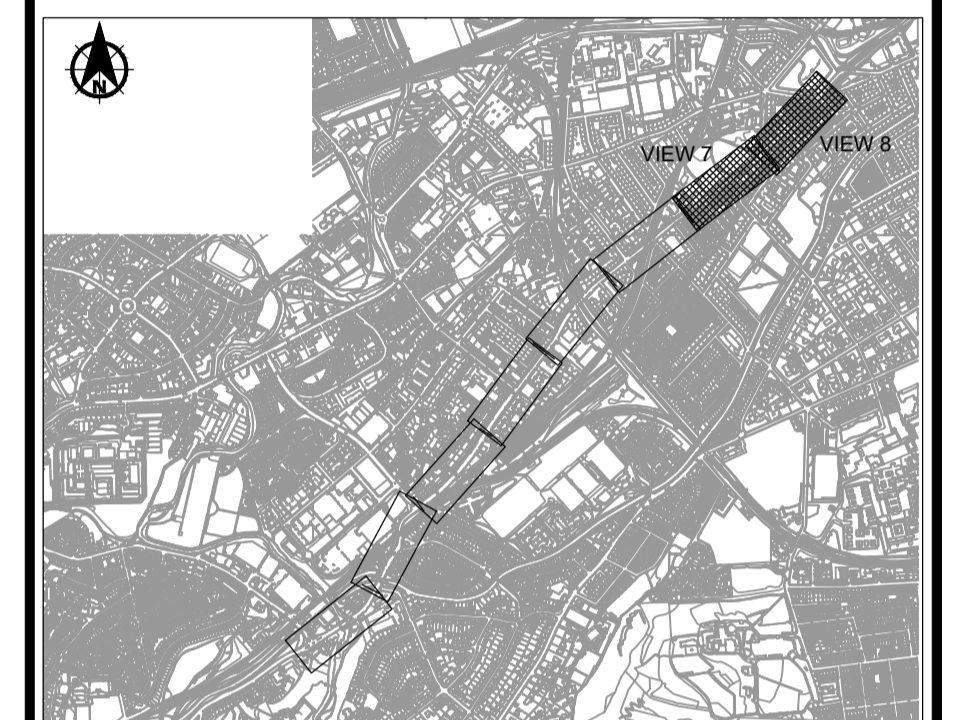

Rev.	Date	Amendment Details	Drawn	Chk'd	App'd

This drawing should not be relied on or used in circumstances other than those for which it was originally prepared and for which Sweco UK Limited was commissioned. Sweco UK Limited accepts no responsibility for this drawing to any party other than the person by whom it was commissioned. Any party which breaches the provisions of this disclaimer shall indemnify Sweco UK Limited for all loss or damage arising therefrom.

Sweco
2nd Floor, Quay 2
139 Fountainbridge
Edinburgh
EH3 9QG
Tel: +44 (0)131 550 6300
Web: www.sweco.co.uk



Client
EDINBURGH
THE CITY OF EDINBURGH COUNCIL

Drawing Status
FOR CONSTRUCTION

Project Title
**SPACES FOR PEOPLE
SLATEFORD ROAD**

Drawing Title
**1200 SIGN & ROAD MARKING
LAYOUT
SHEET 04 OF 04**

Scale	Designed	Drawn	Checked	Approved
Original Size	Date	Date	Date	Date
1:500	AMcN	AMcN	CF	CF
A1	17.03.21	17.03.21	02.04.21	02.04.21
Drawing Number	65201810-SWE-SLT-1204			Revision 0

IMPORTANT sweco

HEALTH, SAFETY & ENVIRONMENTAL INFORMATION

IN ADDITION TO THE HAZARDS AND RISKS NORMALLY ASSOCIATED WITH THE TYPE OF WORK DETAILED ON THIS DRAWING, PLEASE NOTE THE FOLLOWING SIGNIFICANT RISKS TO HEALTH, SAFETY & ENVIRONMENT:-

THE SIGNIFICANT RISKS ASSOCIATED WITH THE PROJECT ARE NOTED BELOW

There are No Significant Residual Risks For This Element
RESIDUAL CRITICAL OR EXPECTED RISKS THAT ACCOMPANY CONSTRUCTION WOULD NOT BE AWARE OF ARE NOTICATED FOR THE WORKS ASSOCIATED WITH THIS DESIGN ELEMENT FOR RISKS IDENTIFIED DURING THE DESIGN STAGE PLEASE REFER TO THE SLATEFORD ROAD DESIGNER'S RISK ASSESSMENT

REF: SLATEFORD ROAD DESIGNER'S RISK ASSESSMENT

IT IS ASSUMED THAT ALL WORKS SHALL BE UNDERTAKEN BY A COMPETENT CONTRACTOR WORKING WHERE APPROPRIATE TO AN APPROVED SAFE SYSTEM OF WORK