



LOCAL PLACE PLANS

HOW-TO GUIDE

WHY?

WHY DO A LOCAL PLACE PLAN?

Local Place Plans are a new way to plan what you care about.

You can

- **tell us about your place. What is good. What is bad.**
- **share your community's needs and aspirations.**
- **influence City Plan 2040 and how your area develops in the future.**

Every community in Edinburgh is different. Producing a Local Place Plan gives you a chance to shape the future of your place by creating a plan that addresses local needs or concerns. It puts you in control as we are required to recognise Local Place Plans when preparing the next local development plan. This decides where future development will happen.

WHAT COULD YOU GET FROM A LOCAL PLACE PLAN FOR YOUR NEIGHBOURHOOD?

This is the chance to design and plan your area in more detail. You can shape future housing, business, or community spaces, bring forward proposals to improve quality of life, health and well-being and protect what you value such as buildings and green space.

WHO?

WHO PREPARES A LOCAL PLACE PLAN?

Local Place Plans work best when you work together and team up with different groups in your area. These could be:

- a Community Council
- a Community Development Trust
- a charity or group of charities relating to a particular part of Edinburgh
- children and youth groups, local schools
- major local organisations, groups or businesses

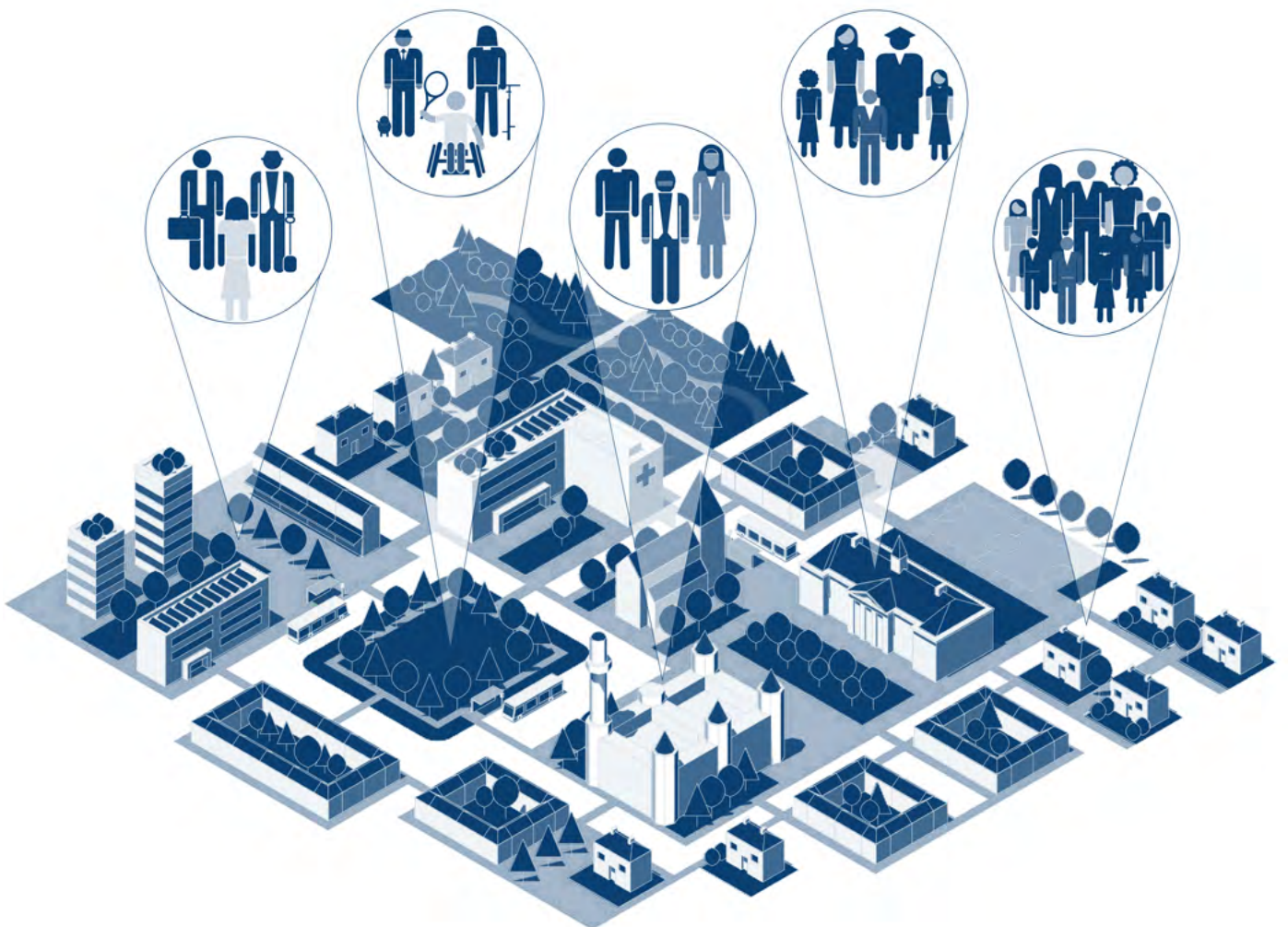

WHERE?

WHERE SHOULD A LOCAL PLACE PLAN COVER?

A Local Place Plan needs to relate to a specific area, but it can be any size. It can cover a whole district, a neighbourhood, or a single plot of land. It is up to you what you cover. This does not need to be clearly defined in the beginning. It can evolve during the process.

A good Local Place Plan has information on what life in your area is like and who lives there. You can find online sources of information for this.

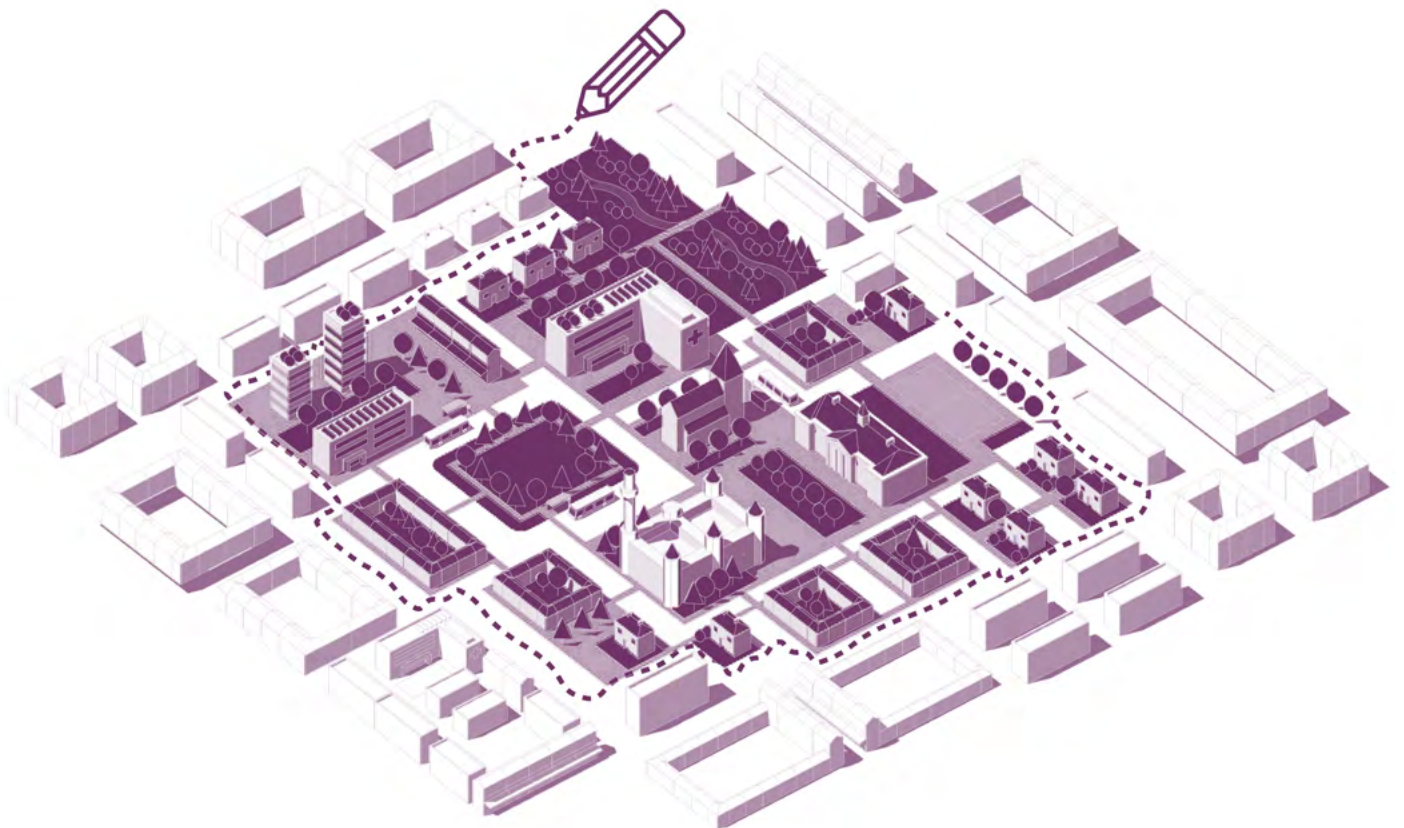

HOW DO I MAP AND UNDERSTAND MY AREA?

Try the following maps:

- [City of Edinburgh Community Council Maps](#)
- [City of Edinburgh Council Data Atlas](#)
- [Parish Online Community Map Scotland](#)
- [City of Edinburgh 20-minute neighbourhood mapping tool](#)
- [National Library of Scotland historic map layers](#)
- [Scottish Index of Multiple Deprivation maps](#)
- [Datashine Scotland Census Mapping](#)



WHAT?

WHAT IS IN A LOCAL PLACE PLAN?

What is important to you? A Local Place Plan can cover many different topics. When you reach out to your community you will find out which are most important.

It could include things like ideas for new buildings and homes in certain areas, improvements to how you get around, additional spaces for playing, sports or growing food or proposals to reuse important buildings.

A Local Place Plan does not need to include all these topics but here are some of the issues that might interest your community:

- Different types of housing
- Services such as healthcare, schools/nurseries, shops, community spaces
- Places of work
- Natural environment
- Historic buildings and features
- Play and sports facilities
- Moving around the area
- Connections to the rest of Edinburgh and beyond

WHAT QUESTIONS CAN YOU ASK THE COMMUNITY?

- What do you want to change in your place?
- What do you want to protect?
- What do you feel is important to people in your community?
- What do people feel is missing?
- Where does your community body have an interest?
- Is there a planning policy you would like to influence?



HOW?

HOW WILL YOU REACH OUT TO YOUR COMMUNITY?

It's important that you reach out to all the community and find out what they think. The best plans include as many voices as possible.

There are many ways you can do this, such as:

- Surveys / questionnaires
- Drop-in or pop-up events
- Exhibitions
- Attending local events planned for your area
- Talking to young people through the schools or youth organisations.

WHAT CAN I USE TO REACH OUT TO THE COMMUNITY?

Try these accessible tools and advice sources:

- [Place Standard Tool \(including climate and young people's versions\)](#)
- [Planning Aid Scotland community engagement advice and training](#)



GETTING STARTED

WHAT WILL YOUR LOCAL PLAN LOOK LIKE?

Your Local Place Plan can be as simple as you want.

There is no right or wrong way to develop each plan, as it will depend on the resources you have available. But it must include:

- a map that shows the land to which the plan relates
- a statement of the proposal for the use or development of land within the plan area.

The plan can be a very simple and short document and does not need to be complicated or professionally designed. A word document and a map can be enough.

[We have a template that you can use on our Local Place Plans web page.](#)

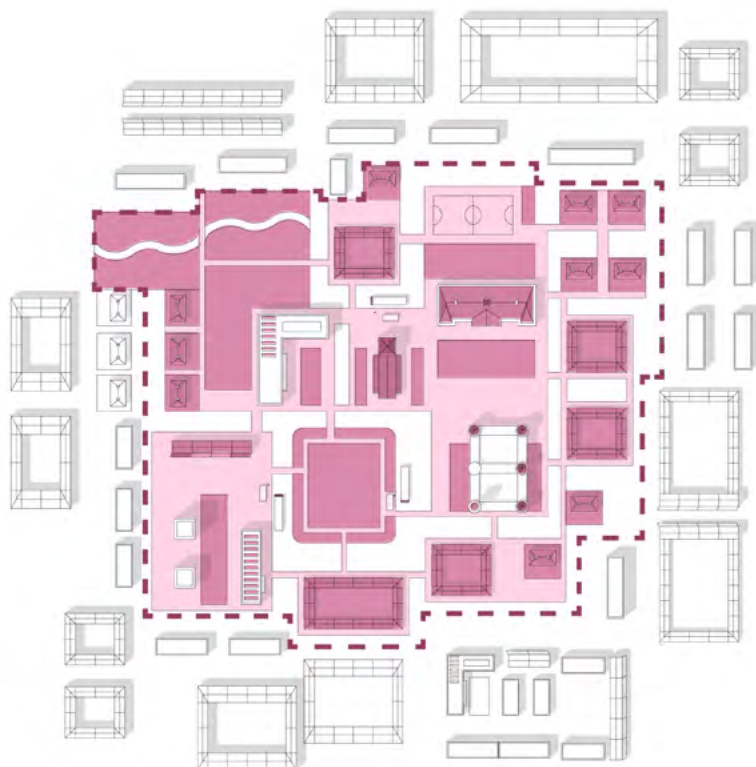

HOW CAN WE HELP YOU GET STARTED?

To find out more, fill out our online form on our [Local Place Plans web page](#).

We can provide further information or arrange to talk in person with your organisation to help you think about a Local Place Plan for your community.

