

ALL CLASS ONE OPERATIVES ENGAGED IN TEMPORARY TRAFFIC MANAGEMENT OPERATIONS ARE LANTRA APPROVED AND ACCREDITED TO SECTOR SCHEME 12

CHAPTER 8 T.S.M DETAILS

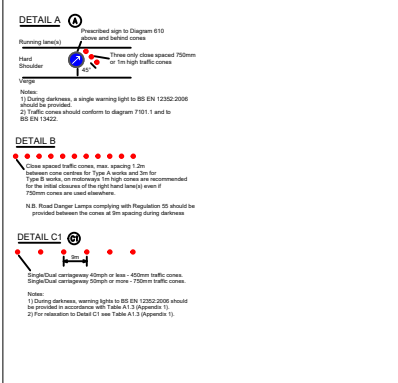

DRAWING DETAILS

- SIGN
- SECONDARY FENCING
- CONES OR MASS BARRIER
- ← DIRECTION OF TRAFFIC
- PROPOSED LINING ARRANGEMENT
- PEDESTRAIN SIGNALISED CROSSING
- TRAFFIC LIGHT HEAD
- PEDESTRIAN LIGHT HEAD
- TRAFFIC LIGHT HEAD BASE AND DIRECTION
- PEDESTRIAN AND CYCLEWAY SHARED
- A1
- A2
- A3

NOTES :-

DRAWING STATUS : ISSUED FOR CONSTRUCTION

Date	Revision	Rev by	App by
10/06/2020	COVID-19 MEASURES ADDED	JPS	SP
30/06/2020	ALTERATIONS TO WORKSITE	SP	SP
12/09/2020	ALTERATIONS TO RUNNING LANE	SP	SP
18/09/2020	SITE AND LINING ADJUSTMENTS	SP	SP



Drawn By : SP	Checked By : JC
Scale : N.T.S	Date : 10/10/2019
Main Contractor:	SFN
Location:	Ocean Terminal Main Works
Traffic Management Arrangement :	Ocean Terminal Phase 1 Works Area 1 + 1 Contraflow and New T-Junction Arrangement
Drawing No :	ETYN-SFN-14X-07-DR-002
Revision :	A B

