

Public Realm Design Requirements

- Links between bus stop and tramstop (Cycle parking+ Pedestrian links)
- Connection to Asda Leith Superstore
- Place making - fit to surroundings (new development and residential properties/Edinburgh Tram identity/corner plot)
- Public Art
- Materials (High quality paving/Seating facilities)
- Soft landscaping (Tree+Shrub+Long grass+grass)

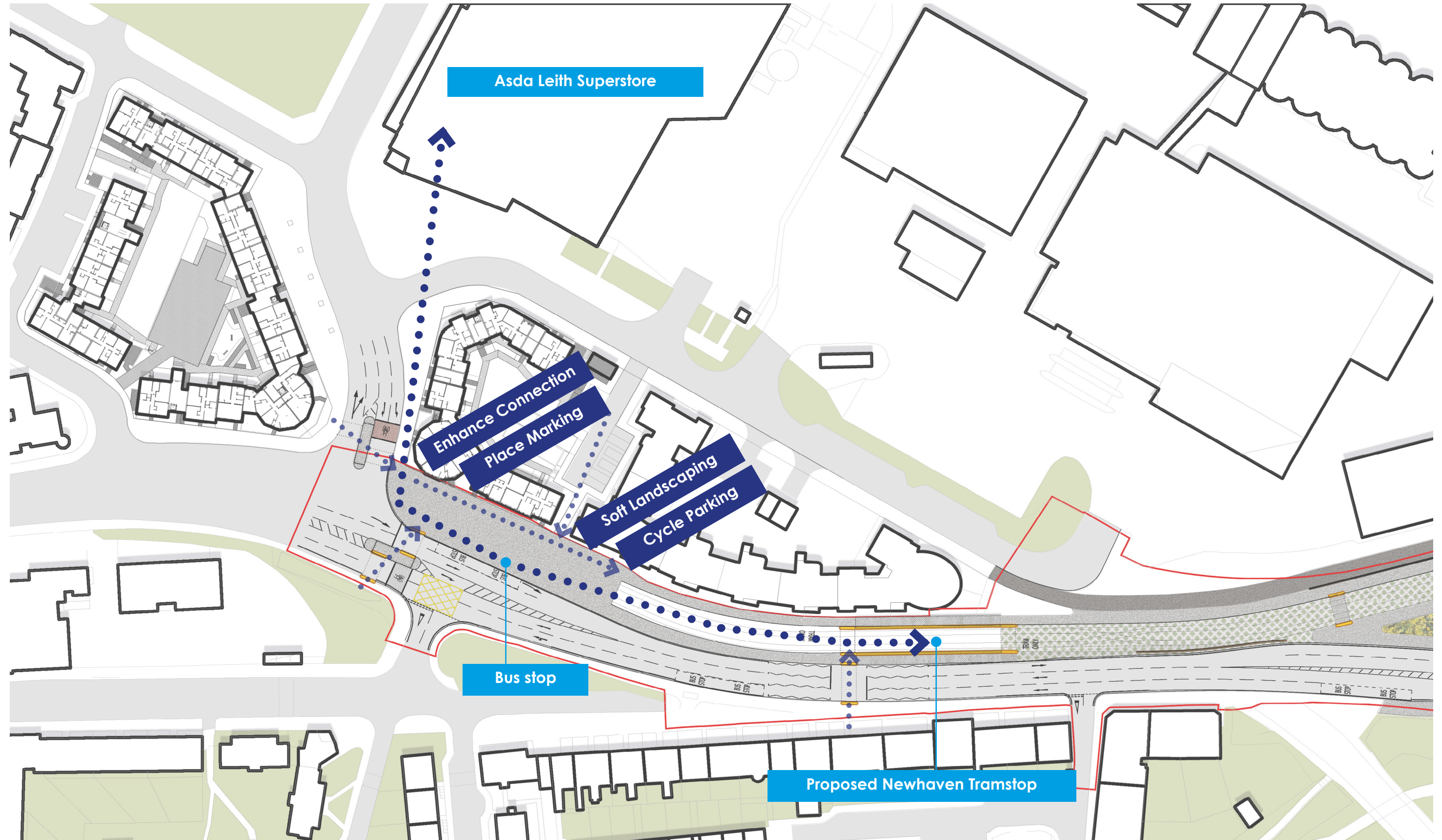

Design Concept

This option will create a gateway at this corner space and tell a story of a tram journey.

Design Inspiration



Spatial Arrangement and Functions

With the help of landscape elements, this site will be a semi-open public space.

Seating and grass planting are used in combination to create an informal relaxing space for people.

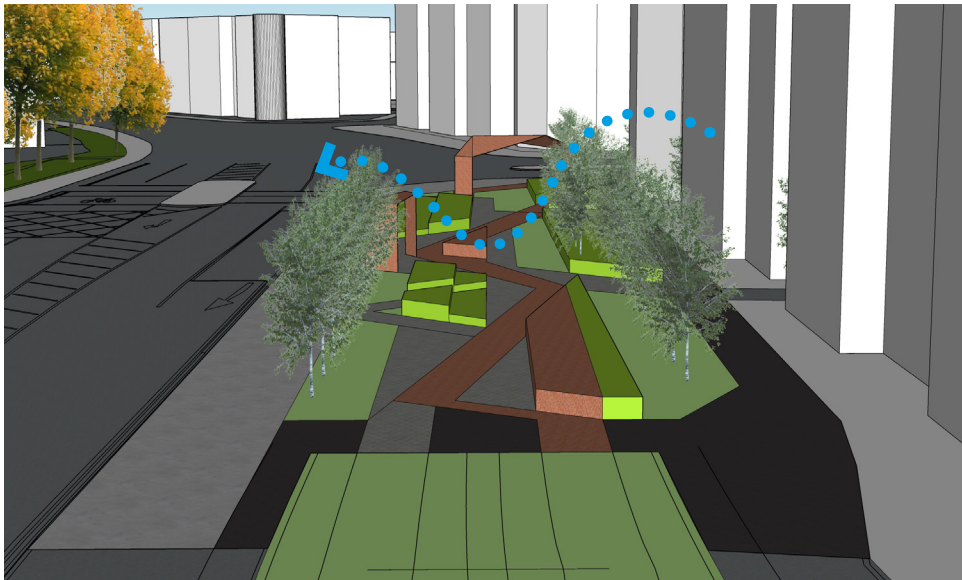

Design Functions / Links



- Private Area
- Semi-public Area
- Public Area
- - - Main Route
- - - Secondary Route
- - - Improved Permeability

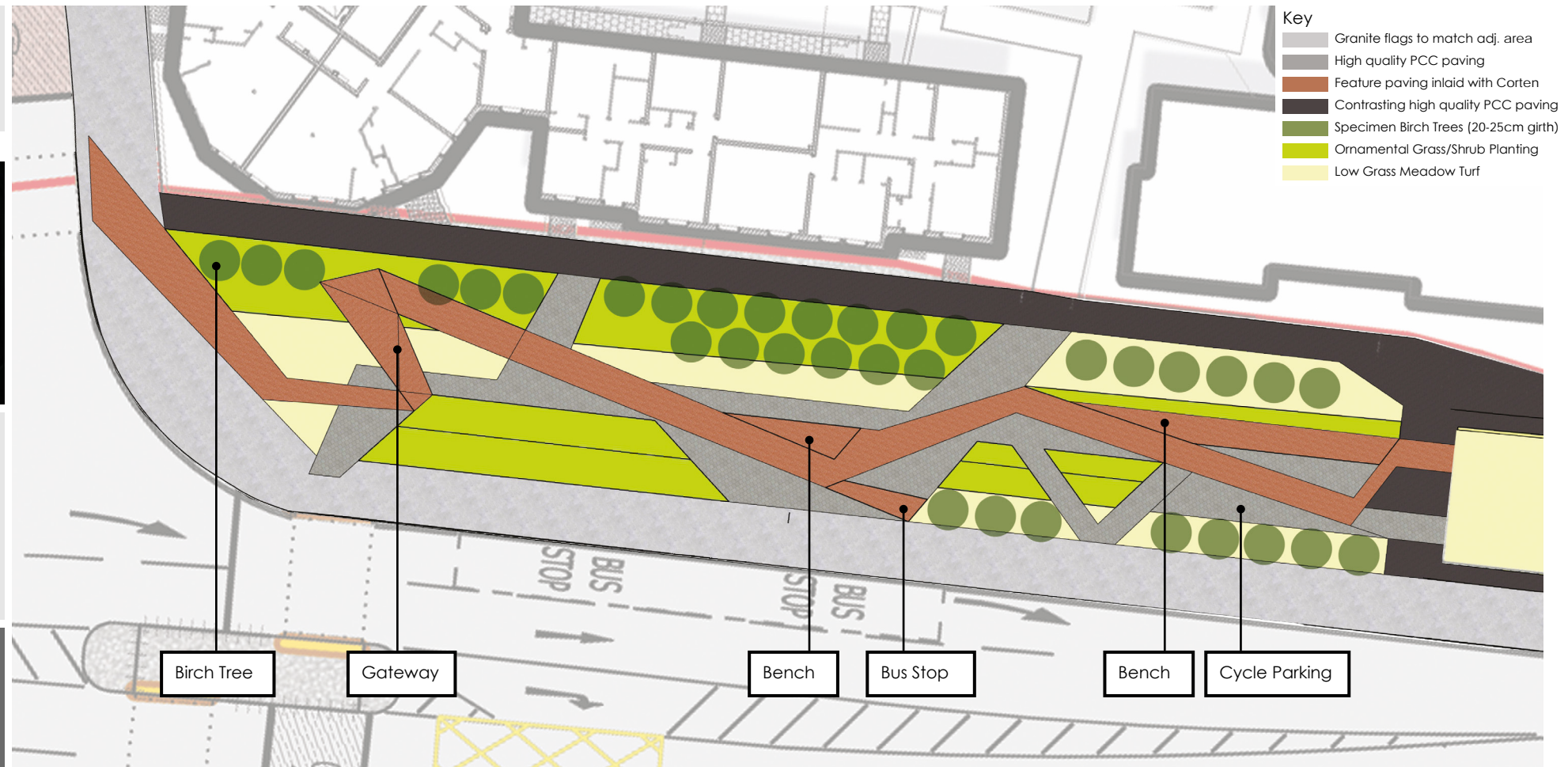

Design Features

An abstract gateway art feature will link seamlessly with the design layout, reflecting historic and future design references.

This 'red' feature will link all functions together.

Opportunity to include linear light features as part of paving design.

Gateway art feature will provide a variety of views depending on the viewpoint position, adding interest to the site.

Large or linear seating elements will reinforce the design layout and provides opportunities for rest within the space.

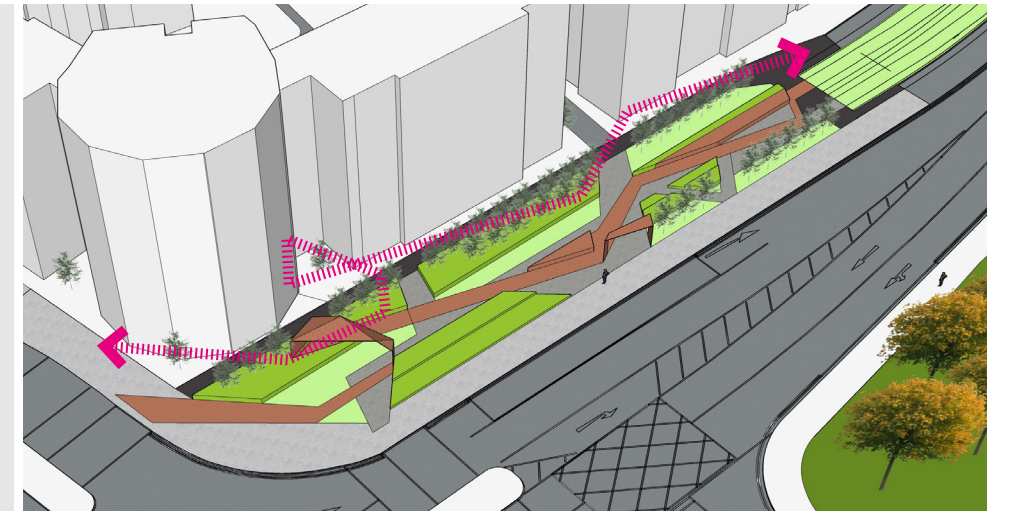

Precedent Images



Materials

The proposed paving materials will reflect existing materials found in the locality.

Linkages will be provided with the wider locality by using a consistent materials palette.

High proportion of soft landscape, finishes will help soften and provide context for adjacent development.

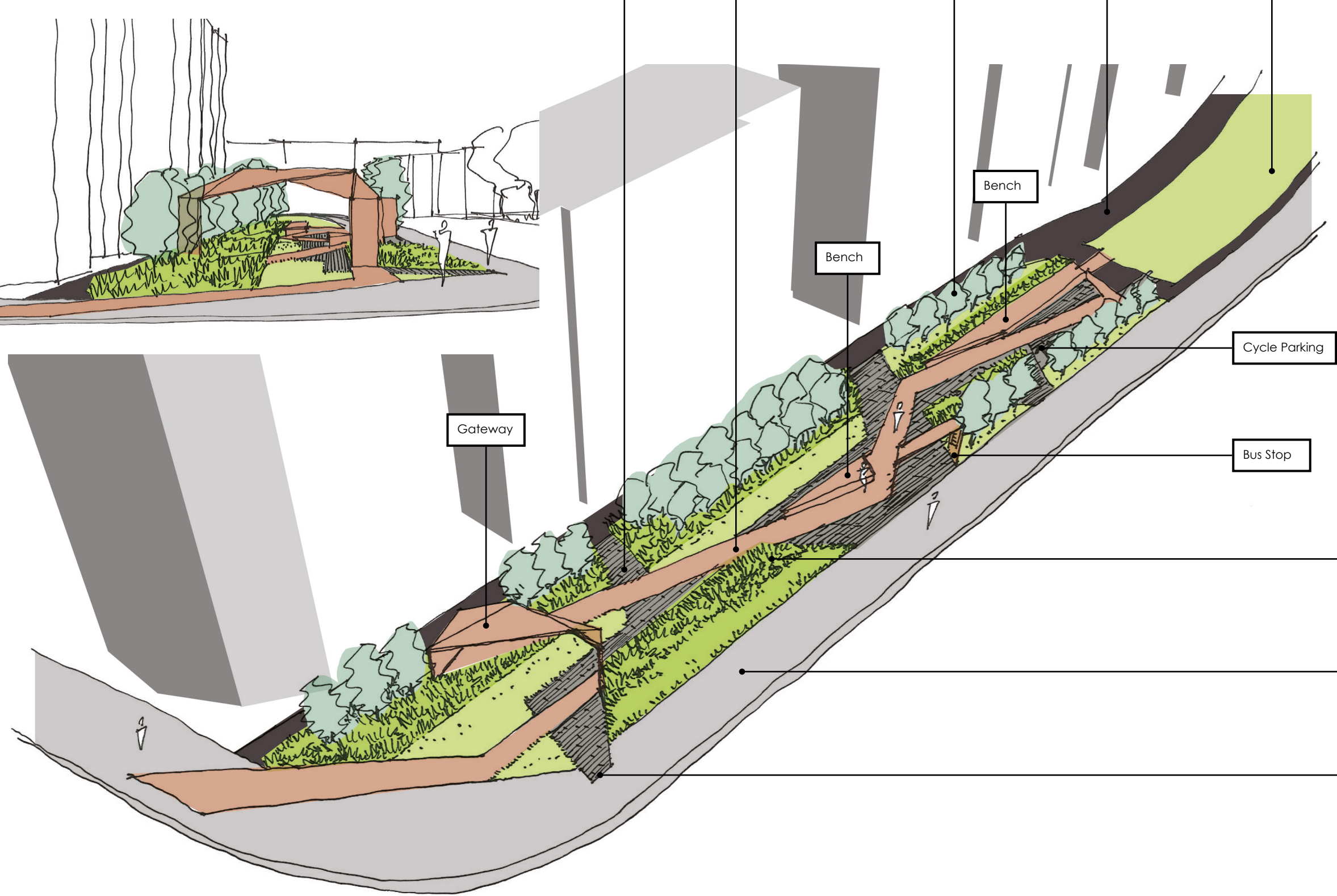
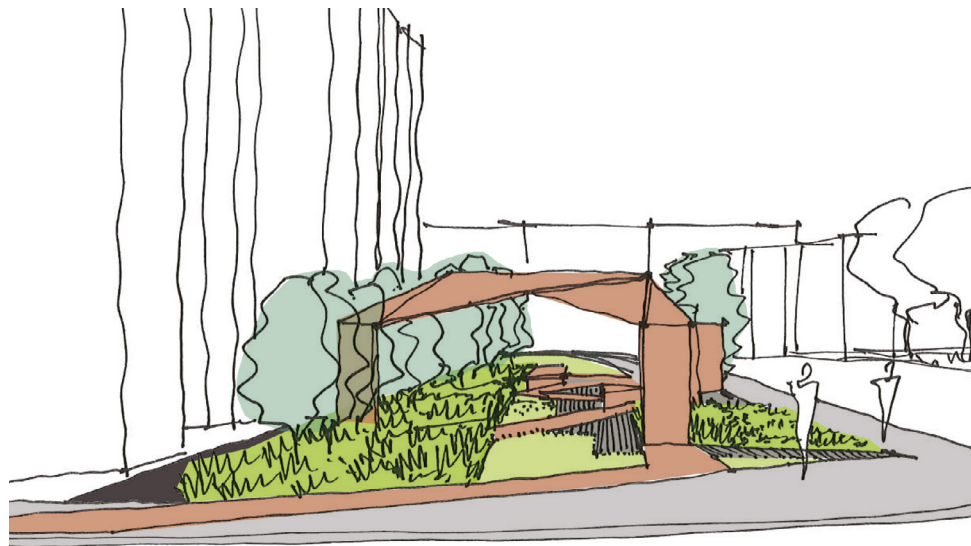

Ornamental Grass Planting



Consistent Materials Palette



Contrasting Paving (unit size/layout/colour)

