

Millimetres
0 10 100

DO NOT SCALE

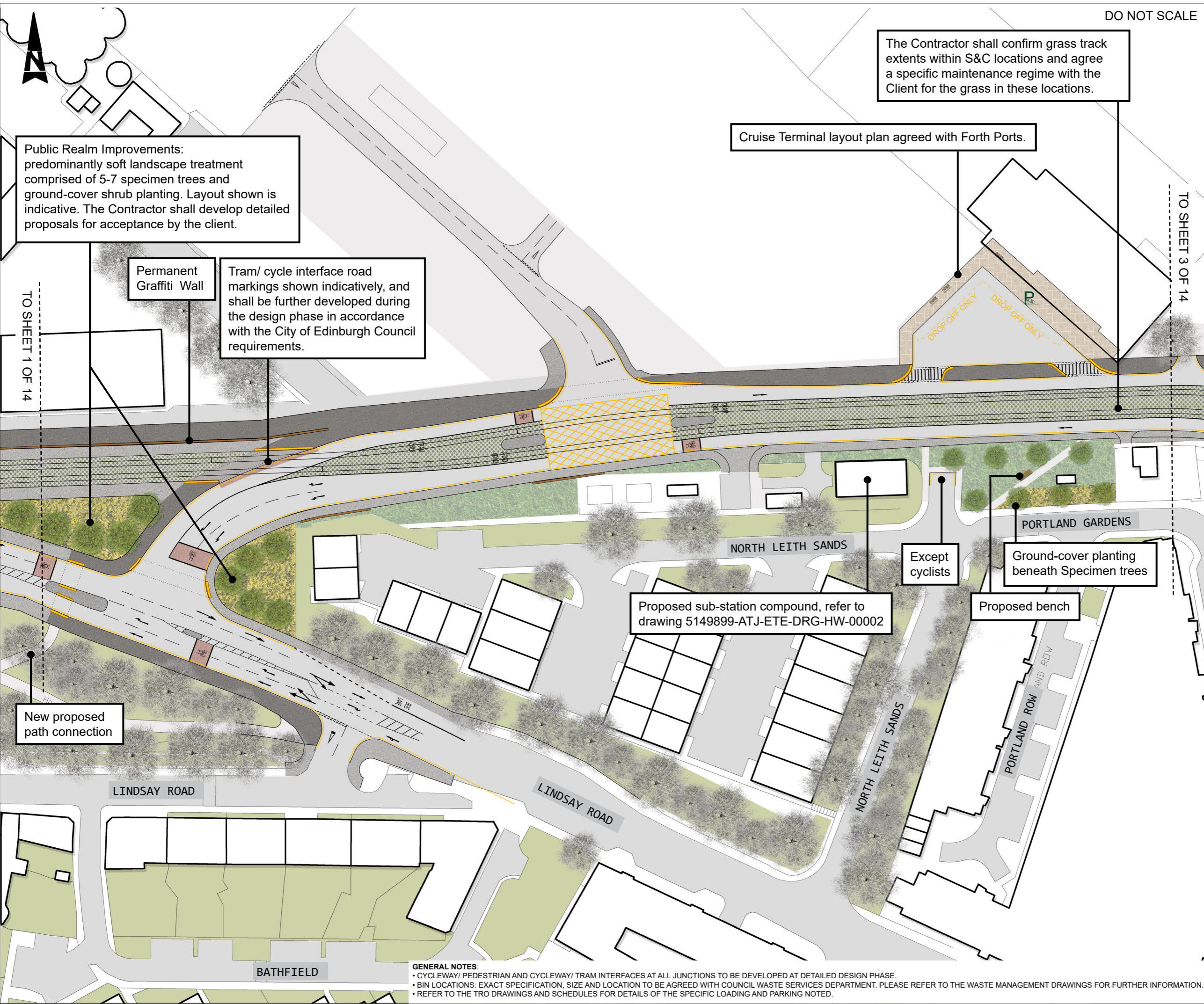

Public Realm Improvements: predominantly soft landscape treatment comprised of 5-7 specimen trees and ground-cover shrub planting. Layout shown is indicative. The Contractor shall develop detailed proposals for acceptance by the client.

Permanent Graffiti Wall

Tram/cycle interface road markings shown indicatively, and shall be further developed during the design phase in accordance with the City of Edinburgh Council requirements.

Cruise Terminal layout plan agreed with Forth Ports.

The Contractor shall confirm grass track extents within S&C locations and agree a specific maintenance regime with the Client for the grass in these locations.

TO SHEET 1 OF 14

TO SHEET 3 OF 14

KEY

- Pre-cast concrete paving
- Natural stone paving
- Asphalt footpath
- Raised Setts
- Cycle route
- Shared surface (Cycle route)
- Shared surface (pre-cast concrete paving)
- Shared surface (natural stone paving)
- Shared surface (asphalt footpath)
- Grasscrete or similar approved
- Proposed trees
- Existing trees
- Proposed grass
- Proposed ground-cover shrub planting
- Proposed raised planter
- Proposed/retained cycle racks (8no provided; indicative location)
- Tram/Cycle interface road markings (indicative)
- Tactile paving (Indicative)
- Existing/proposed walls
- Parking bays
- Loading bays
- Bin locations

P12	12/01/21	TWELFTH ISSUE	LL	SS	SB	SM
P11	18/09/20	ELEVENTH ISSUE	LL	SS	SB	SM
P10	05/08/20	TENTH ISSUE	LL	SS	SB	SM
P09	31/07/20	NINTH ISSUE	LL	SS	SB	SM
P08	16/06/20	EIGHTH ISSUE	LL	SS	SB	SM
P07	19/11/19	FORTH PORTS ACCESS UPDATE	LL	SS	SB	SM
P06	22/08/19	SIXTH ISSUE	LL	SS	SB	SM
P05	29/01/19	FIFTH ISSUE	RP	SB	SB	SM
P04	05/10/18	FOURTH ISSUE	RP	SB	SB	SM
P03	29/09/18	THIRD ISSUE	RP	SB	SB	SM
P02	14/03/18	SECOND ISSUE	SW	SB	SB	SM
P01	06/03/18	FIRST ISSUE	SW	SB	SB	SM
Rev.	Date	Description	Org	Chk'd	App'd	Aur'd

FOR INFORMATION S2

ATKINS
6th Floor
200 Broomielaw
Glasgow
Scotland
G1 4RU
Tel: +44 (0)141 220 2000
Fax: +44 (0)141 220 2001
www.atkinsglobal.com

Client
EDINBURGH
THE CITY OF EDINBURGH COUNCIL

Project Title
**EDINBURGH TRAM
YORK PLACE TO NEWHAVEN**

Drawing Title
**LANDSCAPE PROPOSALS
SHEET 2 OF 14**

Scale	Originalator	Checked	Approved	Authorised
1:500	LL	SS	SB	SM
Original Size	Date	Date	Date	Date
A1	12/01/21	12/01/21	12/01/21	12/01/21
Drawing Number	Revision			
5149899-ATK-ETE-DRG-EN-00002	P12			

GENERAL NOTES:
 • CYCLEWAY/ PEDESTRIAN AND CYCLEWAY/ TRAM INTERFACES AT ALL JUNCTIONS TO BE DEVELOPED AT DETAILED DESIGN PHASE.
 • BIN LOCATIONS: EXACT SPECIFICATION, SIZE AND LOCATION TO BE AGREED WITH COUNCIL WASTE SERVICES DEPARTMENT. PLEASE REFER TO THE WASTE MANAGEMENT DRAWINGS FOR FURTHER INFORMATION.
 • REFER TO THE TRO DRAWINGS AND SCHEDULES FOR DETAILS OF THE SPECIFIC LOADING AND PARKING NOTED.