

CHAPTER 8 T.S.M DETAILS

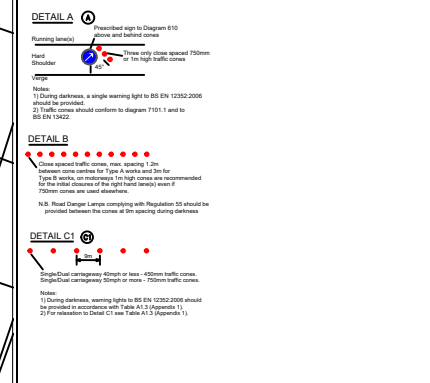

DRAWING DETAILS

- SIGN
- SECONDARY FENCE LINE
- CONES OR MASS BARRIER
- DIRECTION OF TRAFFIC
- CYCLE LANE DELINEATION
- PEDESTRAIN SIGNALISED CROSSING
- TRAFFIC LIGHT HEAD
- PEDESTRIAN LIGHT HEAD
- TRAFFIC LIGHT HEAD BASE AND DIRECTION
- PEDESTRIAN LIGHT HEAD BASE AND DIRECTION
- A1
- A2
- A3

NOTES :-
 MINIMUM FOOTPATH WIDTH OF 1.5M WILL BE MAINTAINED, IN LINE WITH CONSTRUCTION PHASING 2.0M WIDTH WHERE POSSIBLE

DRAWING STATUS : FOR REVIEW

REVISION: 5

Date	Revision	Rev. By	App. By
17-07-19	ORIGINAL SKETCH	JW	SP
25-07-19	ADDITION OF TEMPORARY SIGNALS	JW	SP
29-07-19	REVERSE ANNANDALE STREET	JW	SP
23-08-19	ADDITION OF TEMPORARY SIGNS	JW	SP
18-12-19	ADDED CYCLE LANE	CJH	SP
23-02-21	CYCLE LANE DIVERSION	SP	SP
24-02-21	ALTER FOOTPATH RESTRICTIONS	SP	SP

Class One Traffic Management Ltd.

www.classone.org
 mail@classone.org

Sacry · Farrans · Neopol

Drawn By : C Healey	Checked By : SP
Scale : N.T.S	Date : 17/07/19
Main Contractor : SFN	
Location : CH + 14134.35 London Road - CH + 15688.35 Manderson Street	
Traffic Management Arrangement : Leith Walk Phase 1 Works Area with Mandatory Closures and localised Movements	
Drawing No : EYIN-SFN-4XX-07-DR-002	
Revision : 5	

