

ALL CLASS ONE OPERATIVES ENGAGED IN TEMPORARY TRAFFIC MANAGEMENT OPERATIONS ARE LANTRA APPROVED AND ACCREDITED TO SECTOR SCHEME 12

CHAPTER 8 T.S.M DETAILS

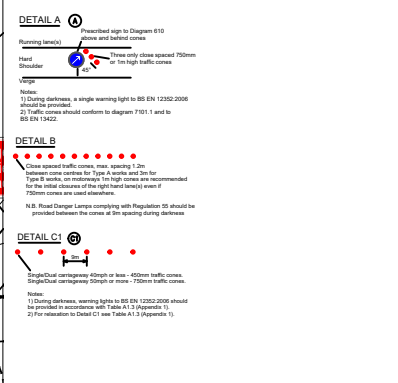

DRAWING DETAILS

- SIGN**
- CONES OR MASS BARRIER
 - DIRECTION OF TRAFFIC
 - WORKS ACCESS/ EGRESS
 - PEDESTRIAN SIGNALISED CROSSING
 - TRAFFIC LIGHT HEAD
 - PEDESTRIAN LIGHT HEAD
 - TRAFFIC LIGHT HEAD BASE AND DIRECTION
 - PEDESTRIAN LIGHT HEAD BASE AND DIRECTION
- N.B.
 Cycling information signs will be in place to divert active travel users at each junction.

NOTES :-

DRAWING STATUS : ISSUED FOR CONSTRUCTION
REVISION: 9

Date	Revision	Rev by	App by
23-07-19	ORIGINAL SKETCH	JW	JW
26-07-19	CHANGE OF LAYOUT	JW	SP
20-08-19	DESIGN COMPLETE FOR APPROVAL	SP	SP
21-08-19	REVISED FOR SFN COMMENTS	SP	SP
23-08-19	REVISED FOR CEC COMMENTS	SP	SP
26-08-19	REVISED FOR CEC COMMENTS	SP	SP
09-09-19	REVISED FOR SFN COMMENTS	SP	SP
21-12-20	REVISED WORKSITE	SP	SP
01-02-21	REVISED WORKSITE	SP	SP
18-03-21	REVISED WORKSITE	SP	SP

Class One Traffic Management Ltd.

SFN
 Sacyr - Farrans - Neopol

Drawn By : SP	Checked By : JC
Scale : N.T.S	Date : 19/11/2019
Main Contractor: SFN	
Location: CH + 18103.35 Melrose - CH + 18478.35 Newhaven	
Traffic Management Arrangement : Newhaven to Melrose Drive Phase 1 Works Area with Mandatory Closures and localised Movements	
Drawing No : ETYN-SFN-17X-07-DR-07-0002 PHASE 1A	
Revision: 2 3 4 5 6 7 8 9	A0

