

100
0 10
Millimetres

DO NOT SCALE

- NOTES:
1. TOPOGRAPHICAL SURVEY PROVIDED BY THE CITY OF EDINBURGH COUNCIL DATED MARCH 2018, SUPPLEMENTED BY HISTORICAL OS TILES.
 2. THE TRO DRAWINGS ARE REPRESENTATIVE OF THE TRAFFIC ORDERS ONLY.
 3. THE TRO DRAWINGS SHOULD BE READ IN CONJUNCTION WITH THE APPLICABLE TRO SCHEDULES.
 4. MEASURES INDICATED ON THESE PLANS AS BEING OUT WITH THIS TRAFFIC ORDER ARE INDICATIVE ONLY AND WILL BE DEVELOPED SEPARATELY BY THE CITY OF EDINBURGH COUNCIL.

KEY

GENERAL

- BIN STORES
- TAXI RANK
- PEDESTRIAN PRIORITY CROSSINGS
- PROPOSED KERB LINE

MEASURES INCLUDED IN THIS TRAFFIC ORDER
NO WAITING AT ANY TIME / NO STOPPING AT ANY TIME / NO LOADING AT ANY TIME

- NO WAITING / NO LOADING AT TIMES SHOWN IN SCHEDULES
- PARKING BAYS AT TIMES SHOWN IN SCHEDULES
- LOADING BAYS AT TIMES SHOWN IN SCHEDULES
- LIMITED WAITING MON-SAT 7:30AM-6:30PM 4 HOURS, NO RETURN WITHIN 2 HOURS

MEASURES NOT INCLUDED IN THIS TRAFFIC ORDER

- PARKING BAYS (SEE NOTE 4 ABOVE)
- LOADING BAYS (SEE NOTE 4 ABOVE)
- DISABLED BAYS (SEE NOTE 4 ABOVE)



CONTINUED ON SHEET 2

Rev.	Date	Description	Org	Chk'd	App'd	Aur'd	
P06	19/11/18	FOR REVIEW AND COMMENT		GK	JR	KC	SL
P07	12/02/19	FOR REVIEW AND COMMENT		SM	SM	SM	SM
P08	30/04/19	FOR REVIEW AND COMMENT		CC	JR	KC	SM
P09	22/08/19	FOR REVIEW AND COMMENT		MG	SS	SS	SS
P10	12/06/20	FOR REVIEW AND COMMENT		MG	KA	SM	AG
P11	22/06/20	TRO FINALISED FOR ISSUE		MG	KA	SM	AG
P12	16/07/20	TRO FINALISED FOR ISSUE		EG	SS	SM	AG
P13	31/07/20	TRO FINALISED FOR ISSUE		MK	SS	KA	KA
P14	09/09/20	KEY UPDATED		DC	AG	AG	KA
P15	10/09/20	KEY UPDATED		DC	KA	SS	AG
P16	14/09/20	KEY UPDATED		DC	SS	SM	AG
P17	17/12/20	NOTES & KEY		DC	KA	KA	KA

Drawing Status: FOR INFORMATION Suitability: S2

ATKINS
6th Floor
200 Broomielaw
Glasgow
Scotland
G1 4RU
Tel: +44 (0)141 220 2000
Fax: +44 (0)141 220 2001
www.atkinsglobal.com

Copyright © Atkins Limited (2013)

EDINBURGH
THE CITY OF EDINBURGH COUNCIL

Project Title: EDINBURGH TRAM YORK PLACE TO NEWHAVEN

Drawing Title: PROPOSED TRAFFIC REGULATION ORDERS SHEET 1 OF 14

Scale	Originator	Checked	Approved	Authorised
1:500	DC	KA	KA	KA
Original Size	Date	Date	Date	Date
A1	17/12/20	17/12/20	17/12/20	17/12/20
Drawing Number				Revision
5149899-ATK-ETE-DRG-HW-00001				P17

Proposed layout
1:500

100
0 10
Millimetres

DO NOT SCALE

- NOTES:
1. TOPOGRAPHICAL SURVEY PROVIDED BY THE CITY OF EDINBURGH COUNCIL DATED MARCH 2018, SUPPLEMENTED BY HISTORICAL OS TILES.
 2. THE TRO DRAWINGS ARE REPRESENTATIVE OF THE TRAFFIC ORDERS ONLY.
 3. THE TRO DRAWINGS SHOULD BE READ IN CONJUNCTION WITH THE APPLICABLE TRO SCHEDULES.
 4. MEASURES INDICATED ON THESE PLANS AS BEING OUT WITH THIS TRAFFIC ORDER ARE INDICATIVE ONLY AND WILL BE DEVELOPED SEPARATELY BY THE CITY OF EDINBURGH COUNCIL.

- KEY
- GENERAL
- BIN STORES
 - TAXI RANK
 - PEDESTRIAN PRIORITY CROSSINGS
 - PROPOSED KERB LINE
- MEASURES INCLUDED IN THIS TRAFFIC ORDER
- NO WAITING AT ANY TIME / NO STOPPING AT ANY TIME / NO LOADING AT ANY TIME
 - NO WAITING / NO LOADING AT TIMES SHOWN IN SCHEDULES
 - PARKING BAYS AT TIMES SHOWN IN SCHEDULES
 - LOADING BAYS AT TIMES SHOWN IN SCHEDULES
 - LIMITED WAITING MON-SAT 7:30AM-6:30PM 4 HOURS, NO RETURN WITHIN 2 HOURS
- MEASURES NOT INCLUDED IN THIS TRAFFIC ORDER
- PARKING BAYS (SEE NOTE 4 ABOVE)
 - LOADING BAYS (SEE NOTE 4 ABOVE)
 - DISABLED BAYS (SEE NOTE 4 ABOVE)

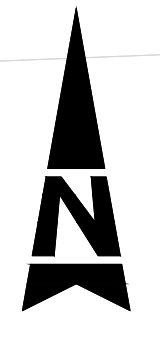
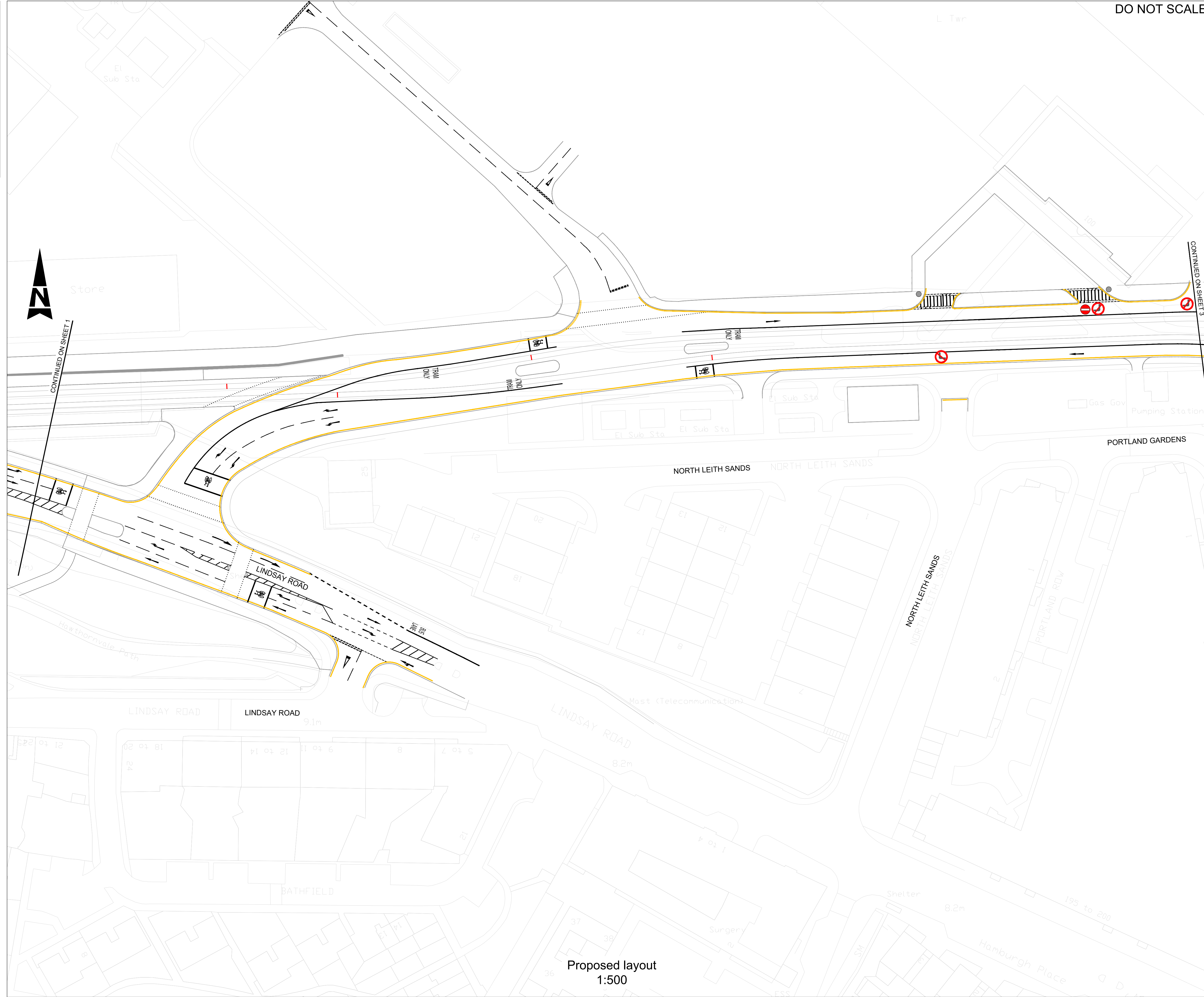

Proposed layout
1:500

Rev.	Date	Description	Org	Chk'd	App'd	Aur'd
P08	30/04/19	FIRST ISSUE	CC	JR	KC	SM
P09	22/08/19	FIRST ISSUE	MG	SS	SS	SS
P10	19/11/19	FIRST ISSUE	MG	SS	SS	SM
P11	12/06/20	FIRST ISSUE	MG	KA	SM	AG
P12	22/06/20	TRO FINALISED FOR ISSUE	MG	KA	SM	AG
P13	16/07/20	TRO FINALISED FOR ISSUE	EG	SS	SM	AG
P14	31/07/20	TRO FINALISED FOR ISSUE	MK	SS	KA	KA
P15	09/09/20	KEY UPDATED	DC	AG	KA	SS
P16	10/09/20	KEY UPDATED	DC	KA	SS	AG
P17	14/09/20	KEY UPDATED	DC	SS	SM	---
P18	17/12/20	NOTES & KEY	DC	KA	KA	AG
P19	23/03/21	MELROSE DR/LINDSAY RD CROSSING	KA	SS	AG	AG

FOR INFORMATION S2

ATKINS
6th Floor
200 Broomielaw
Glasgow
Scotland
G1 4RU
Tel: +44 (0)141 220 2000
Fax: +44 (0)141 220 2001
www.atkinglobal.com

Copyright © Atkins Limited (2013)

EDINBURGH
THE CITY OF EDINBURGH COUNCIL

Project Title
**EDINBURGH TRAM
YORK PLACE TO NEWHAVEN**

Drawing Title
**PROPOSED
TRAFFIC REGULATION ORDERS
SHEET 2 OF 14**

Scale	Originator	Checked	Approved	Authorised
1:500	KA	SS	AG	AG
Original Size	Date	Date	Date	Date
A1	23/03/21	23/03/21	23/03/21	23/03/21
Drawing Number	Revision			
5149899-ATK-ETE-DRG-HW-00002	P19			

100
0 10
Millimetres

DO NOT SCALE

- NOTES:**
1. TOPOGRAPHICAL SURVEY PROVIDED BY THE CITY OF EDINBURGH COUNCIL DATED MARCH 2018, SUPPLEMENTED BY HISTORICAL OS TILES.
 2. THE TRO DRAWINGS ARE REPRESENTATIVE OF THE TRAFFIC ORDERS ONLY.
 3. THE TRO DRAWINGS SHOULD BE READ IN CONJUNCTION WITH THE APPLICABLE TRO SCHEDULES.
 4. MEASURES INDICATED ON THESE PLANS AS BEING OUT WITH THIS TRAFFIC ORDER ARE INDICATIVE ONLY AND WILL BE DEVELOPED SEPARATELY BY THE CITY OF EDINBURGH COUNCIL.

- KEY**
- GENERAL**
- BIN STORES
 - TAXI RANK
 - PEDESTRIAN PRIORITY CROSSINGS
 - PROPOSED KERB LINE
- MEASURES INCLUDED IN THIS TRAFFIC ORDER**
- NO WAITING AT ANY TIME / NO STOPPING AT ANY TIME / NO LOADING AT ANY TIME
 - NO WAITING / NO LOADING AT TIMES SHOWN IN SCHEDULES
 - PARKING BAYS AT TIMES SHOWN IN SCHEDULES
 - LOADING BAYS AT TIMES SHOWN IN SCHEDULES
 - LIMITED WAITING MON-SAT 7:30AM-6:30PM 4 HOURS, NO RETURN WITHIN 2 HOURS
- MEASURES NOT INCLUDED IN THIS TRAFFIC ORDER**
- PARKING BAYS (SEE NOTE 4 ABOVE)
 - LOADING BAYS (SEE NOTE 4 ABOVE)
 - DISABLED BAYS (SEE NOTE 4 ABOVE)

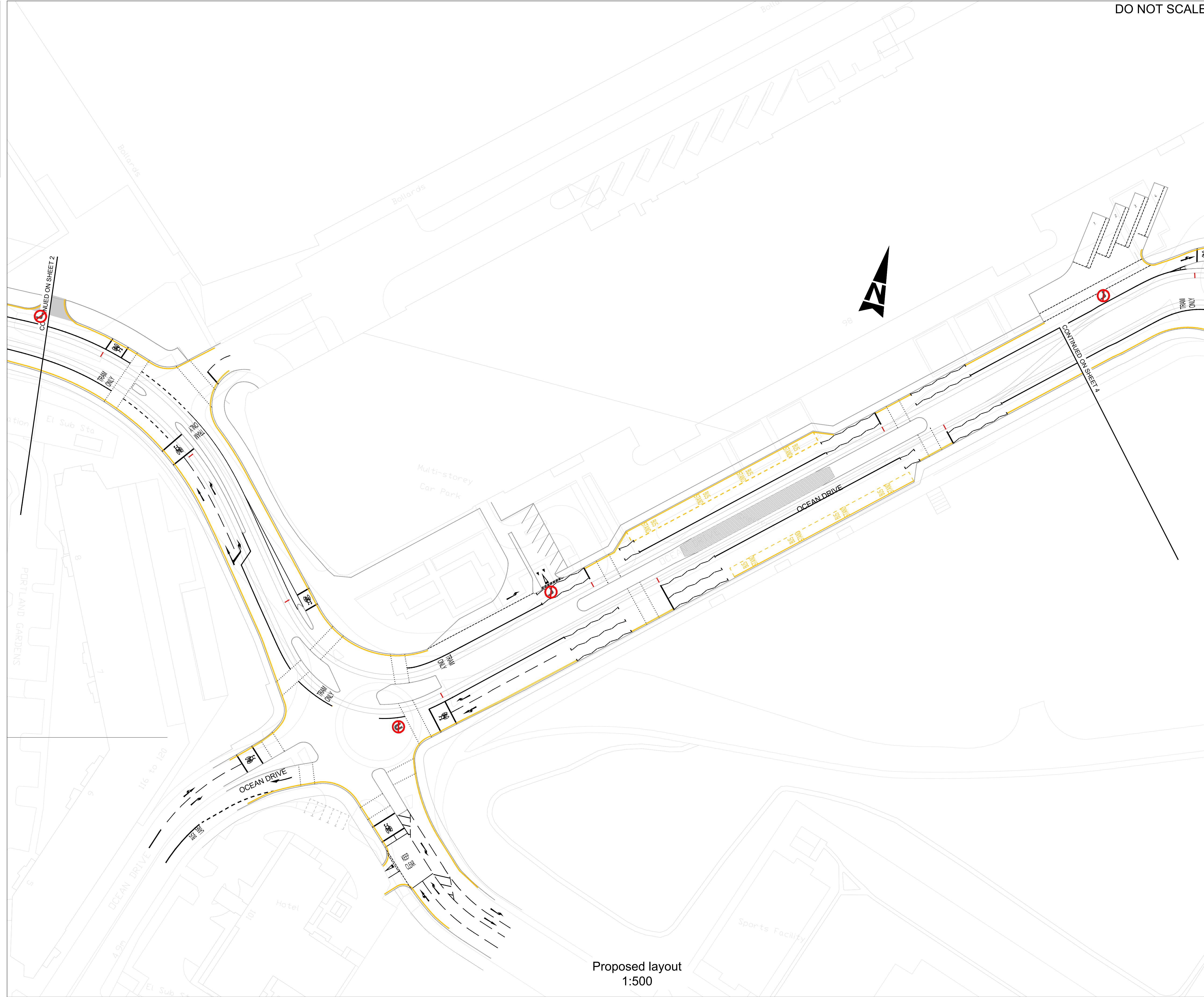

Proposed layout
1:500

Rev.	Date	Description	Org	Chk'd	App'd	Aur'd
P05	19/11/18	FIRST ISSUE	GK	JR	KC	SL
P06	12/02/19	FIRST ISSUE	MM	JR	KC	SM
P07	30/04/19	FIRST ISSUE	CC	JR	KC	SM
P08	12/06/20	FIRST ISSUE	MG	KA	SM	AG
P09	22/06/20	TRO FINALISED FOR ISSUE	MG	KA	SM	AG
P10	16/07/20	TRO FINALISED FOR ISSUE	EG	SS	SM	AG
P11	31/07/20	TRO FINALISED FOR ISSUE	MK	SS	KA	SM
P12	09/09/20	KEY UPDATED & U-TURN RESTRICTION ADDED	DC	AG	KA	SS
P13	10/09/20	KEY UPDATED & U-TURN RESTRICTION ADDED	DC	KA	SS	AG
P14	14/09/20	KEY UPDATED & U-TURN RESTRICTION ADDED	DC	SS	SM	AG
P15	17/12/20	NOTES & KEY / BUS STAND UPDATE	DC	KA	KA	KA
P16	08/04/21	ZIG ZAG MARKINGS	DC	KA	SS	AG

Drawing Status: FOR INFORMATION Suitability: S2

ATKINS
6th Floor
200 Broomielaw
Glasgow
Scotland
G1 4RU
Tel: +44 (0)141 220 2000
Fax: +44 (0)141 220 2001
Copyright © Atkins Limited (2013) www.atkinsglobal.com

EDINBURGH
THE CITY OF EDINBURGH COUNCIL

Project Title: EDINBURGH TRAM
YORK PLACE TO NEWHAVEN

Drawing Title: PROPOSED
TRAFFIC REGULATION ORDERS
SHEET 3 OF 14

Scale	Originator	Checked	Approved	Authorised
1:500	DC	KA	SS	AG
Original Size	Date	Date	Date	Date
A1	07/04/21	07/04/21	07/04/21	08/04/21
Drawing Number	Revision			
5149899-ATK-ETE-DRG-HW-00003	P16			

100
Millimetres
0 10

DO NOT SCALE

- NOTES:
1. TOPOGRAPHICAL SURVEY PROVIDED BY THE CITY OF EDINBURGH COUNCIL DATED MARCH 2018, SUPPLEMENTED BY HISTORICAL OS TILES.
 2. THE TRO DRAWINGS ARE REPRESENTATIVE OF THE TRAFFIC ORDERS ONLY.
 3. THE TRO DRAWINGS SHOULD BE READ IN CONJUNCTION WITH THE APPLICABLE TRO SCHEDULES.
 4. MEASURES INDICATED ON THESE PLANS AS BEING OUT WITH THIS TRAFFIC ORDER ARE INDICATIVE ONLY AND WILL BE DEVELOPED SEPARATELY BY THE CITY OF EDINBURGH COUNCIL.

KEY

GENERAL

- BIN STORES
- TAXI RANK
- PEDESTRIAN PRIORITY CROSSINGS
- PROPOSED KERB LINE

MEASURES INCLUDED IN THIS TRAFFIC ORDER

- NO WAITING AT ANY TIME / NO STOPPING AT ANY TIME / NO LOADING AT ANY TIME AT TIMES SHOWN IN SCHEDULES
- NO WAITING / NO LOADING AT TIMES SHOWN IN SCHEDULES
- PARKING BAYS AT TIMES SHOWN IN SCHEDULES
- LOADING BAYS AT TIMES SHOWN IN SCHEDULES
- LIMITED WAITING MON-SAT 7:30AM-6:30PM 4 HOURS, NO RETURN WITHIN 2 HOURS

MEASURES NOT INCLUDED IN THIS TRAFFIC ORDER

- PARKING BAYS (SEE NOTE 4 ABOVE)
- LOADING BAYS (SEE NOTE 4 ABOVE)
- DISABLED BAYS (SEE NOTE 4 ABOVE)

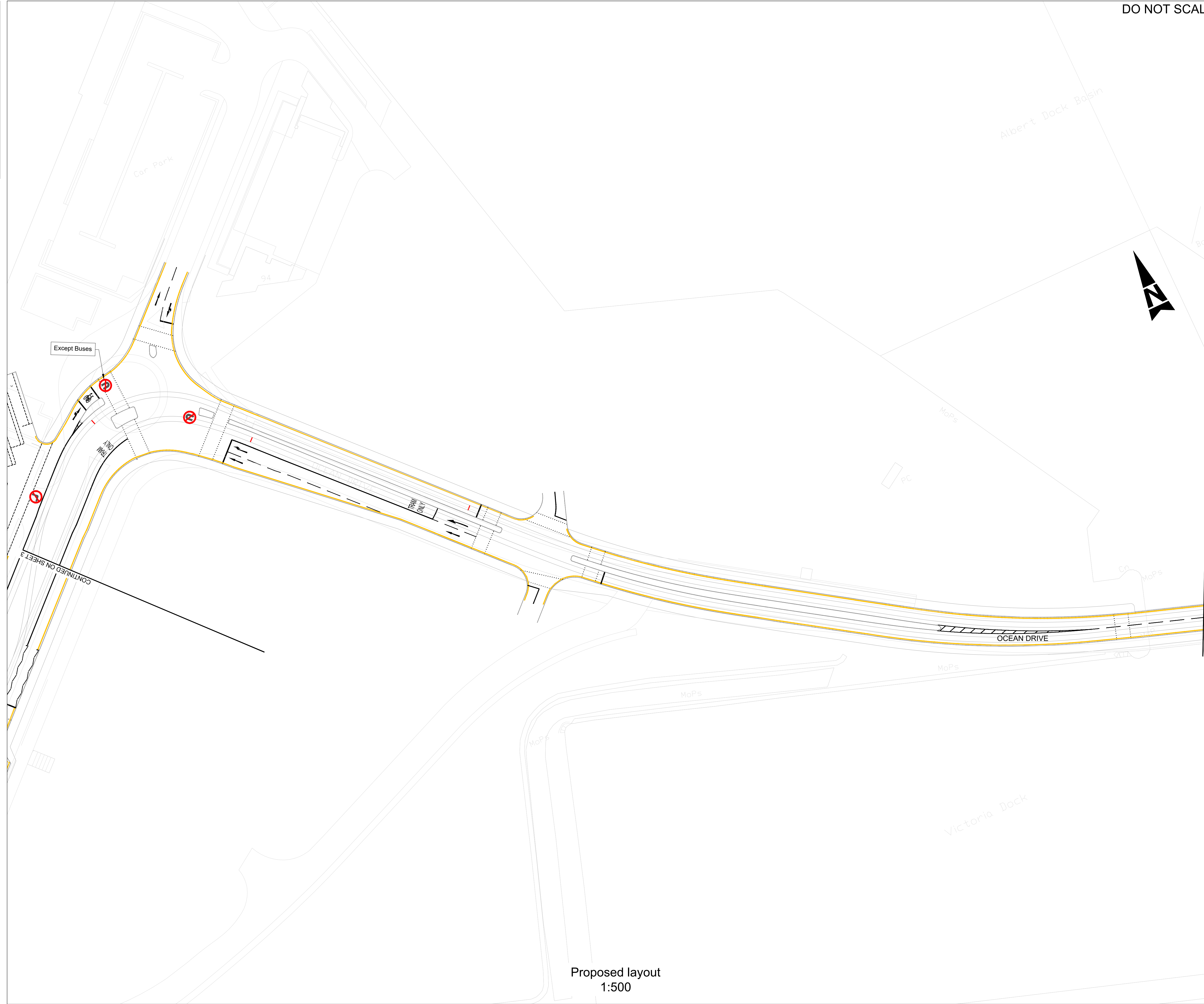

Proposed layout
1:500

Rev.	Date	Description	Org	Chk'd	App'd	Aur'd
P05	19/11/18	FIRST ISSUE	GK	JR	KC	SL
P06	12/02/19	FIRST ISSUE	MM	JR	KC	SM
P07	30/04/19	FIRST ISSUE	CC	JR	KC	SM
P08	12/06/20	FIRST ISSUE	MG	KA	SM	AG
P09	22/06/20	TRO FINALISED FOR ISSUE	MG	KA	SM	AG
P10	16/07/20	TRO FINALISED FOR ISSUE	EG	SS	SM	AG
P11	31/07/20	TRO FINALISED FOR ISSUE	MK	SS	KA	SM
P12	09/09/20	KEY UPDATED	DC	AG	KA	SS
P13	10/09/20	KEY UPDATED	DC	KA	SS	AG
P14	14/09/20	KEY UPDATED	DC	SS	SM	AG
P15	17/12/20	NOTES & KEY / BUS U TURN	DC	KA	SS	AG
P16	07/04/21	ZIG ZAG MARKINGS	DC	KA	SS	AG

Drawing Status: FOR INFORMATION Suitability: S2

ATKINS
 6th Floor
 200 Broomielaw
 Glasgow
 Scotland
 G1 4RU
 Tel: +44 (0)141 220 2000
 Fax: +44 (0)141 220 2001
 Copyright © Atkins Limited (2013) www.atkinsglobal.com

Client:
EDINBURGH
 THE CITY OF EDINBURGH COUNCIL

Project Title:
 EDINBURGH TRAM
 YORK PLACE TO NEWHAVEN

Drawing Title:
 PROPOSED
 TRAFFIC REGULATION ORDERS
 SHEET 4 OF 14

Scale	Originator	Checked	Approved	Authorised
1:500	DC	KA	SS	AG

Original Size	Date	Date	Date	Date
A1	07/04/21	07/04/21	07/04/21	08/04/21

Drawing Number: 5149899-ATK-ETE-DRG-HW-00004 Revision: P16

100
Millimetres
0 10

DO NOT SCALE

- NOTES:
1. TOPOGRAPHICAL SURVEY PROVIDED BY THE CITY OF EDINBURGH COUNCIL DATED MARCH 2018, SUPPLEMENTED BY HISTORICAL OS TILES.
 2. THE TRO DRAWINGS ARE REPRESENTATIVE OF THE TRAFFIC ORDERS ONLY.
 3. THE TRO DRAWINGS SHOULD BE READ IN CONJUNCTION WITH THE APPLICABLE TRO SCHEDULES.
 4. MEASURES INDICATED ON THESE PLANS AS BEING OUT WITH THIS TRAFFIC ORDER ARE INDICATIVE ONLY AND WILL BE DEVELOPED SEPARATELY BY THE CITY OF EDINBURGH COUNCIL.

KEY

GENERAL

- BIN STORES
- TAXI RANK
- PEDESTRIAN PRIORITY CROSSINGS
- PROPOSED KERB LINE

MEASURES INCLUDED IN THIS TRAFFIC ORDER

- NO WAITING AT ANY TIME / NO STOPPING AT ANY TIME / NO LOADING AT ANY TIME
- NO WAITING / NO LOADING AT TIMES SHOWN IN SCHEDULES
- PARKING BAYS AT TIMES SHOWN IN SCHEDULES
- LOADING BAYS AT TIMES SHOWN IN SCHEDULES
- LIMITED WAITING MON-SAT 7:30AM-6:30PM 4 HOURS, NO RETURN WITHIN 2 HOURS

MEASURES NOT INCLUDED IN THIS TRAFFIC ORDER

- PARKING BAYS (SEE NOTE 4 ABOVE)
- LOADING BAYS (SEE NOTE 4 ABOVE)
- DISABLED BAYS (SEE NOTE 4 ABOVE)

Rev.	Date	Description	Org	Chk'd	App'd	Aur'd	
P03	12/01/18	FIRST ISSUE		GK	JR	KC	SL
P04	14/03/18	FIRST ISSUE		GK	JR	KC	SL
P05	19/11/18	FIRST ISSUE		GK	JR	KC	SL
P06	12/02/19	FIRST ISSUE		MM	JR	KC	SM
P07	30/04/19	FIRST ISSUE		CC	JR	KC	SM
P08	12/06/20	FIRST ISSUE		MG	KA	SM	AG
P09	22/06/20	TRO FINALISED FOR ISSUE		MG	KA	SM	AG
P10	16/07/20	TRO FINALISED FOR ISSUE		EG	SS	SM	AG
P11	31/07/20	TRO FINALISED FOR ISSUE		MK	SS	KA	SM
P12	09/09/20	KEY UPDATED		DC	AG	KA	SS
P13	10/09/20	KEY UPDATED		DC	KA	SS	AG
P14	17/12/20	NOTES & KEY		DC	KA	SS	AG
Rev.	Date	Description	Org	Chk'd	App'd	Aur'd	

Drawing Status: **FOR INFORMATION** Suitability: **S2**

ATKINS
 6th Floor
 200 Broomielaw
 Glasgow
 Scotland
 G1 4RU
 Tel: +44 (0)141 220 2000
 Fax: +44 (0)141 220 2001
 Copyright © Atkins Limited (2013) www.atkinsglobal.com

Client: **EDINBURGH**
 THE CITY OF EDINBURGH COUNCIL

Project Title: **EDINBURGH TRAM
 YORK PLACE TO NEWHAVEN**

Drawing Title: **PROPOSED
 TRAFFIC REGULATION ORDERS
 SHEET 5 OF 14**

Scale	Originator	Checked	Approved	Authorised
1:500	DC	KA	SS	AG
Original Size	Date	Date	Date	Date
A1	17/12/20	17/12/20	17/12/20	17/12/20
Drawing Number	Revision			
5149899-ATK-ETE-DRG-HW-00005	P14			

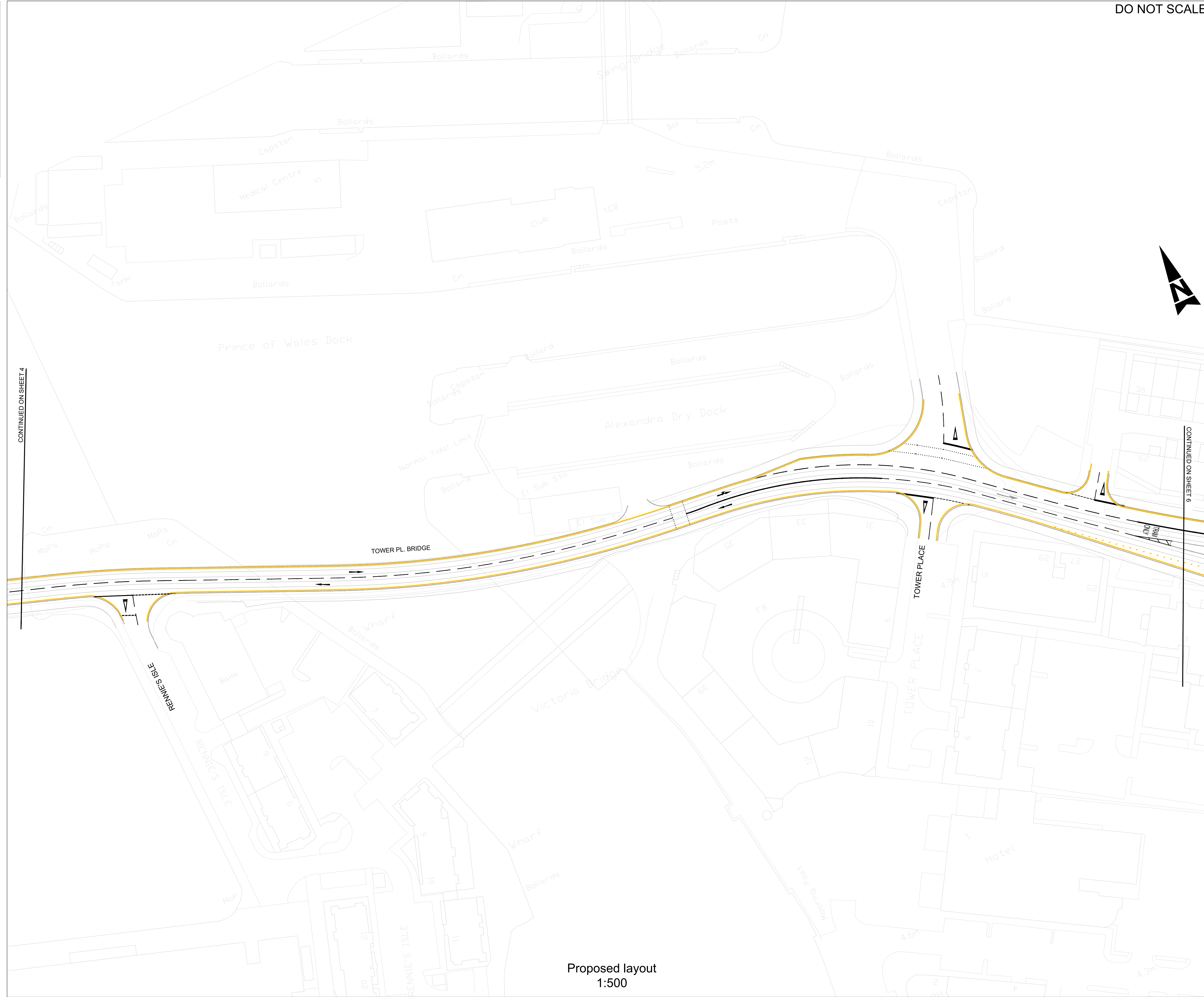

CONTINUED ON SHEET 4

CONTINUED ON SHEET 6

Proposed layout
 1:500

100
Millimetres
0 10

DO NOT SCALE

- NOTES:**
1. TOPOGRAPHICAL SURVEY PROVIDED BY THE CITY OF EDINBURGH COUNCIL DATED MARCH 2018, SUPPLEMENTED BY HISTORICAL OS TILES.
 2. THE TRO DRAWINGS ARE REPRESENTATIVE OF THE TRAFFIC ORDERS ONLY.
 3. THE TRO DRAWINGS SHOULD BE READ IN CONJUNCTION WITH THE APPLICABLE TRO SCHEDULES.
 4. MEASURES INDICATED ON THESE PLANS AS BEING OUT WITH THIS TRAFFIC ORDER ARE INDICATIVE ONLY AND WILL BE DEVELOPED SEPARATELY BY THE CITY OF EDINBURGH COUNCIL.

- KEY**
- GENERAL**
- BIN STORES
 - TAXI RANK
 - PEDESTRIAN PRIORITY CROSSINGS
 - PROPOSED KERB LINE
- MEASURES INCLUDED IN THIS TRAFFIC ORDER**
- NO WAITING AT ANY TIME / NO STOPPING AT ANY TIME / NO LOADING AT ANY TIME
 - NO WAITING / NO LOADING AT TIMES SHOWN IN SCHEDULES
 - PARKING BAYS AT TIMES SHOWN IN SCHEDULES
 - LOADING BAYS AT TIMES SHOWN IN SCHEDULES
 - LIMITED WAITING MON-SAT 7:30AM-6:30PM 4 HOURS, NO RETURN WITHIN 2 HOURS
- MEASURES NOT INCLUDED IN THIS TRAFFIC ORDER**
- PARKING BAYS (SEE NOTE 4 ABOVE)
 - LOADING BAYS (SEE NOTE 4 ABOVE)
 - DISABLED BAYS (SEE NOTE 4 ABOVE)

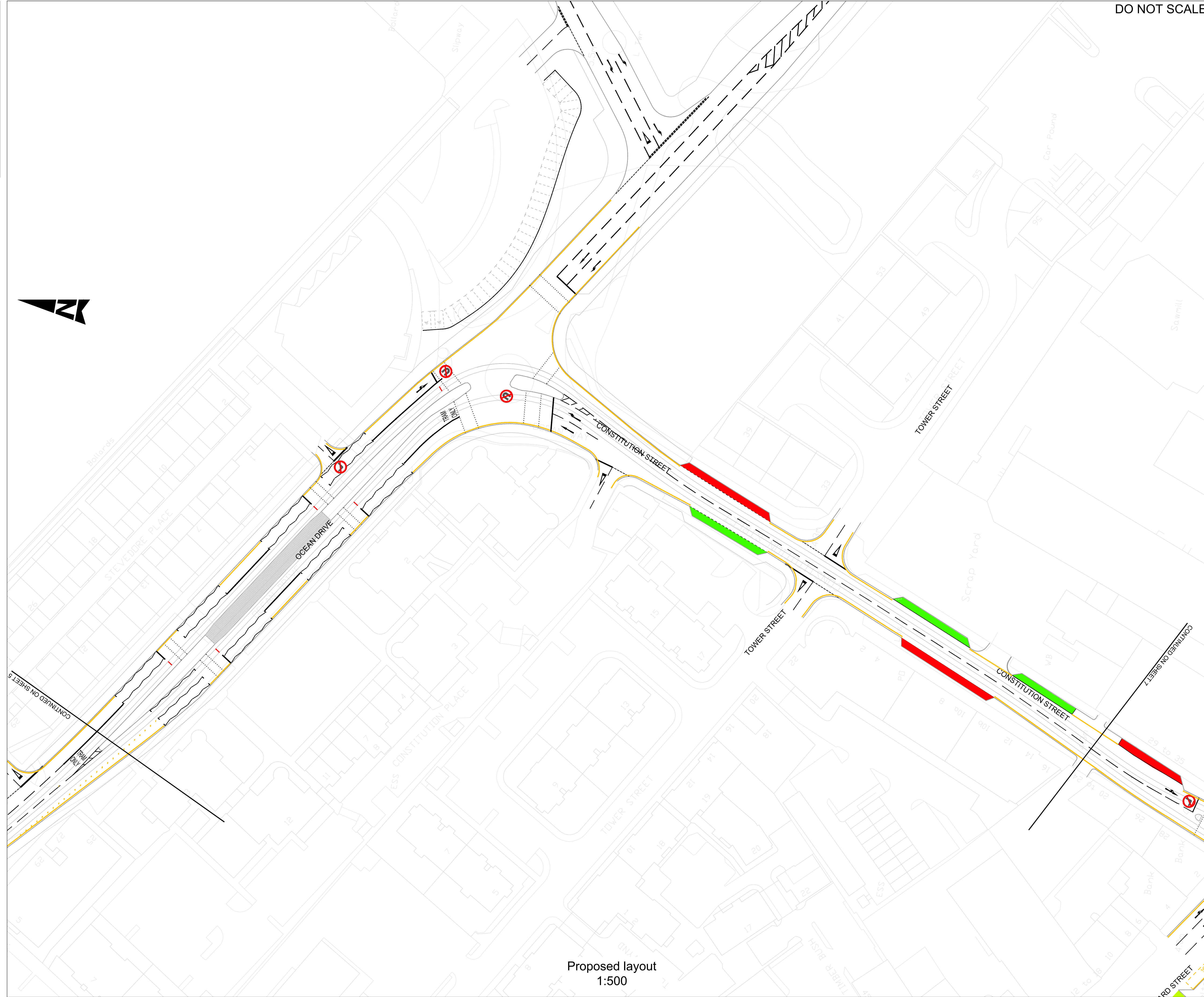

Rev.	Date	Description	Org	Chk'd	App'd	Aur'd	
P06	12/02/19	FOR REVIEW AND COMMENT		MM	JR	KC	SM
P07	30/04/19	FOR REVIEW AND COMMENT		CC	JR	KC	SM
P08	12/06/20	FOR REVIEW AND COMMENT		MG	KA	SM	AG
P09	22/06/20	TRO FINALISED FOR ISSUE		MG	KA	SM	AG
P10	16/07/20	TRO FINALISED FOR ISSUE		EG	SS	SM	AG
P11	31/07/20	TRO FINALISED FOR ISSUE		MK	SS	KA	SM
P12	09/09/20	KEY UPDATED		DC	AG	KA	SS
P13	10/09/20	KEY UPDATED		DC	KA	SS	AG
P14	14/09/20	KEY UPDATED		DC	SS	SM	---
P15	17/12/20	NOTES & KEY		DC	KA	SS	AG
P16	23/03/21	CASINO LOADING BAY REMOVED		KA	SS	AG	AG
P17	08/04/21	ZIG ZAG MARKINGS/TRAMSTOP CROSSING		DC	KA	SS	AG

Drawing Status: **FOR INFORMATION** Suitability: **S2**

ATKINS
 6th Floor
 200 Broomielaw
 Glasgow
 Scotland
 G1 4RU
 Tel: +44 (0)141 220 2000
 Fax: +44 (0)141 220 2001
 Copyright © Atkins Limited (2013) www.atkinsglobal.com

Client: **EDINBURGH**
 THE CITY OF EDINBURGH COUNCIL

Project Title: **EDINBURGH TRAM
 YORK PLACE TO NEWHAVEN**

Drawing Title: **PROPOSED
 TRAFFIC REGULATION ORDERS
 SHEET 6 OF 14**

Scale	Originator	Checked	Approved	Authorised
1:500	DC	KA	SS	AG
Original Size	Date	Date	Date	Date
A1	07/04/21	07/04/21	07/04/21	08/04/21
Drawing Number	Revision			
5149899-ATK-ETE-DRG-HW-00006	P17			

Proposed layout
 1:500

100
0 10
Millimetres

DO NOT SCALE

- NOTES:
1. TOPOGRAPHICAL SURVEY PROVIDED BY THE CITY OF EDINBURGH COUNCIL DATED MARCH 2018, SUPPLEMENTED BY HISTORICAL OS TILES.
 2. THE TRO DRAWINGS ARE REPRESENTATIVE OF THE TRAFFIC ORDERS ONLY.
 3. THE TRO DRAWINGS SHOULD BE READ IN CONJUNCTION WITH THE APPLICABLE TRO SCHEDULES.
 4. MEASURES INDICATED ON THESE PLANS AS BEING OUT WITH THIS TRAFFIC ORDER ARE INDICATIVE ONLY AND WILL BE DEVELOPED SEPARATELY BY THE CITY OF EDINBURGH COUNCIL.

- KEY
- GENERAL
- BIN STORES
 - TAXI RANK
 - PEDESTRIAN PRIORITY CROSSINGS
 - PROPOSED KERB LINE
- MEASURES INCLUDED IN THIS TRAFFIC ORDER
- NO WAITING AT ANY TIME / NO STOPPING AT ANY TIME / NO LOADING AT ANY TIME
 - NO WAITING / NO LOADING AT TIMES SHOWN IN SCHEDULES
 - PARKING BAYS AT TIMES SHOWN IN SCHEDULES
 - LOADING BAYS AT TIMES SHOWN IN SCHEDULES
 - LIMITED WAITING MON-SAT 7:30AM-6:30PM 4 HOURS, NO RETURN WITHIN 2 HOURS
- MEASURES NOT INCLUDED IN THIS TRAFFIC ORDER
- PARKING BAYS (SEE NOTE 4 ABOVE)
 - LOADING BAYS (SEE NOTE 4 ABOVE)
 - DISABLED BAYS (SEE NOTE 4 ABOVE)

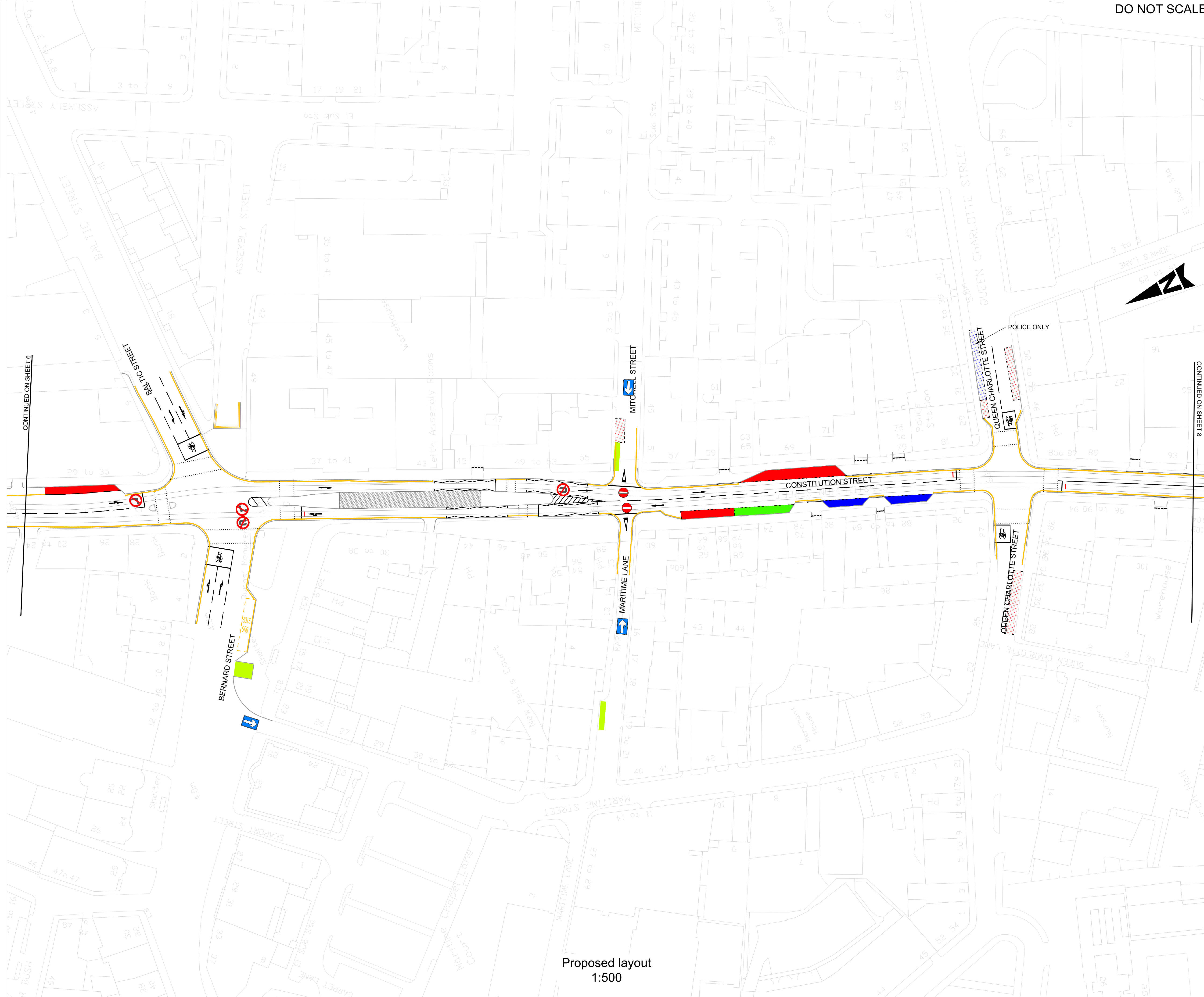

CONTINUED ON SHEET 6

CONTINUED ON SHEET 8

Proposed layout
1:500

Rev.	Date	Description	Org	Chk'd	App'd	Aur'd
P06	19/11/18	FOR REVIEW AND COMMENT	GK	JR	KC	SL
P07	12/02/19	FOR REVIEW AND COMMENT	MM	JR	KC	SM
P08	30/04/19	FOR REVIEW AND COMMENT	CC	JR	KC	SM
P09	12/06/20	FOR REVIEW AND COMMENT	MG	KA	SS	AG
P10	22/06/20	TRO FINALISED FOR ISSUE	MG	KA	SS	AG
P11	16/07/20	TRO FINALISED FOR ISSUE	EG	SS	SS	AG
P12	09/09/20	WASTE MANAGEMENT UPDATES	DC	AG	KA	SS
P13	10/09/20	WASTE MANAGEMENT UPDATES	DC	KA	SS	AG
P14	14/09/20	WASTE MANAGEMENT UPDATES	DC	SS	SS	---
P15	17/12/20	NOTES & KEY / CYCLE BOXES	DC	KA	SS	AG
P16	05/03/21	ACCESSES TIDY UP	DC	KA	SS	AG
P17	08/04/21	ZIG ZAG MARKINGS	DC	KA	SS	AG

Drawing Status: **S2**

ATKINS 6th Floor
200 Broomielaw
Glasgow
Scotland
G1 4RU
Tel: +44 (0)141 220 2000
Fax: +44 (0)141 220 2001
www.atkinsglobal.com

Copyright © Atkins Limited (2013)

EDINBURGH
THE CITY OF EDINBURGH COUNCIL

Project Title: **EDINBURGH TRAM
YORK PLACE TO NEWHAVEN**

Drawing Title: **PROPOSED
TRAFFIC REGULATION ORDERS
SHEET 7 OF 14**

Scale	Originator	Checked	Approved	Authorised
1:500	DC	KA	SS	AG
Original Size	Date	Date	Date	Date
A1	07/04/21	07/04/21	07/04/21	08/04/21
Drawing Number	Revision			
5149899-ATK-ETE-DRG-HW-00007	P17			

100
0 10
Millimetres

DO NOT SCALE

- NOTES:
1. TOPOGRAPHICAL SURVEY PROVIDED BY THE CITY OF EDINBURGH COUNCIL DATED MARCH 2018, SUPPLEMENTED BY HISTORICAL OS TILES.
 2. THE TRO DRAWINGS ARE REPRESENTATIVE OF THE TRAFFIC ORDERS ONLY.
 3. THE TRO DRAWINGS SHOULD BE READ IN CONJUNCTION WITH THE APPLICABLE TRO SCHEDULES.
 4. MEASURES INDICATED ON THESE PLANS AS BEING OUT WITH THIS TRAFFIC ORDER ARE INDICATIVE ONLY AND WILL BE DEVELOPED SEPARATELY BY THE CITY OF EDINBURGH COUNCIL.

- KEY
- GENERAL
- BIN STORES
 - TAXI RANK
 - PEDESTRIAN PRIORITY CROSSINGS
 - PROPOSED KERB LINE
- MEASURES INCLUDED IN THIS TRAFFIC ORDER
- NO WAITING AT ANY TIME / NO STOPPING AT ANY TIME / NO LOADING AT ANY TIME
 - NO WAITING / NO LOADING AT TIMES SHOWN IN SCHEDULES
 - PARKING BAYS AT TIMES SHOWN IN SCHEDULES
 - LOADING BAYS AT TIMES SHOWN IN SCHEDULES
 - LIMITED WAITING MON-SAT 7:30AM-6:30PM 4 HOURS, NO RETURN WITHIN 2 HOURS
- MEASURES NOT INCLUDED IN THIS TRAFFIC ORDER
- PARKING BAYS (SEE NOTE 4 ABOVE)
 - LOADING BAYS (SEE NOTE 4 ABOVE)
 - DISABLED BAYS (SEE NOTE 4 ABOVE)

Rev.	Date	Description	Org	Chk'd	App'd	Aur'd	
P07	19/11/18	FOR REVIEW AND COMMENT		GK	JR	KC	SL
P08	19/12/18	FOR REVIEW AND COMMENT		MM	JR	KC	SM
P09	12/02/19	FOR REVIEW AND COMMENT		MM	JR	KC	SM
P10	30/04/19	FOR REVIEW AND COMMENT		CC	JR	KC	SM
P11	12/06/20	FOR REVIEW AND COMMENT		MG	KA	SS	AG
P12	22/06/20	TRO FINALISED FOR ISSUE		MG	KA	SS	AG
P13	16/07/20	TRO FINALISED FOR ISSUE		EG	SS	SM	AG
P14	09/09/20	WASTE MANAGEMENT UPDATES		DC	AG	KA	SS
P15	10/09/20	WASTE MANAGEMENT UPDATES		DC	KA	SS	AG
P16	14/09/20	WASTE MANAGEMENT UPDATES		DC	SS	SM	AG
P17	17/12/20	NOTES & KEY		DC	KA	SS	AG
P18	05/03/21	ACCESSES TIDY UP		DC	KA	SS	AG

FOR INFORMATION S2

ATKINS
 6th Floor
 200 Broomielaw
 Glasgow
 Scotland
 G1 4RU
 Tel: +44 (0)141 220 2000
 Fax: +44 (0)141 220 2001
 www.atkinsglobal.com

Copyright © Atkins Limited (2013)

Client
EDINBURGH
 THE CITY OF EDINBURGH COUNCIL

Project Title
 EDINBURGH TRAM
 YORK PLACE TO NEWHAVEN

Drawing Title
 PROPOSED
 TRAFFIC REGULATION ORDERS
 SHEET 8 OF 14

Scale	Originator	Checked	Approved	Authorised
1:500	DC	KA	SS	AG
Original Size	Date	Date	Date	Date
A1	05/03/21	05/03/21	05/03/21	05/03/21
Drawing Number	Revision			
5149899-ATK-ETE-DRG-HW-00008	P18			

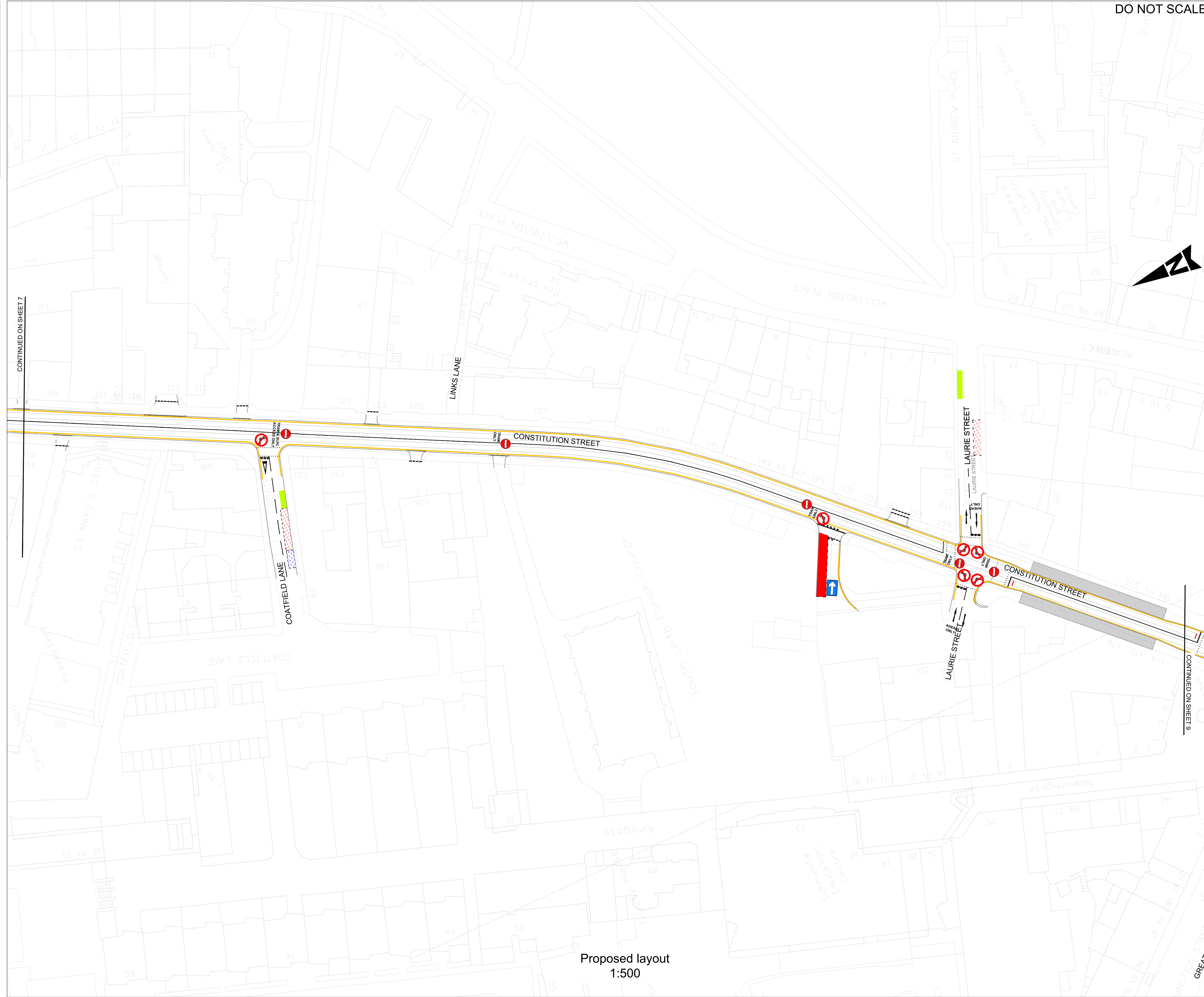

Proposed layout
 1:500

CONTINUED ON SHEET 7

CONTINUED ON SHEET 9

0 10 100
Millimetres

DO NOT SCALE

- NOTES:
1. TOPOGRAPHICAL SURVEY PROVIDED BY THE CITY OF EDINBURGH COUNCIL DATED MARCH 2018, SUPPLEMENTED BY HISTORICAL OS TILES.
 2. THE TRO DRAWINGS ARE REPRESENTATIVE OF THE TRAFFIC ORDERS ONLY.
 3. THE TRO DRAWINGS SHOULD BE READ IN CONJUNCTION WITH THE APPLICABLE TRO SCHEDULES.
 4. MEASURES INDICATED ON THESE PLANS AS BEING OUT WITH THIS TRAFFIC ORDER ARE INDICATIVE ONLY AND WILL BE DEVELOPED SEPARATELY BY THE CITY OF EDINBURGH COUNCIL.

KEY

GENERAL

- BIN STORES
- TAXI RANK
- PEDESTRIAN PRIORITY CROSSINGS
- PROPOSED KERB LINE

MEASURES INCLUDED IN THIS TRAFFIC ORDER

- NO WAITING AT ANY TIME / NO STOPPING AT ANY TIME / NO LOADING AT ANY TIME
- NO WAITING / NO LOADING AT TIMES SHOWN IN SCHEDULES
- PARKING BAYS AT TIMES SHOWN IN SCHEDULES
- LOADING BAYS AT TIMES SHOWN IN SCHEDULES
- LIMITED WAITING MON-SAT 7:30AM-6:30PM 4 HOURS, NO RETURN WITHIN 2 HOURS

MEASURES NOT INCLUDED IN THIS TRAFFIC ORDER

- PARKING BAYS (SEE NOTE 4 ABOVE)
- LOADING BAYS (SEE NOTE 4 ABOVE)
- DISABLED BAYS (SEE NOTE 4 ABOVE)

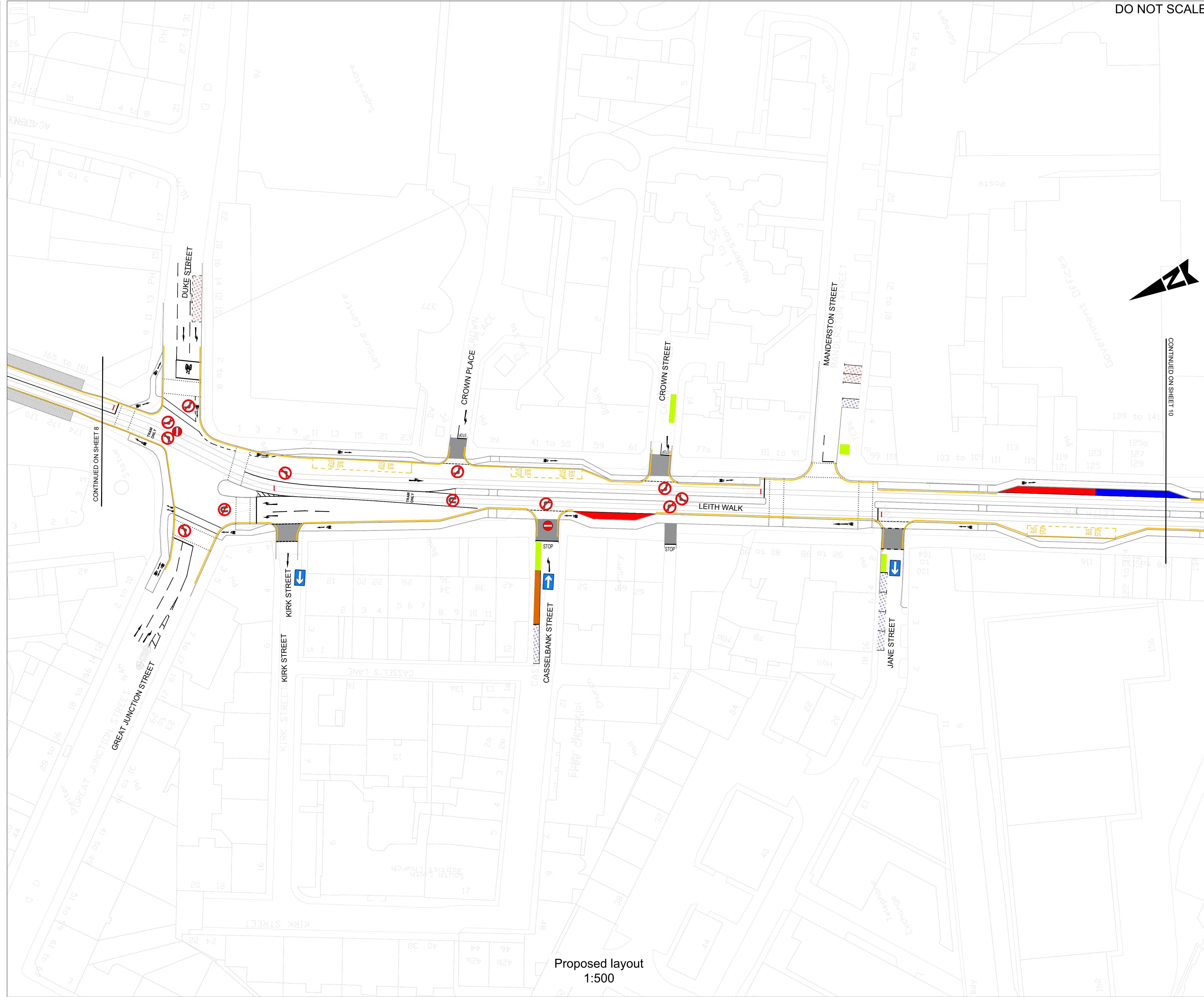

CONTINUED ON SHEET 10

Rev.	Date	Description	Org	Chk'd	App'd	Aur'd
P13	22/06/20	TRO FINALISED FOR ISSUE	MG	KA	SM	AG
P14	16/07/20	TRO FINALISED FOR ISSUE	EG	SS	SM	AG
P15	09/09/20	WASTE MANAGEMENT UPDATES	DC	AG	KA	SS
P16	10/09/20	WASTE MANAGEMENT UPDATES	DC	KA	SS	AG
P17	14/09/20	WASTE MANAGEMENT UPDATES	DC	SS	SM	AG
P18	22/09/20	LEITH WALK BUS STOP EXTENDED	DC	SS	SM	AG
P19	17/12/20	PRIORITY CROSSINGS / CYCLE LAYOUTS	DC	KA	SS	AG
P20	05/03/21	FOW CYCLE LAYOUT / STOP MARKINGS	DC	KA	SS	AG
P21	12/03/21	CYCLE LAYOUT GREAT JUNCTION STREET	DC	KA	SS	AG
P22	23/03/21	CYCLE/FOOTWAY GREAT JUNCTION STREET	KA	SS	AG	AG
P23	25/03/21	FOOT OF WALK CYCLE LAYOUT	DC	KA	SS	AG
P24	30/03/21	CYCLE LAYOUT AT FOW & BUS STOPS	DC	KA	SS	AG

FOR INFORMATION S2

ATKINS 6th Floor
200 Broomielaw
Glasgow
Scotland
G1 4RU
Tel: +44 (0)141 220 2000
Fax: +44 (0)141 220 2001
www.atkinsglobal.com

Copyright © Atkins Limited (2013)



Project Title
**EDINBURGH TRAM
YORK PLACE TO NEWHAVEN**

Drawing Title
**PROPOSED
TRAFFIC REGULATION ORDERS
SHEET 9 OF 14**

Scale	Originator	Checked	Approved	Authorised
1:500	DC	KA	SS	AG
Original Size	Date	Date	Date	Date
A1	30/03/21	30/03/21	30/03/21	30/03/21
Drawing Number	Revision			
5149899-ATK-ETE-DRG-HW-00009	P24			

Proposed layout
1:500

100
0 10
Millimetres

DO NOT SCALE

- NOTES:
1. TOPOGRAPHICAL SURVEY PROVIDED BY THE CITY OF EDINBURGH COUNCIL DATED MARCH 2018, SUPPLEMENTED BY HISTORICAL OS TILES.
 2. THE TRO DRAWINGS ARE REPRESENTATIVE OF THE TRAFFIC ORDERS ONLY.
 3. THE TRO DRAWINGS SHOULD BE READ IN CONJUNCTION WITH THE APPLICABLE TRO SCHEDULES.
 4. MEASURES INDICATED ON THESE PLANS AS BEING OUT WITH THIS TRAFFIC ORDER ARE INDICATIVE ONLY AND WILL BE DEVELOPED SEPARATELY BY THE CITY OF EDINBURGH COUNCIL.

- KEY
- GENERAL
- BIN STORES
 - TAXI RANK
 - PEDESTRIAN PRIORITY CROSSINGS
 - PROPOSED KERB LINE
- MEASURES INCLUDED IN THIS TRAFFIC ORDER
- NO WAITING AT ANY TIME / NO STOPPING AT ANY TIME / NO LOADING AT ANY TIME
 - NO WAITING / NO LOADING AT TIMES SHOWN IN SCHEDULES
 - PARKING BAYS AT TIMES SHOWN IN SCHEDULES
 - LOADING BAYS AT TIMES SHOWN IN SCHEDULES
 - LIMITED WAITING MON-SAT 7:30AM-6:30PM 4 HOURS, NO RETURN WITHIN 2 HOURS
- MEASURES NOT INCLUDED IN THIS TRAFFIC ORDER
- PARKING BAYS (SEE NOTE 4 ABOVE)
 - LOADING BAYS (SEE NOTE 4 ABOVE)
 - DISABLED BAYS (SEE NOTE 4 ABOVE)

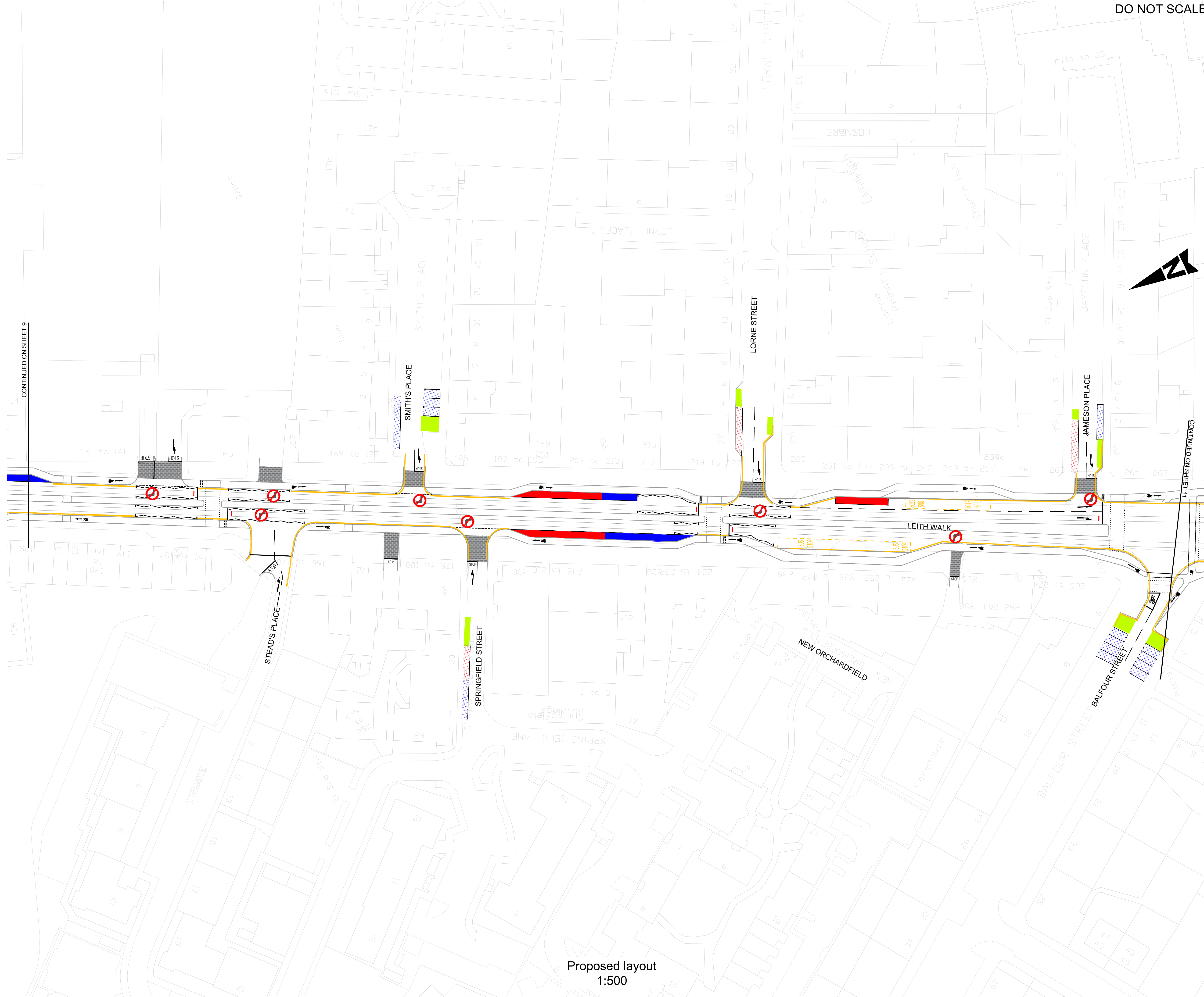
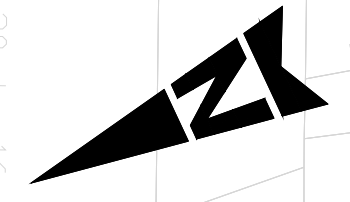

CONTINUED ON SHEET 9

CONTINUED ON SHEET 11

Rev.	Date	Description	Org	Chk'd	App'd	Aur'd
P07	19/11/18	FOR REVIEW AND COMMENT	GK	JR	KC	SL
P08	12/02/19	FOR REVIEW AND COMMENT	MM	JR	KC	SM
P09	30/04/19	FOR REVIEW AND COMMENT	CC	JR	KC	SM
P10	12/06/20	FOR REVIEW AND COMMENT	MG	KA	SS	AG
P11	22/06/20	TRO FINALISED FOR ISSUE	MG	KA	SS	AG
P12	16/07/20	TRO FINALISED FOR ISSUE	EG	SS	SS	AG
P13	09/09/20	WASTE MANAGEMENT UPDATES	DC	AG	KA	SS
P14	10/09/20	WASTE MANAGEMENT UPDATES	DC	KA	SS	AG
P15	14/09/20	WASTE MANAGEMENT UPDATES	DC	SS	SS	AG
P16	17/12/20	PRIORITY CROSSINGS / CYCLE LAYOUTS	DC	KA	SS	AG
P17	05/03/21	SUBSTATION ACCESS / STOP MARKINGS	DC	KA	SS	AG
P18	08/04/21	ZIG ZAG MARKINGS/PARKING & LOADING BAYS	DC	KA	SS	AG

FOR INFORMATION S2

ATKINS
 6th Floor
 200 Broomielaw
 Glasgow
 Scotland
 G1 4RU
 Tel: +44 (0)141 220 2000
 Fax: +44 (0)141 220 2001
 Copyright © Atkins Limited (2013) www.atkinsglobal.com

EDINBURGH
 THE CITY OF EDINBURGH COUNCIL

Project Title
 EDINBURGH TRAM
 YORK PLACE TO NEWHAVEN

Drawing Title
 PROPOSED
 TRAFFIC REGULATION ORDERS
 SHEET 10 OF 14

Scale	Originator	Checked	Approved	Authorised
1:500	DC	KA	SS	AG
Original Size	Date	Date	Date	Date
A1	07/04/21	07/04/21	07/04/21	08/04/21
Drawing Number	Revision			
5149899-ATK-ETE-DRG-HW-00010	P18			

Proposed layout
 1:500

0 10 100
Millimetres

DO NOT SCALE

- NOTES:**
1. TOPOGRAPHICAL SURVEY PROVIDED BY THE CITY OF EDINBURGH COUNCIL DATED MARCH 2018, SUPPLEMENTED BY HISTORICAL OS TILES.
 2. THE TRO DRAWINGS ARE REPRESENTATIVE OF THE TRAFFIC ORDERS ONLY.
 3. THE TRO DRAWINGS SHOULD BE READ IN CONJUNCTION WITH THE APPLICABLE TRO SCHEDULES.
 4. MEASURES INDICATED ON THESE PLANS AS BEING OUT WITH THIS TRAFFIC ORDER ARE INDICATIVE ONLY AND WILL BE DEVELOPED SEPARATELY BY THE CITY OF EDINBURGH COUNCIL.

- KEY**
- GENERAL**
- BIN STORES
 - TAXI RANK
 - PEDESTRIAN PRIORITY CROSSINGS
 - PROPOSED KERB LINE
- MEASURES INCLUDED IN THIS TRAFFIC ORDER**
- NO WAITING AT ANY TIME / NO STOPPING AT ANY TIME / NO LOADING AT ANY TIME
 - NO WAITING / NO LOADING AT TIMES SHOWN IN SCHEDULES
 - PARKING BAYS AT TIMES SHOWN IN SCHEDULES
 - LOADING BAYS AT TIMES SHOWN IN SCHEDULES
 - LIMITED WAITING MON-SAT 7:30AM-6:30PM 4 HOURS, NO RETURN WITHIN 2 HOURS
- MEASURES NOT INCLUDED IN THIS TRAFFIC ORDER**
- PARKING BAYS (SEE NOTE 4 ABOVE)
 - LOADING BAYS (SEE NOTE 4 ABOVE)
 - DISABLED BAYS (SEE NOTE 4 ABOVE)

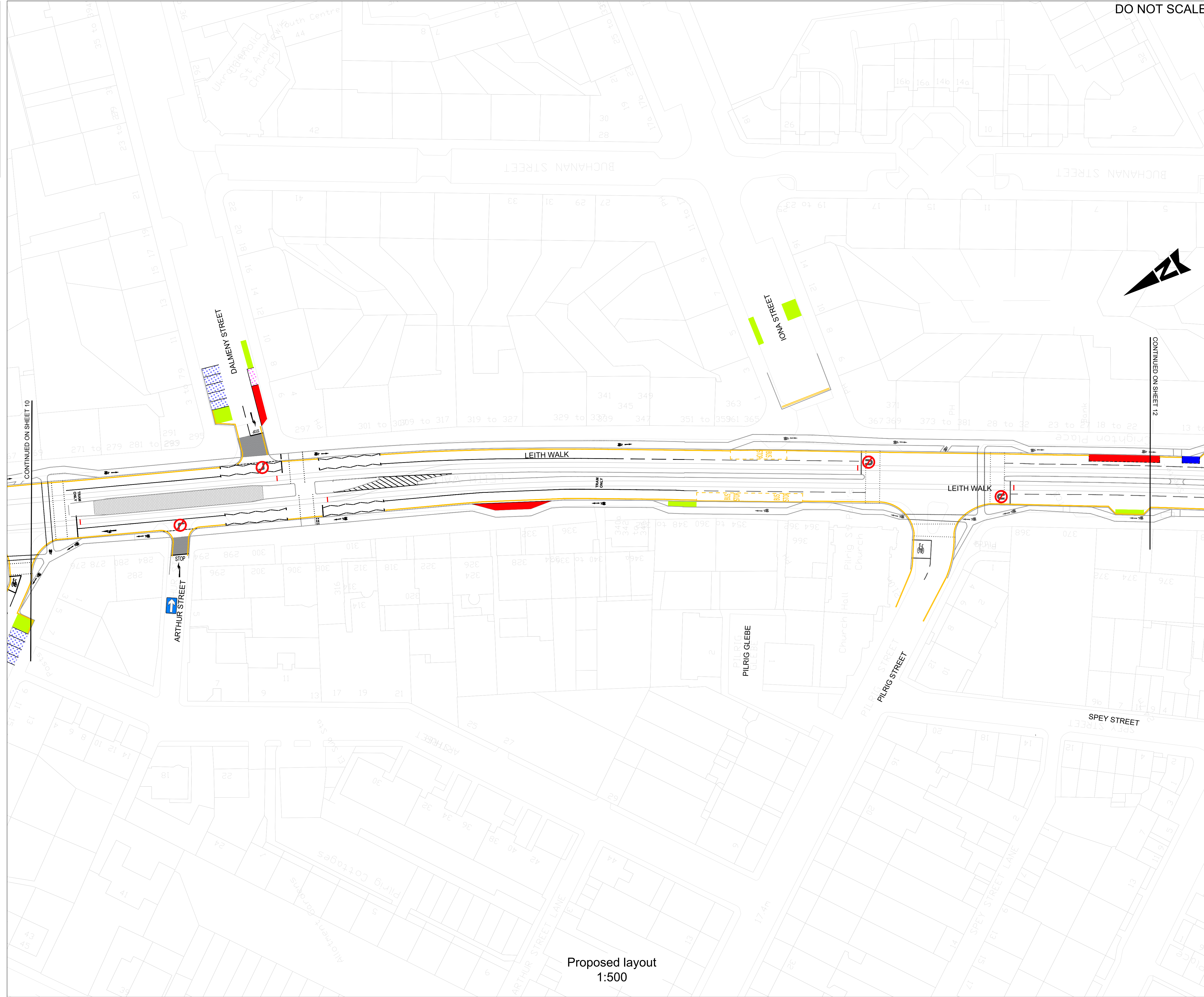

Proposed layout
1:500

Rev.	Date	Description	Org	Chk'd	App'd	Aur'd
P06	18/11/18	FOR REVIEW AND COMMENT		GK	JR	KC
P07	12/02/19	FOR REVIEW AND COMMENT		MM	JR	KC
P08	30/04/19	FOR REVIEW AND COMMENT		CC	JR	KC
P09	22/06/20	TRO FINALISED FOR ISSUE		MG	KA	SM
P10	16/07/20	TRO FINALISED FOR ISSUE		EG	SS	SM
P11	09/09/20	WASTE MANAGEMENT UPDATES		DC	AG	KA
P12	10/09/20	WASTE MANAGEMENT UPDATES		DC	KA	SS
P13	14/09/20	WASTE MANAGEMENT UPDATES		DC	SS	SM
P14	17/12/20	PRIORITY CROSSINGS / CYCLE LAYOUTS		DC	KA	SS
P15	05/03/21	STOP MARKINGS		DC	KA	SS
P16	23/03/21	BUS STOP NORTH OF PILRIG STREET		KA	SS	AG
P17	08/04/21	ZIG ZAG MARKINGS		DC	KA	SS

FOR INFORMATION S2

ATKINS 6th Floor
200 Broomielaw
Glasgow
Scotland
G1 4RU
Tel: +44 (0)141 220 2000
Fax: +44 (0)141 220 2001
www.atkinsglobal.com

Copyright © Atkins Limited (2013)

EDINBURGH
THE CITY OF EDINBURGH COUNCIL

Project Title
**EDINBURGH TRAM
YORK PLACE TO NEWHAVEN**

Drawing Title
**PROPOSED
TRAFFIC REGULATION ORDERS
SHEET 11 OF 14**

Scale	Originator	Checked	Approved	Authorised
1:500	DC	KA	SS	AG
Original Size	Date	Date	Date	Date
A1	07/04/21	07/04/21	07/04/21	08/04/21
Drawing Number	Revision			
5149899-ATK-ETE-DRG-HW-00011	P17			

0 10 100
Millimetres

DO NOT SCALE

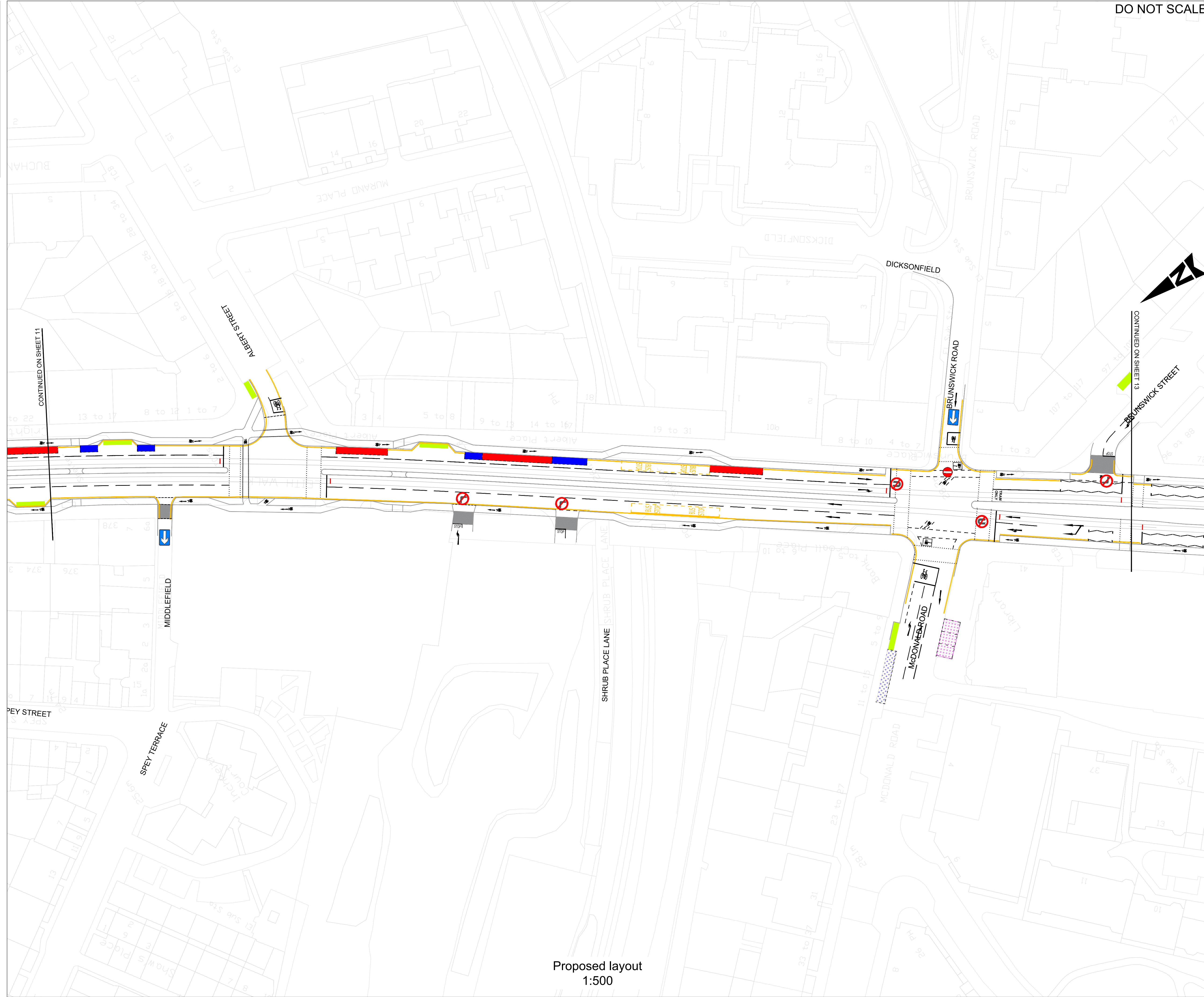

- NOTES:**
1. TOPOGRAPHICAL SURVEY PROVIDED BY THE CITY OF EDINBURGH COUNCIL DATED MARCH 2018, SUPPLEMENTED BY HISTORICAL OS TILES.
 2. THE TRO DRAWINGS ARE REPRESENTATIVE OF THE TRAFFIC ORDERS ONLY.
 3. THE TRO DRAWINGS SHOULD BE READ IN CONJUNCTION WITH THE APPLICABLE TRO SCHEDULES.
 4. MEASURES INDICATED ON THESE PLANS AS BEING OUT WITH THIS TRAFFIC ORDER ARE INDICATIVE ONLY AND WILL BE DEVELOPED SEPARATELY BY THE CITY OF EDINBURGH COUNCIL.

- KEY**
- GENERAL**
- BIN STORES
 - TAXI RANK
 - PEDESTRIAN PRIORITY CROSSINGS
 - PROPOSED KERB LINE
- MEASURES INCLUDED IN THIS TRAFFIC ORDER**
- NO WAITING AT ANY TIME / NO STOPPING AT ANY TIME / NO LOADING AT ANY TIME
 - NO WAITING / NO LOADING AT TIMES SHOWN IN SCHEDULES
 - PARKING BAYS AT TIMES SHOWN IN SCHEDULES
 - LOADING BAYS AT TIMES SHOWN IN SCHEDULES
 - LIMITED WAITING MON-SAT 7:30AM-6:30PM 4 HOURS, NO RETURN WITHIN 2 HOURS
- MEASURES NOT INCLUDED IN THIS TRAFFIC ORDER**
- PARKING BAYS (SEE NOTE 4 ABOVE)
 - LOADING BAYS (SEE NOTE 4 ABOVE)
 - DISABLED BAYS (SEE NOTE 4 ABOVE)

Rev.	Date	Description	Org	Chk'd	App'd	Aur'd
P08	19/12/18	FOR REVIEW AND COMMENT		MM	JR	KC SM
P09	12/02/19	FOR REVIEW AND COMMENT		MM	JR	KC SM
P10	30/04/19	FOR REVIEW AND COMMENT		CC	JR	KC SM
P11	22/06/20	TRO FINALISED FOR ISSUE		MG	KA	SM AG
P12	16/07/20	TRO FINALISED FOR ISSUE		EG	SS	SM AG
P13	09/09/20	WASTE MANAGEMENT UPDATES		DC	AG	KA SS
P14	10/09/20	WASTE MANAGEMENT UPDATES		DC	KA	SS AG
P15	14/09/20	WASTE MANAGEMENT UPDATES		DC	SS	SM AG
P16	17/12/20	PRIORITY CROSSINGS / CYCLE LAYOUTS		DC	KA	SS AG
P17	05/03/21	LEITH WALK PARKING BAYS / STOP MARKINGS		DC	KA	SS AG
P18	23/03/21	MCDONALD ROAD JUNCTION CYCLE LAYOUT		KA	SS	AG AG
P19	08/04/21	ZIG ZAG MARKINGS		DC	KA	SS AG

FOR INFORMATION S2

ATKINS
 6th Floor
 200 Broomielaw
 Glasgow
 Scotland
 G1 4RU
 Tel: +44 (0)141 220 2000
 Fax: +44 (0)141 220 2001
 www.atkinsglobal.com

Copyright © Atkins Limited (2013)
 Client **EDINBURGH**
 THE CITY OF EDINBURGH COUNCIL

Project Title
 EDINBURGH TRAM
 YORK PLACE TO NEWHAVEN

Drawing Title
 PROPOSED
 TRAFFIC REGULATION ORDERS
 SHEET 12 OF 14

Scale	Originator	Checked	Approved	Authorised
1:500	DC	KA	SS	AG
Original Size	Date	Date	Date	Date
A1	07/04/21	07/04/21	07/04/21	08/04/21
Drawing Number	Revision			
5149899-ATK-ETE-DRG-HW-00012	P19			

Proposed layout
 1:500

100
0 10
Millimetres

DO NOT SCALE

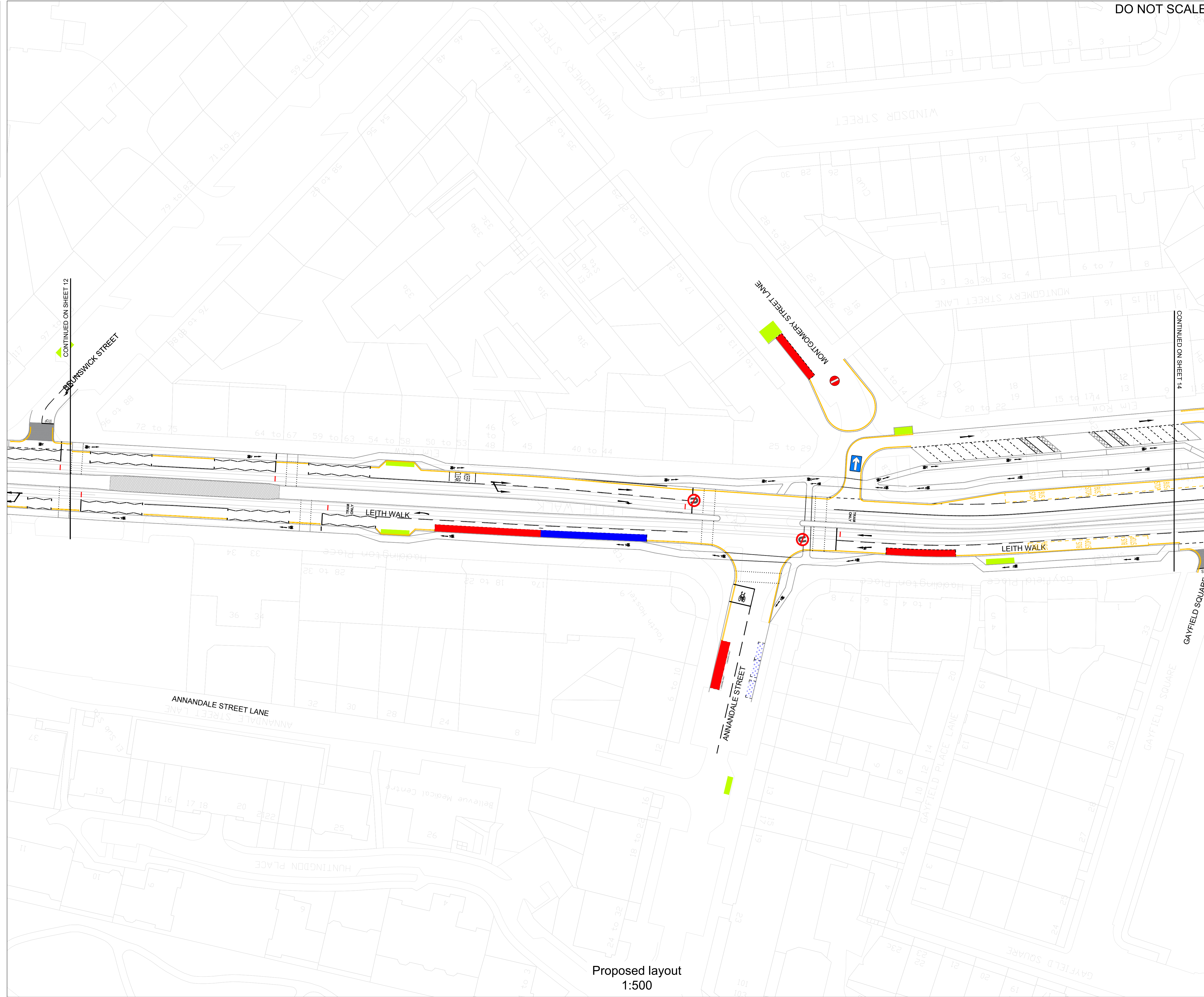

- NOTES:
1. TOPOGRAPHICAL SURVEY PROVIDED BY THE CITY OF EDINBURGH COUNCIL DATED MARCH 2018, SUPPLEMENTED BY HISTORICAL OS TILES.
 2. THE TRO DRAWINGS ARE REPRESENTATIVE OF THE TRAFFIC ORDERS ONLY.
 3. THE TRO DRAWINGS SHOULD BE READ IN CONJUNCTION WITH THE APPLICABLE TRO SCHEDULES.
 4. MEASURES INDICATED ON THESE PLANS AS BEING OUT WITH THIS TRAFFIC ORDER ARE INDICATIVE ONLY AND WILL BE DEVELOPED SEPARATELY BY THE CITY OF EDINBURGH COUNCIL.

- KEY
- GENERAL
- BIN STORES
 - TAXI RANK
 - PEDESTRIAN PRIORITY CROSSINGS
 - PROPOSED KERB LINE
- MEASURES INCLUDED IN THIS TRAFFIC ORDER
- NO WAITING AT ANY TIME / NO STOPPING AT ANY TIME / NO LOADING AT ANY TIME
 - NO WAITING / NO LOADING AT TIMES SHOWN IN SCHEDULES
 - PARKING BAYS AT TIMES SHOWN IN SCHEDULES
 - LOADING BAYS AT TIMES SHOWN IN SCHEDULES
 - LIMITED WAITING MON-SAT 7:30AM-6:30PM 4 HOURS, NO RETURN WITHIN 2 HOURS
- MEASURES NOT INCLUDED IN THIS TRAFFIC ORDER
- PARKING BAYS (SEE NOTE 4 ABOVE)
 - LOADING BAYS (SEE NOTE 4 ABOVE)
 - DISABLED BAYS (SEE NOTE 4 ABOVE)

Rev.	Date	Description	Org	Chk'd	App'd	Aur'd
P06	14/03/18	FOR REVIEW AND COMMENT		GK	JR	KC
P07	19/11/18	FOR REVIEW AND COMMENT		GK	JR	KC
P08	12/02/19	FOR REVIEW AND COMMENT		MM	JR	KC
P09	30/04/19	FOR REVIEW AND COMMENT		CC	JR	KC
P10	22/06/20	TRO FINALISED FOR ISSUE		MG	KA	SS
P11	16/07/20	TRO FINALISED FOR ISSUE		EG	SS	SM
P12	09/09/20	WASTE MANAGEMENT UPDATES		DC	AG	KA
P13	10/09/20	WASTE MANAGEMENT UPDATES		DC	KA	SS
P14	14/09/20	WASTE MANAGEMENT UPDATES		DC	SS	SM
P15	17/12/20	CYCLE LAYOUTS		DC	KA	SS
P16	05/03/21	STOP MARKINGS		DC	KA	SS
P17	08/04/21	ZIG ZAG MARKINGS		DC	KA	SS

Drawing Status: FOR INFORMATION Suitability: S2

ATKINS 6th Floor
200 Broomielaw
Glasgow
Scotland
G1 4RU
Tel: +44 (0)141 220 2000
Fax: +44 (0)141 220 2001
Copyright © Atkins Limited (2013) www.atkinsglobal.com

EDINBURGH
THE CITY OF EDINBURGH COUNCIL

Project Title: EDINBURGH TRAM YORK PLACE TO NEWHAVEN

Drawing Title: PROPOSED TRAFFIC REGULATION ORDERS SHEET 13 OF 14

Scale	Originator	Checked	Approved	Authorised
1:500	DC	KA	SS	AG
Original Size	Date	Date	Date	Date
A1	07/04/21	07/04/21	07/04/21	08/04/21
Drawing Number	Revision			
5149899-ATK-ETE-DRG-HW-00013	P17			

Proposed layout
1:500

100
0 10
Millimetres

DO NOT SCALE

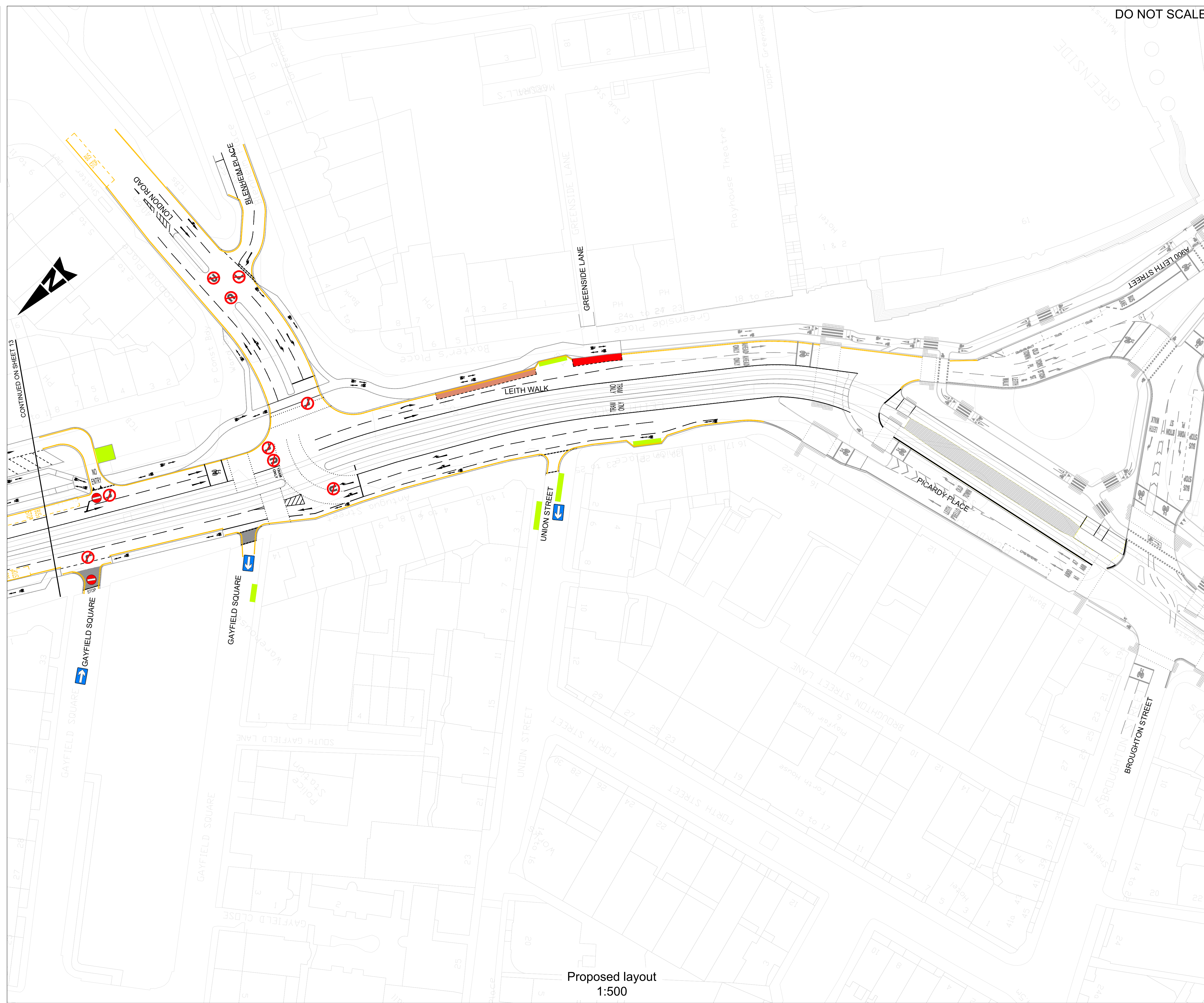

- NOTES:
1. TOPOGRAPHICAL SURVEY PROVIDED BY THE CITY OF EDINBURGH COUNCIL DATED MARCH 2018, SUPPLEMENTED BY HISTORICAL OS TILES.
 2. THE TRO DRAWINGS ARE REPRESENTATIVE OF THE TRAFFIC ORDERS ONLY.
 3. THE TRO DRAWINGS SHOULD BE READ IN CONJUNCTION WITH THE APPLICABLE TRO SCHEDULES.
 4. MEASURES INDICATED ON THESE PLANS AS BEING OUT WITH THIS TRAFFIC ORDER ARE INDICATIVE ONLY AND WILL BE DEVELOPED SEPARATELY BY THE CITY OF EDINBURGH COUNCIL.

- KEY
- GENERAL
- BIN STORES
 - TAXI RANK
 - PEDESTRIAN PRIORITY CROSSINGS
 - PROPOSED KERB LINE
- MEASURES INCLUDED IN THIS TRAFFIC ORDER
- NO WAITING AT ANY TIME / NO STOPPING AT ANY TIME / NO LOADING AT ANY TIME
 - NO WAITING / NO LOADING AT TIMES SHOWN IN SCHEDULES
 - PARKING BAYS AT TIMES SHOWN IN SCHEDULES
 - LOADING BAYS AT TIMES SHOWN IN SCHEDULES
 - LIMITED WAITING MON-SAT 7:30AM-6:30PM 4 HOURS, NO RETURN WITHIN 2 HOURS
- MEASURES NOT INCLUDED IN THIS TRAFFIC ORDER
- PARKING BAYS (SEE NOTE 4 ABOVE)
 - LOADING BAYS (SEE NOTE 4 ABOVE)
 - DISABLED BAYS (SEE NOTE 4 ABOVE)

Rev.	Date	Description	Org	Chk'd	App'd	Aur'd
P09	12/02/19	ADDING EDINBURGH SAINT JAMES DESIGN	MM	JR	KC	SM
P10	30/04/19	FOR REVIEW AND COMMENT	CC	JR	KC	SM
P11	12/06/20	FOR REVIEW AND COMMENT	MG	KA	SM	AG
P12	22/06/20	TRO FINALISED FOR ISSUE	MG	KA	SM	AG
P13	16/07/20	TRO FINALISED FOR ISSUE	EG	SS	SM	AG
P14	09/09/20	WASTE MANAGEMENT AND CYCLEWAY UPDATES	DC	AG	KA	SS
P15	10/09/20	WASTE MANAGEMENT AND CYCLEWAY UPDATES	DC	KA	SS	AG
P16	14/09/20	WASTE MANAGEMENT AND CYCLEWAY UPDATES	DC	SS	SM	AG
P17	17/12/20	LONDON RD JUNCTION / CYCLE LAYOUTS	DC	KA	SS	AG
P18	05/03/21	STOP MARKINGS	DC	KA	SS	AG
P19	23/03/21	PICARDY PLACE CYCLE WAY	KA	SS	AG	AG
P20	25/03/21	PICARDY PLACE CYCLE WAY	DC	KA	SS	AG

Drawing Status: FOR INFORMATION Suitability: S2

ATKINS

6th Floor
200 Broomielaw
Glasgow
Scotland
G1 4RU

Tel: +44 (0)141 220 2000
Fax: +44 (0)141 220 2001
www.atkinsglobal.com

Copyright © Atkins Limited (2013)

EDINBURGH
THE CITY OF EDINBURGH COUNCIL

Project Title: EDINBURGH TRAM YORK PLACE TO NEWHAVEN

Drawing Title: PROPOSED TRAFFIC REGULATION ORDERS SHEET 14 OF 14

Scale	Originator	Checked	Approved	Authorised
1:500	DC	KA	SS	AG
Original Size	Date	Date	Date	Date
A1	25/03/21	25/03/21	25/03/21	25/03/21
Drawing Number	Revision			
5149899-ATK-ETE-DRG-HW-00014	P20			

Proposed layout
1:500