

ALL CLASS ONE OPERATIVES ENGAGED IN
 TEMPORARY TRAFFIC MANAGEMENT
 OPERATIONS ARE LANTRA APPROVED AND
 ACCREDITED TO SECTOR SCHEME 12

CHAPTER 8 T.S.M DETAILS

DETAIL A
 Running signal
 1. When red light is on, all vehicles must stop.
 2. When red light is on, all vehicles must stop.
 3. When red light is on, all vehicles must stop.
 4. When red light is on, all vehicles must stop.

DETAIL B
 Road closed sign
 1. Road closed sign must be placed at least 10m in advance of the closed road.
 2. Road closed sign must be placed at least 10m in advance of the closed road.
 3. Road closed sign must be placed at least 10m in advance of the closed road.

DETAIL C1
 Pedestrian crossing sign
 1. Pedestrian crossing sign must be placed at least 10m in advance of the crossing.
 2. Pedestrian crossing sign must be placed at least 10m in advance of the crossing.
 3. Pedestrian crossing sign must be placed at least 10m in advance of the crossing.

DRAWING DETAILS

SIGN

- CONES OR MASS BARRIER
- DIRECTION OF TRAFFIC
- PEDESTRIAN CROSSING
- TEMPORARY PARKING
- TEMPORARY BUS STOP
- TRAFFIC LIGHT HEAD
- PEDESTRIAN LIGHT HEAD
- TRAFFIC LIGHT HEAD BASE AND DIRECTION

NOTES :-
 MINIMUM FOOTPATH WIDTH OF 1.5M WILL BE MAINTAINED, IN LINE WITH CONSTRUCTION PHASING 2.0M WHERE POSSIBLE

DRAWING STATUS : FOR REVIEW
REVISION: C

Date	Revision	Rev by	App. by
26/02/2021	ALTERATIONS TO SITE LAYOUT	SP	SP
30/04/2021	ALTERATIONS TO RUNNING LANE	SP	SP
02/12/2021	ALTERATIONS TO RUNNING LANE	BC	SP

Class One Traffic Management Ltd.



www.classone.org
 mail@classone.org

Drawn By : EB	Checked By : SP
Scale : N.T.S	Date : 22/01/21
Main Contractor : SFN	
Location : CH + 14134.35 London Road - CH + 15688.35 Manderson Street	
Traffic Management Arrangement : Leith Walk Phase 2 Works Area with Mandatory Closures and localised Movements	
Drawing No : ETYN-SFN-4XX-07-DR-0002 Smiths Place to Crown Street	A0
Revision : A B	

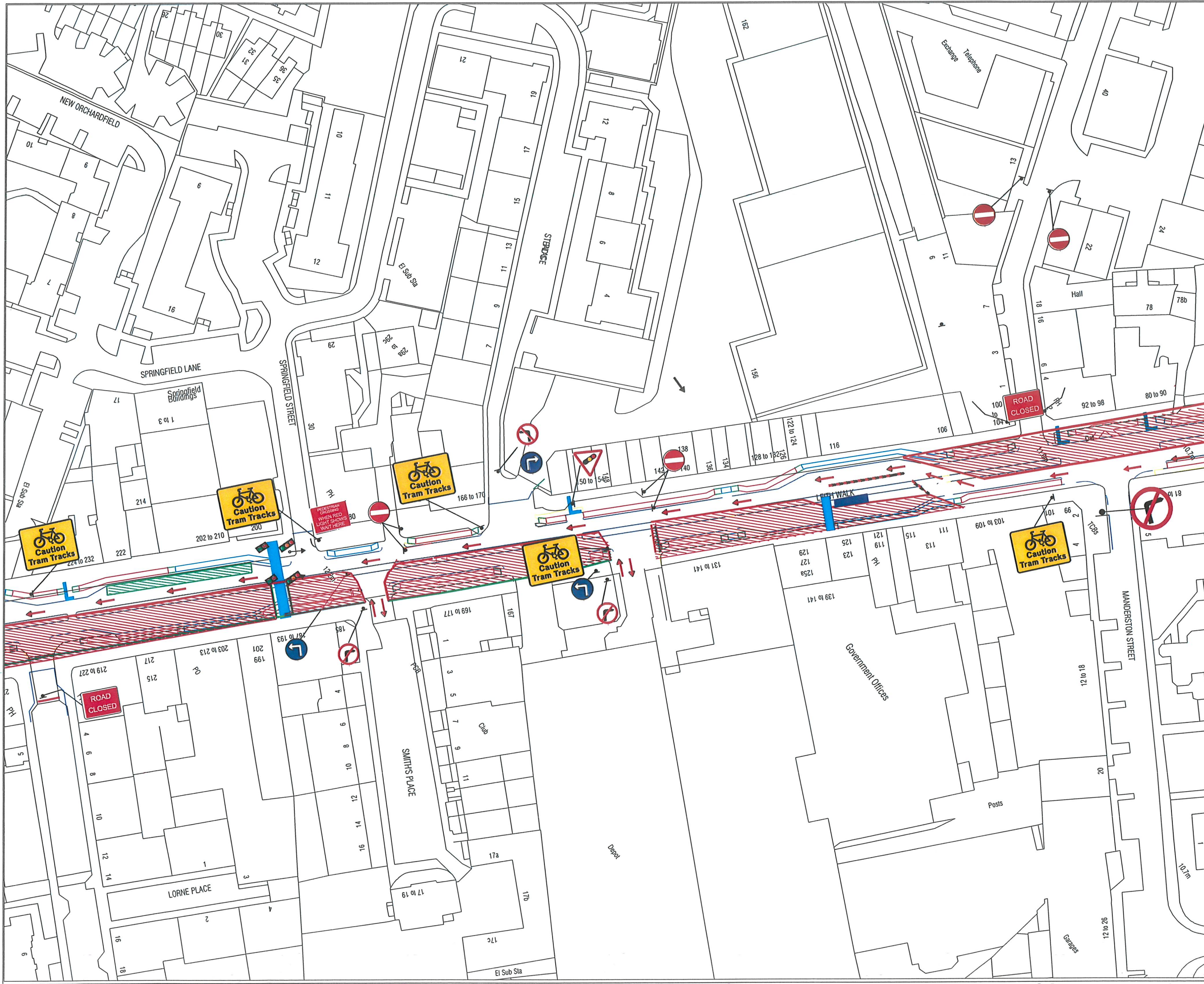

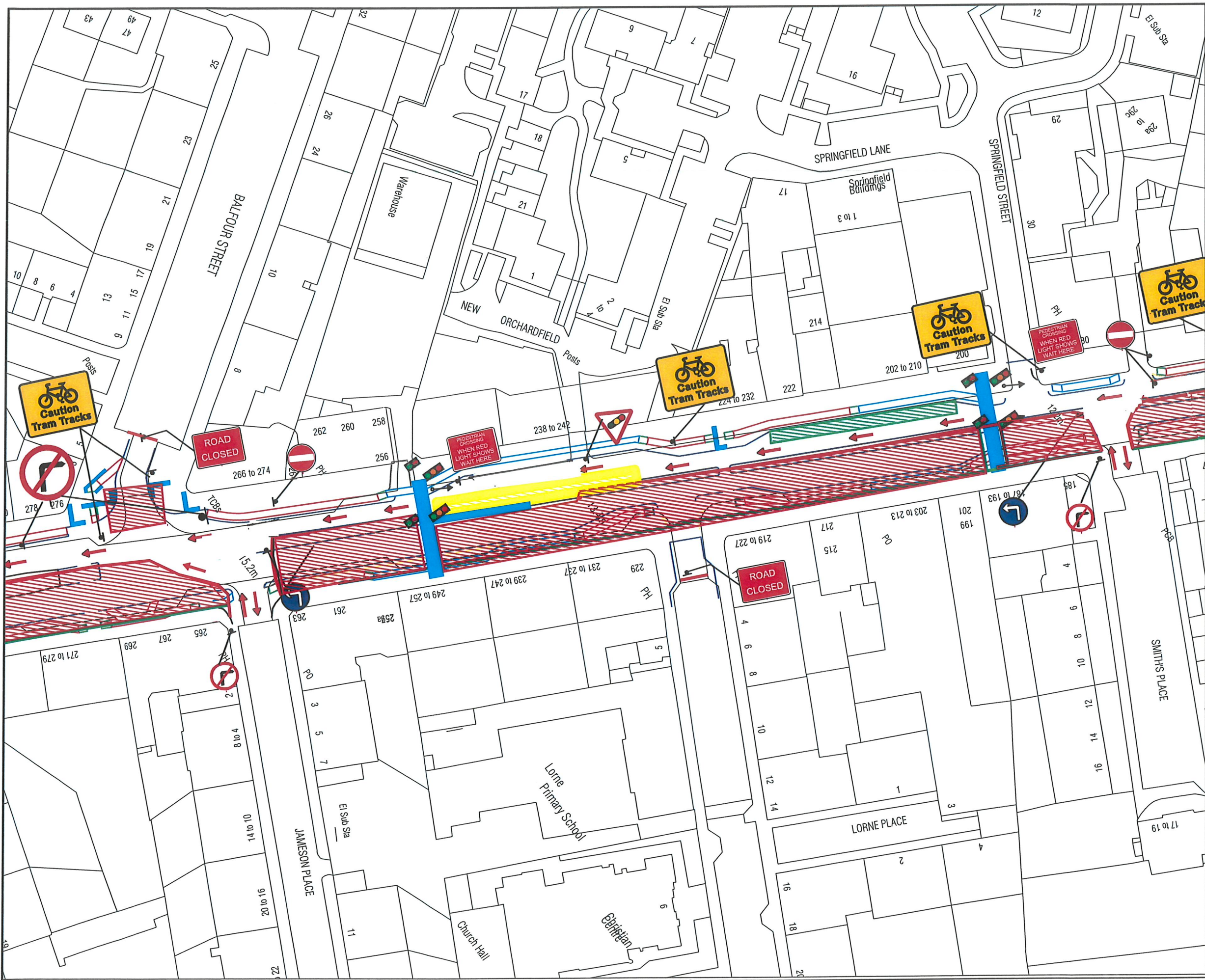

BBA✓ LANTRAY AWARDS!
 APPROVED INSTALLER 8594
 High Friction Surface Installer
APPROVED

UVDB Verify
 ISO 9001
 TMCA
 TRAFFIC MANAGEMENT CONTRACTORS ASSOCIATION

Verified
 Quality Management

ALL CLASS ONE OPERATIVES ENGAGED IN TEMPORARY TRAFFIC MANAGEMENT OPERATIONS ARE LANTRA APPROVED AND ACCREDITED TO SECTOR SCHEME 12

CHAPTER 8 T.S.M DETAILS

DETAIL A
 Pedestrian crossing with tram tracks
 1. Pedestrian crossing with tram tracks
 2. Pedestrian crossing with tram tracks
 3. Pedestrian crossing with tram tracks
 4. Pedestrian crossing with tram tracks
 5. Pedestrian crossing with tram tracks
 6. Pedestrian crossing with tram tracks
 7. Pedestrian crossing with tram tracks
 8. Pedestrian crossing with tram tracks
 9. Pedestrian crossing with tram tracks
 10. Pedestrian crossing with tram tracks
 11. Pedestrian crossing with tram tracks
 12. Pedestrian crossing with tram tracks
 13. Pedestrian crossing with tram tracks
 14. Pedestrian crossing with tram tracks
 15. Pedestrian crossing with tram tracks
 16. Pedestrian crossing with tram tracks
 17. Pedestrian crossing with tram tracks
 18. Pedestrian crossing with tram tracks
 19. Pedestrian crossing with tram tracks
 20. Pedestrian crossing with tram tracks
 21. Pedestrian crossing with tram tracks
 22. Pedestrian crossing with tram tracks
 23. Pedestrian crossing with tram tracks
 24. Pedestrian crossing with tram tracks
 25. Pedestrian crossing with tram tracks
 26. Pedestrian crossing with tram tracks
 27. Pedestrian crossing with tram tracks
 28. Pedestrian crossing with tram tracks
 29. Pedestrian crossing with tram tracks
 30. Pedestrian crossing with tram tracks
 31. Pedestrian crossing with tram tracks
 32. Pedestrian crossing with tram tracks
 33. Pedestrian crossing with tram tracks
 34. Pedestrian crossing with tram tracks
 35. Pedestrian crossing with tram tracks
 36. Pedestrian crossing with tram tracks
 37. Pedestrian crossing with tram tracks
 38. Pedestrian crossing with tram tracks
 39. Pedestrian crossing with tram tracks
 40. Pedestrian crossing with tram tracks
 41. Pedestrian crossing with tram tracks
 42. Pedestrian crossing with tram tracks
 43. Pedestrian crossing with tram tracks
 44. Pedestrian crossing with tram tracks
 45. Pedestrian crossing with tram tracks
 46. Pedestrian crossing with tram tracks
 47. Pedestrian crossing with tram tracks
 48. Pedestrian crossing with tram tracks
 49. Pedestrian crossing with tram tracks
 50. Pedestrian crossing with tram tracks
 51. Pedestrian crossing with tram tracks
 52. Pedestrian crossing with tram tracks
 53. Pedestrian crossing with tram tracks
 54. Pedestrian crossing with tram tracks
 55. Pedestrian crossing with tram tracks
 56. Pedestrian crossing with tram tracks
 57. Pedestrian crossing with tram tracks
 58. Pedestrian crossing with tram tracks
 59. Pedestrian crossing with tram tracks
 60. Pedestrian crossing with tram tracks
 61. Pedestrian crossing with tram tracks
 62. Pedestrian crossing with tram tracks
 63. Pedestrian crossing with tram tracks
 64. Pedestrian crossing with tram tracks
 65. Pedestrian crossing with tram tracks
 66. Pedestrian crossing with tram tracks
 67. Pedestrian crossing with tram tracks
 68. Pedestrian crossing with tram tracks
 69. Pedestrian crossing with tram tracks
 70. Pedestrian crossing with tram tracks
 71. Pedestrian crossing with tram tracks
 72. Pedestrian crossing with tram tracks
 73. Pedestrian crossing with tram tracks
 74. Pedestrian crossing with tram tracks
 75. Pedestrian crossing with tram tracks
 76. Pedestrian crossing with tram tracks
 77. Pedestrian crossing with tram tracks
 78. Pedestrian crossing with tram tracks
 79. Pedestrian crossing with tram tracks
 80. Pedestrian crossing with tram tracks
 81. Pedestrian crossing with tram tracks
 82. Pedestrian crossing with tram tracks
 83. Pedestrian crossing with tram tracks
 84. Pedestrian crossing with tram tracks
 85. Pedestrian crossing with tram tracks
 86. Pedestrian crossing with tram tracks
 87. Pedestrian crossing with tram tracks
 88. Pedestrian crossing with tram tracks
 89. Pedestrian crossing with tram tracks
 90. Pedestrian crossing with tram tracks
 91. Pedestrian crossing with tram tracks
 92. Pedestrian crossing with tram tracks
 93. Pedestrian crossing with tram tracks
 94. Pedestrian crossing with tram tracks
 95. Pedestrian crossing with tram tracks
 96. Pedestrian crossing with tram tracks
 97. Pedestrian crossing with tram tracks
 98. Pedestrian crossing with tram tracks
 99. Pedestrian crossing with tram tracks
 100. Pedestrian crossing with tram tracks

- DRAWING DETAILS
- ▶ SIGN
 - SECONDARY FENCE LINE
 - CONES OR MASS BARRIER
 - ← DIRECTION OF TRAFFIC
 - CYCLE LANE
 - PEDESTRIAN CROSSING
 - WORKS ACCESS/EXIT
 - Temporary Bus Stop
 - ◫ TRAFFIC LIGHT HEAD
 - ◫ PEDESTRIAN LIGHT HEAD
 - ◫ TRAFFIC LIGHT HEAD BASE AND DIRECTION

NOTES :-

MINIMUM FOOTPATH WIDTH OF 1.5M WILL BE MAINTAINED, IN LINE WITH CONSTRUCTION PHASING 2.0M WHERE POSSIBLE

DRAWING STATUS : FOR REVIEW

REVISION: C

Date	Revision	Rev. by	App. by
26/02/2021	ALTERATIONS TO SITE LAYOUT	SP	SP
30/04/2021	ALTERATIONS TO RUNNING LANE	SP	SP
02/12/2021	ALTERATIONS TO RUNNING LANE	BC	SP

Class One Traffic Management Ltd.

www.classone.org
 mail@classone.org

Drawn By: EB	Checked By: SP
Scale: N.T.S	Date: 22/01/21
Main Contractor: SFN	
Location: CH + 14134.35 London Road - CH + 15688.35 Manderson Street	
Traffic Management Arrangement: Leith Walk Phase 2 Works Area with Mandatory Closures and localised Movements	
Drawing No: ETYN-SFN-4XX-07-DR-002 Balfour Street to Smiths Place	A0
Revision: A B	

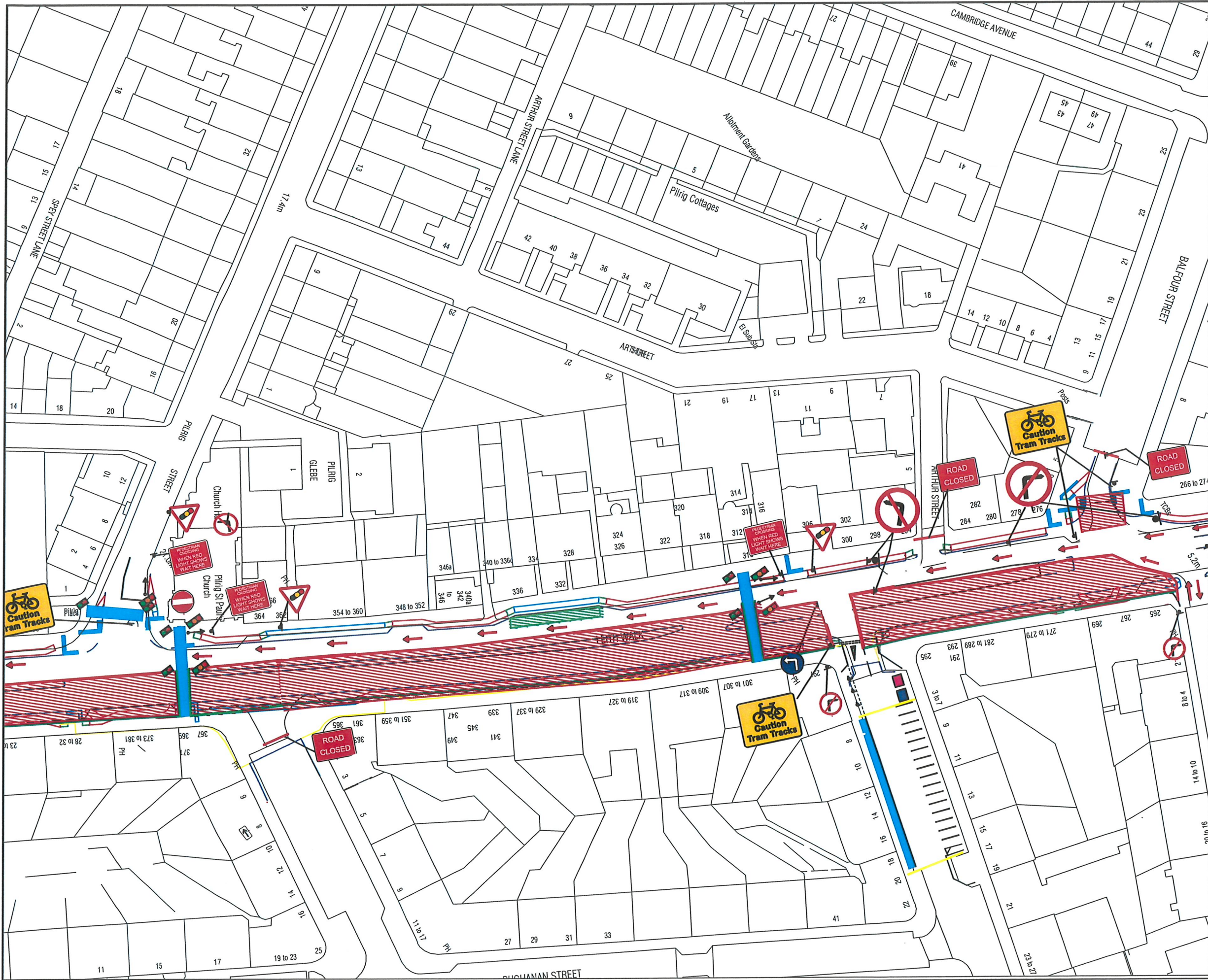

BBAV LANTRAY AWARDS!
 APPROVED INSTALLER 8594
 High Friction Surface Installer
 APPROVED

UVDB Verify
 Verified

TMCA
 TRAFFIC MANAGEMENT CONTRACTORS ASSOCIATION

ALL CLASS ONE OPERATIVES ENGAGED IN TEMPORARY TRAFFIC MANAGEMENT OPERATIONS ARE LANTRA APPROVED AND ACCREDITED TO SECTOR SCHEME 12

CHAPTER 8 T.S.M DETAILS

DETAIL A
 Proposed sign to be used in this area.
 Approved sign to be used in this area.
 Approved sign to be used in this area.
 Approved sign to be used in this area.

DETAIL B
 Proposed sign to be used in this area.
 Approved sign to be used in this area.
 Approved sign to be used in this area.
 Approved sign to be used in this area.

DETAIL C
 Proposed sign to be used in this area.
 Approved sign to be used in this area.
 Approved sign to be used in this area.
 Approved sign to be used in this area.

- DRAWING DETAILS**
- SIGN
 - SECONDARY FENCE LINE
 - CONES OR MASS BARRIER
 - DIRECTION OF TRAFFIC
 - PEDESTRIAN CROSSING
 - WORKS ACCESS/EXIT
 - BUS DIVERSION
 - TRAFFIC LIGHT HEAD
 - PEDESTRIAN LIGHT HEAD
 - TRAFFIC LIGHT HEAD BASE AND DIRECTION

NOTES :-

MINIMUM FOOTPATH WIDTH OF 1.5M WILL BE MAINTAINED, IN LINE WITH CONSTRUCTION PHASING 2.0M WHERE POSSIBLE

DRAWING STATUS : FOR REVIEW

REVISION: C

Date	Revision	By	App. by
26/02/2021	ALTERATIONS TO SITE LAYOUT	SP	SP
30/04/2021	ALTERATIONS TO RUNNING LANE	SP	SP
02/12/2021	ALTERATIONS TO RUNNING LANE	SP	SP

Class One Traffic Management Ltd.

www.classone.org
 mail@classone.org

Drawn By : EB	Checked By : SP
Scale : N.T.S	Date : 21/01/21
Main Contractor : SFN	
Location : CH + 14134.35 London Road - CH + 15688.35 Manderson Street	
Traffic Management Arrangement : Leith Walk Phase 2 Works Area with Mandatory Closures and localised Movements	
Drawing No : ETYN-SFN-4XX-07-DR-002 Pilrig Street to Balfour Street	A0
Revision : A B	

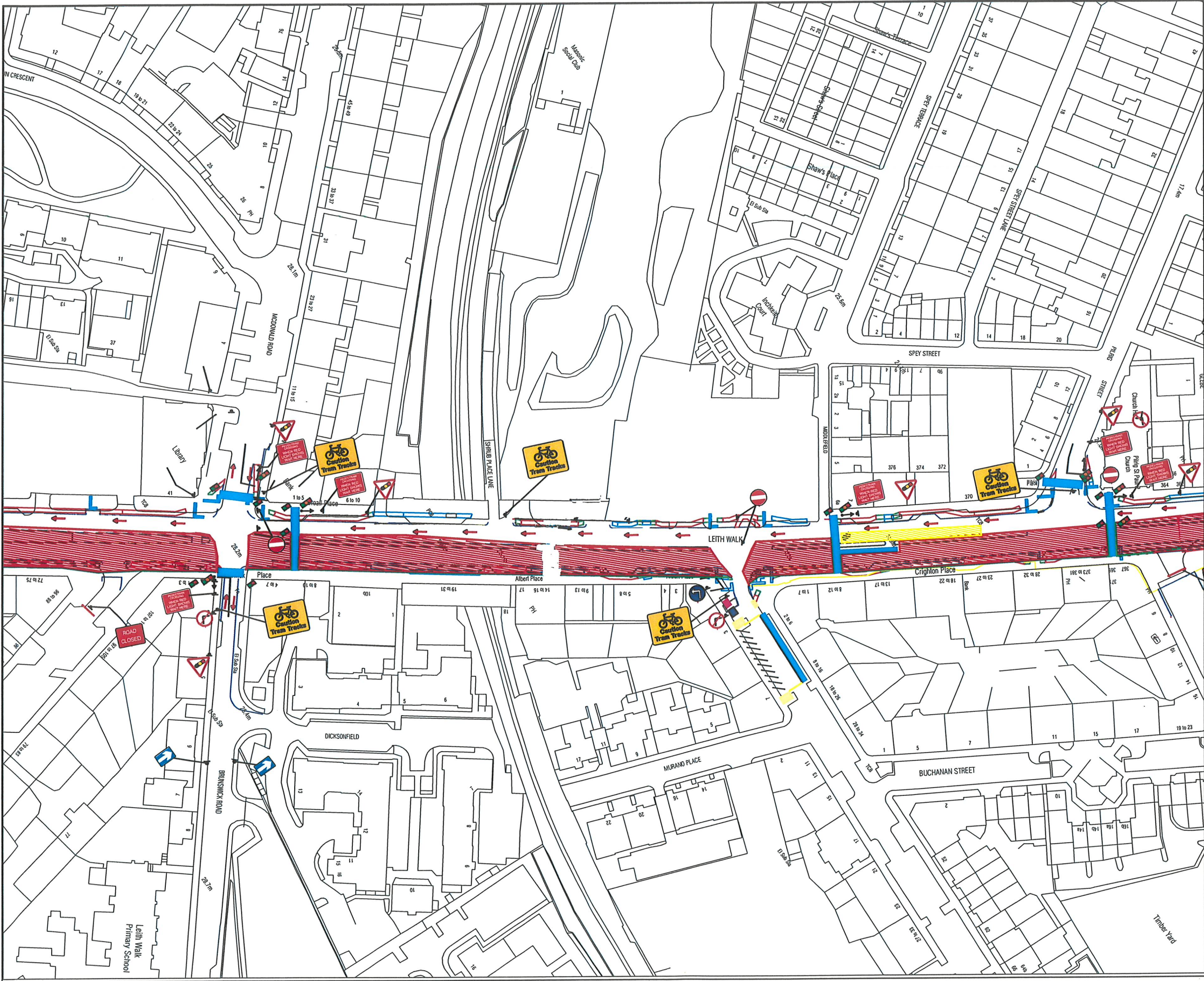

BBA APPROVED INSTALLER 8594
 High Friction Surface Installer
LANTRAY AWARDS!
 APPROVED

UVDE Verify
 Verified
TMCA
 TRAFFIC MANAGEMENT CONTRACTORS ASSOCIATION

ALL CLASS ONE OPERATIVES ENGAGED IN TEMPORARY TRAFFIC MANAGEMENT OPERATIONS ARE LANTRA APPROVED AND ACCREDITED TO SECTOR SCHEME 12

CHAPTER 8 T.S.M DETAILS

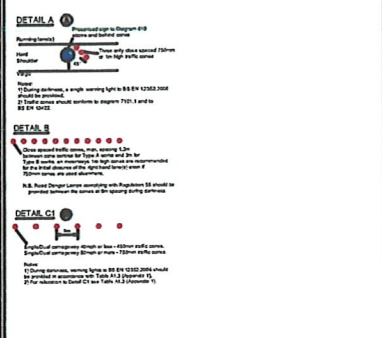

DRAWING DETAILS

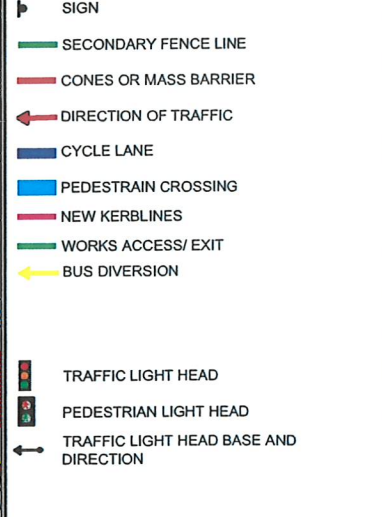

NOTES :-

MINIMUM FOOTPATH WIDTH OF 1.5M WILL BE MAINTAINED, IN LINE WITH CONSTRUCTION PHASING 2.0M WHERE POSSIBLE

DRAWING STATUS : FOR REVIEW

REVISION: B		
Date	Revision	Rev by / App by
26/02/2021	ALTERATIONS TO SITE LAYOUT	SP / SP
30/04/2021	ALTERATIONS TO RUNNING LANE	SP / SP
19/01/2022	ALTERATIONS TO RUNNING LANE	BC / SP

Class One Traffic Management Ltd.



Drawn By : EB	Checked By : SP
Scale : N.T.S	Date : 17/07/19
Main Contractor : SFN	
Location : CH + 14134.35 London Road - CH + 15698.35 Manderson Street	
Traffic Management Arrangement : Leith Walk Phase 2 Works Area with Mandatory Closures and localised Movements	
Drawing No : ETYN-SFN-4XX-07-DR-0002 McDonald Road to Pilrig Street	
Revision : A B	A0