

DETAIL A
 Pedestrian Light Head
 The pedestrian light head shall be as shown in the detail and shall be mounted on a post of height 1.2m. The light head shall be of the type which allows the light to be switched on and off from the ground level. The light head shall be of the type which allows the light to be switched on and off from the ground level. The light head shall be of the type which allows the light to be switched on and off from the ground level.

DETAIL B
 Traffic Light Head Base and Direction
 The traffic light head base and direction shall be as shown in the detail and shall be mounted on a post of height 1.2m. The light head base and direction shall be of the type which allows the light to be switched on and off from the ground level. The light head base and direction shall be of the type which allows the light to be switched on and off from the ground level.

DRAWING DETAILS

- SIGN**
- CONES OR MASS BARRIER
 - DIRECTION OF TRAFFIC
 - PROPOSED FOOTPATH CLOSURE
 - PEDESTRIAN CROSSING
 - PARKING AND LOADING SUSPENSION
 - PEDESTRIAN LIGHT HEAD
 - TRAFFIC LIGHT HEAD BASE AND DIRECTION
 - PEDESTRIAN LIGHT HEAD BASE AND DIRECTION

NOTES :-

DRAWING STATUS : FOR REVIEW

DATE	REVISION	BY	APP'D
23-07-19	ORIGINAL SKETCH	SP	SP

Class One Traffic Management Ltd.
 www.classone.org
 info@classone.org

Drawn By : SP Checked By : SP
 Scale : N.T.S Date : 14/11/22
 Main Contractor : SFN
 Location : Ocean Terminal
 Edinburgh
 Traffic Management Arrangement : 4 Way Lights and associated movements
 Drawing No : ETYN-SFN-14XX-07-DR-001
 Phase 2 Nov 22
 Revision : A0

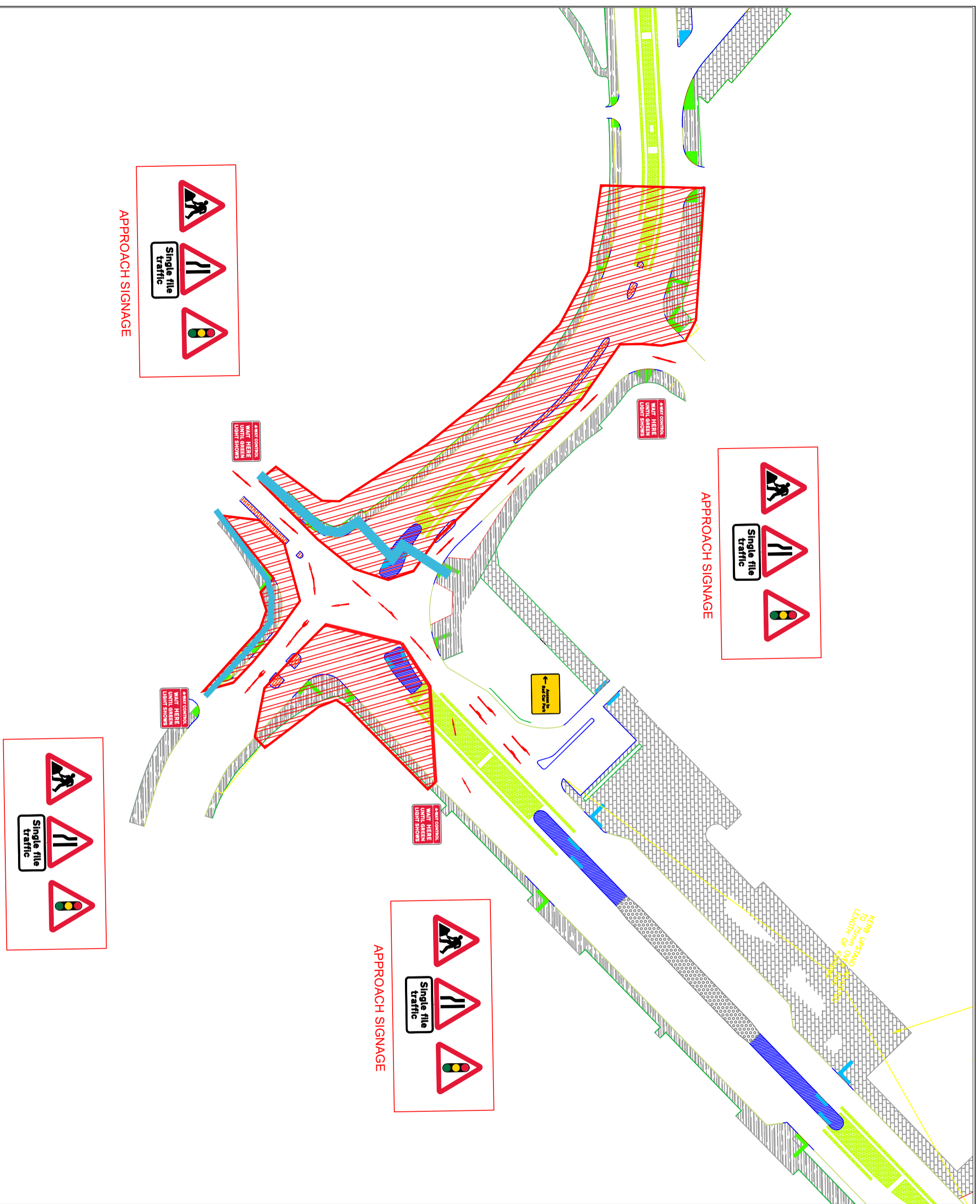

APPROACH SIGNAGE

Single file traffic

APPROACH SIGNAGE

Single file traffic

APPROACH SIGNAGE

Single file traffic

APPROACH SIGNAGE

Single file traffic