

W/C 27/03 - 29/03
(DAY/NIGHT)

ROAD
CLOSED

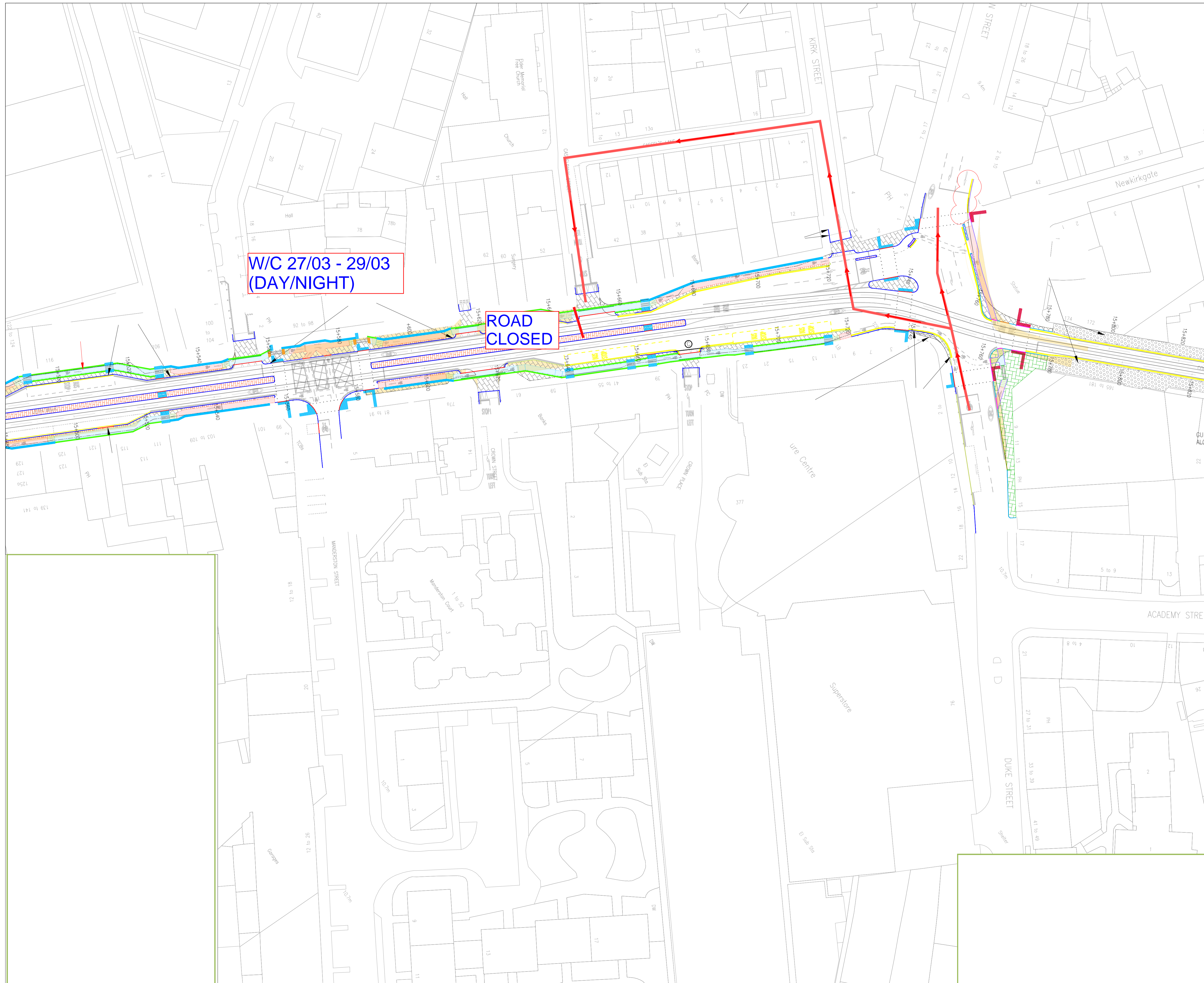

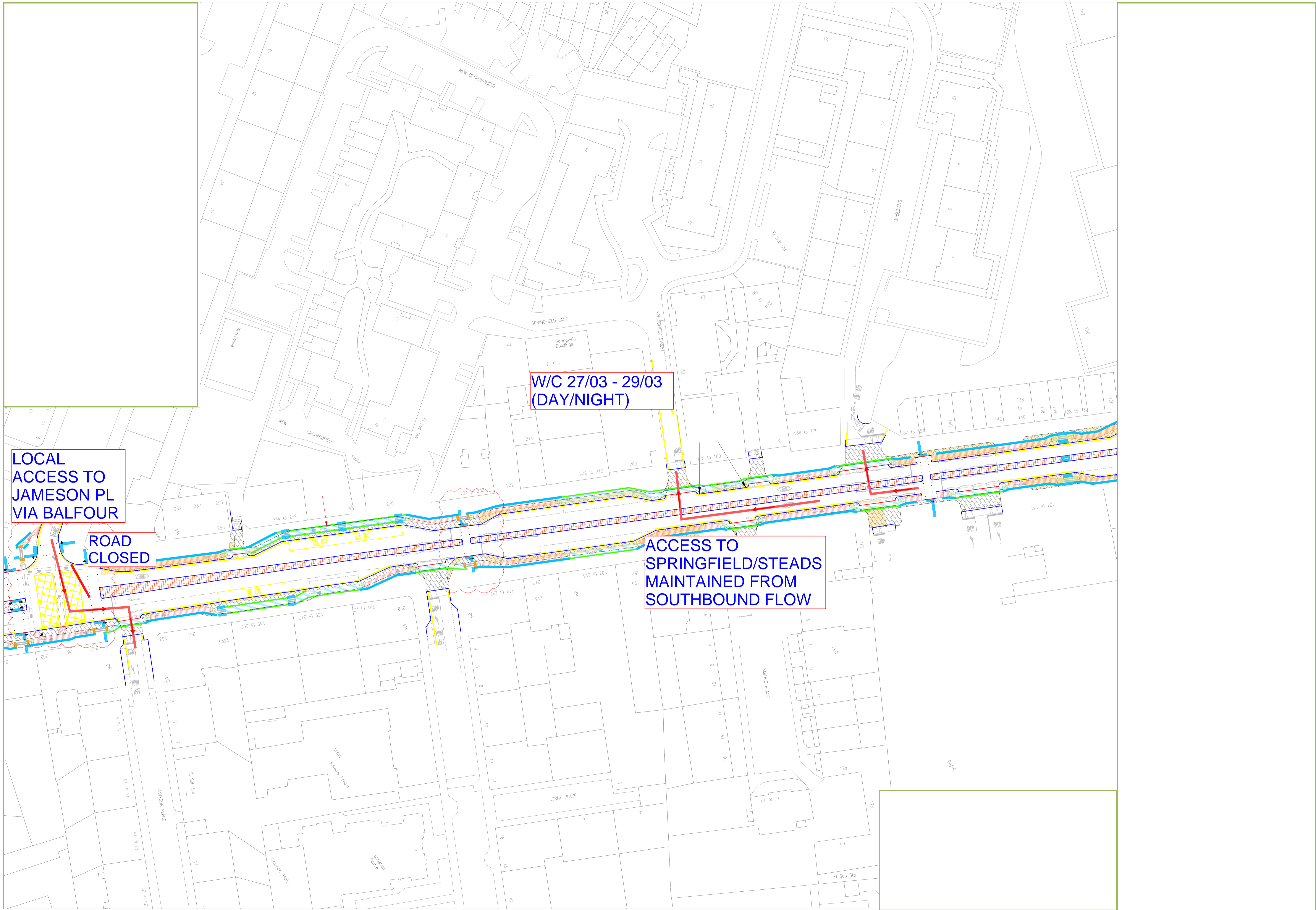

W/C 27/03 - 29/03
(DAY/NIGHT)

LOCAL
ACCESS TO
JAMESON PL
VIA BALFOUR

ROAD
CLOSED

ACCESS TO
SPRINGFIELD/STEADS
MAINTAINED FROM
SOUTHBOUND FLOW

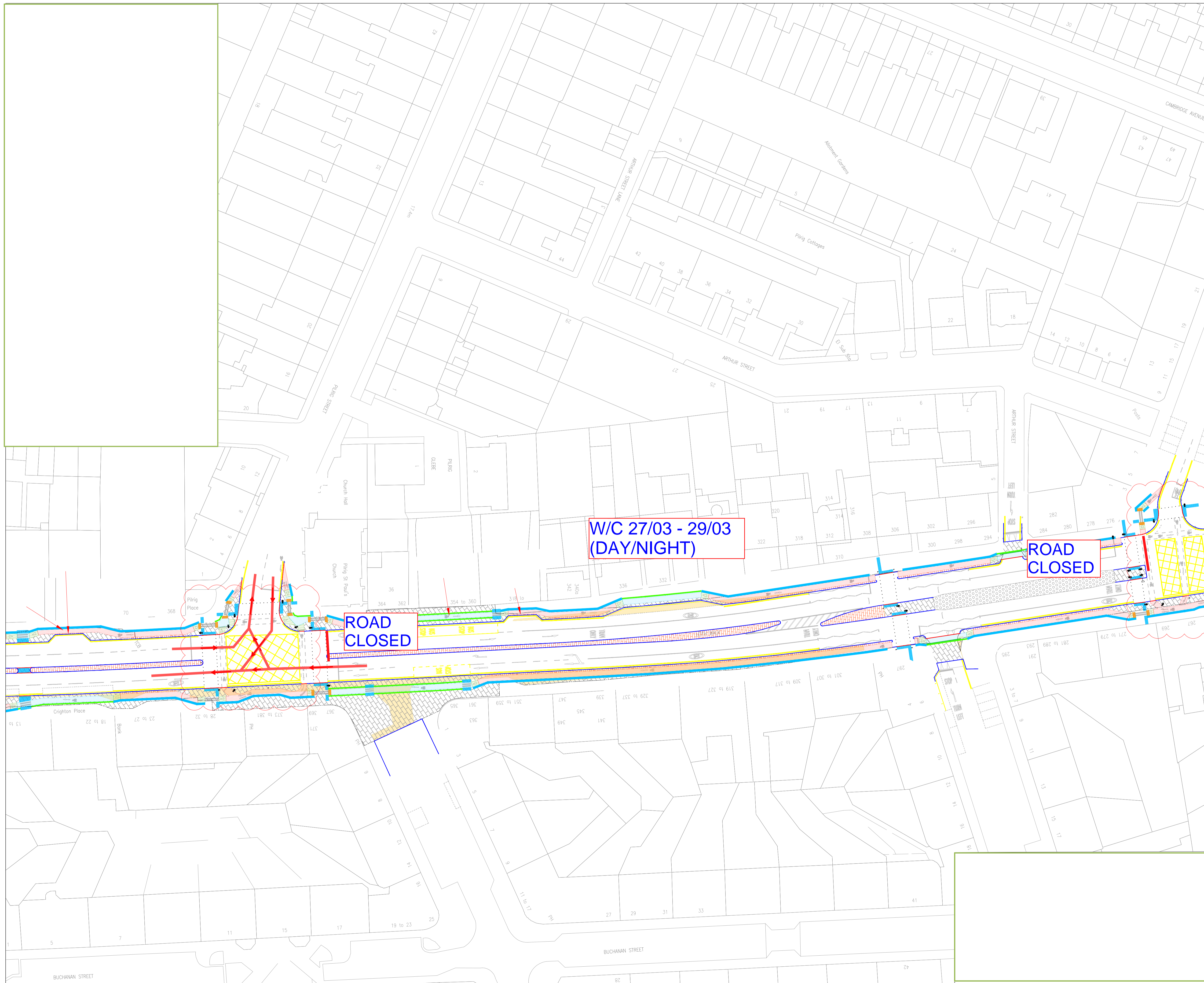

W/C 27/03 - 29/03
(DAY/NIGHT)

ROAD
CLOSED

ROAD
CLOSED

